

21601300020

I, Douglas J. Malliet, do hereby certify that on the 22nd day of July, 1997, I found ~~evidence~~ (no evidence) of the South Quarter corner of Section 30, T 16 N, R 1 W Fourth Principal Meridian, and I re-established said corner according to the Wisconsin Statutes as shown and described hereon.

Dated this 6th day of April, 1998

Douglas J. Malliet
 Douglas J. Malliet
 Registered Land Surveyor s-1266
 Title

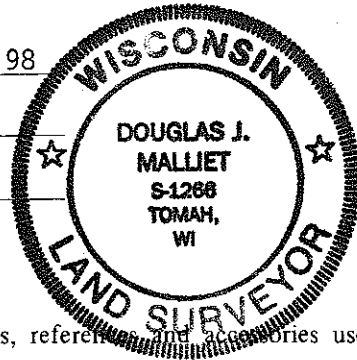

History of corner establishment since Original Government Survey

I believe W. Kenyon visited and monumented this corner on 20 June 1895. He set a post and established two bearing trees.

Description of corner evidence found:

I found an existing fence corner of occupation, with fence running East, South and West. Kenyon's bearing trees of record were gone. Accepted the existing fence corner as the best available evidence.

Description of corner and witness monuments, references and accessories used to perpetuate the original or re-established location of this corner:

Witnesses to corner location:

Douglas J. Malliet, R.L.S.

Bryan H. Meyer, R.L.S.

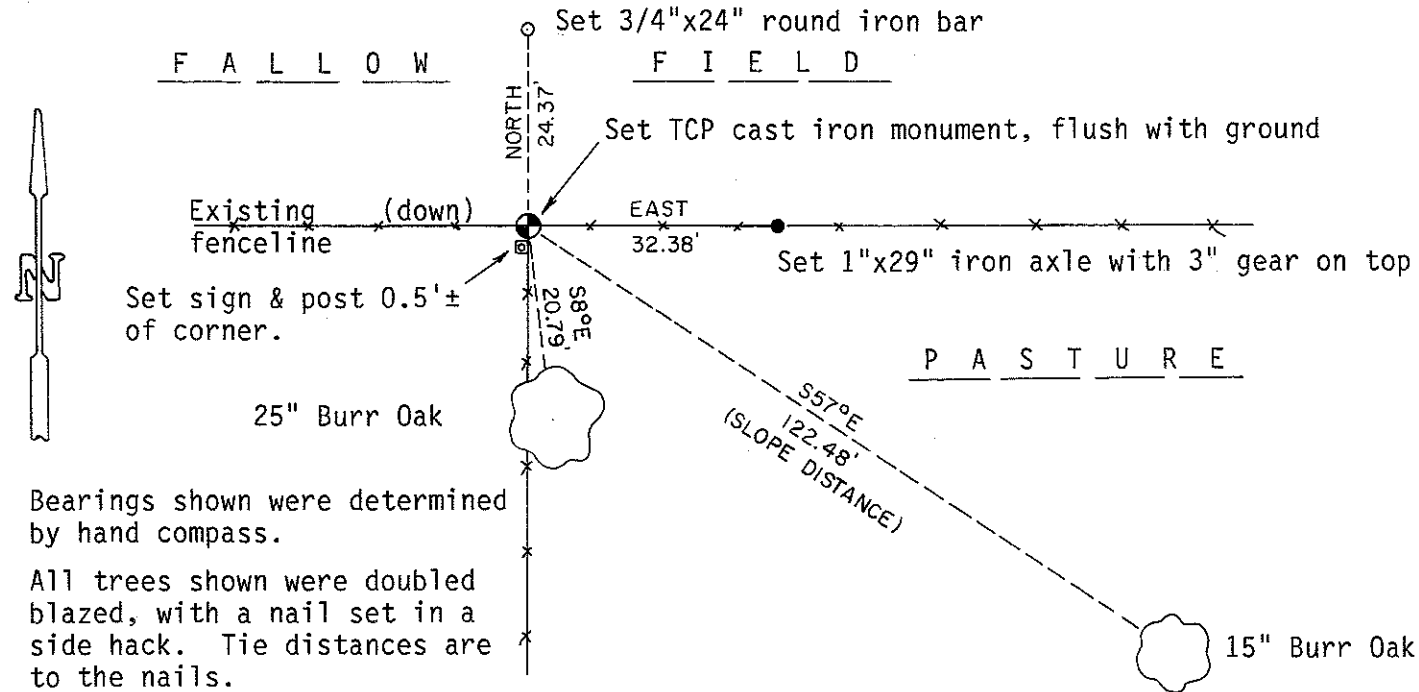

Bearings shown were determined by hand compass.

All trees shown were doubled blazed, with a nail set in a side hack. Tie distances are to the nails.

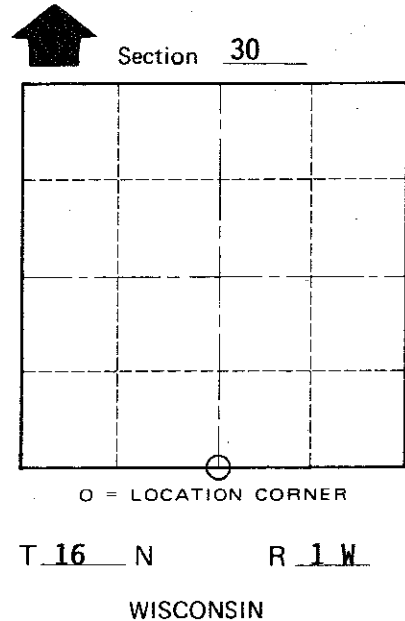

COUNTY SURVEYOR FORM NO. 1

SURVEY CONTROL ORDER

Horizontal	_____
Vertical	_____

Corner	East (X)	North (Y)	Elevation (Z)	Zone
Control Sta. Name				

City, Village or Town of WILTON

County of MONROE

4535