

21601292000

I, Garold A. Sime, do hereby certify that on the 3rd day of April 19 91, I found (evidence) ~~(evidence)~~ of the E 1/4 corner of Section 29, T 16 N, R 1 W Fourth Principal Meridian, and I re-established said corner according to the Wisconsin Statutes as shown and described hereon.

Dated this 15th day of August 19 91.

Garold A. Sime

Monroe County Surveyor
Title

History of corner establishment since Original Government Survey

No history of corner location since the Original Government Survey.

Description of corner evidence found:

I accepted the existing fence corner as the best available evidence for the corner location.

COUNTY SURVEYOR FORM NO. 1

Description of corner and witness monuments, references and accessories used to perpetuate the original or re-established location of this corner:
 Set cast iron Harrison Monument at corner.
 Set Guard sign next to corner.

Witnesses to corner location:

Garold A. Sime, R. L. S.

John Kenworthy

Brian Forsythe

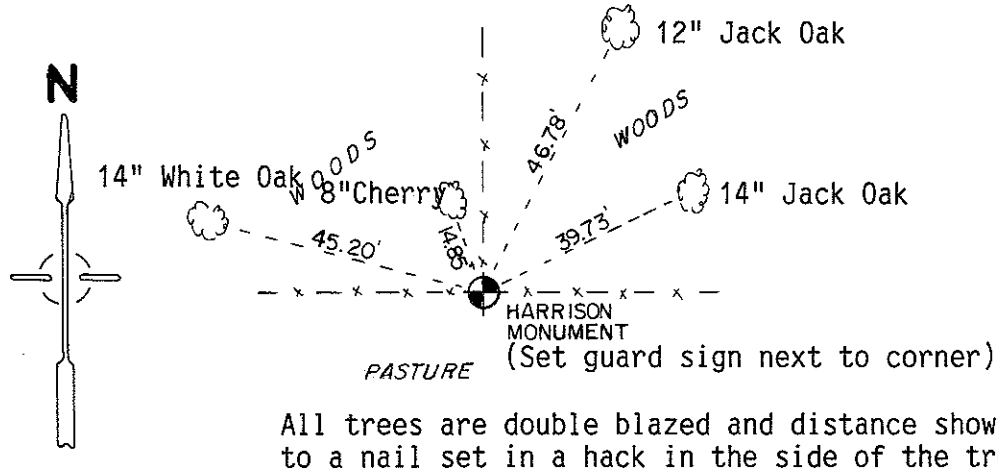
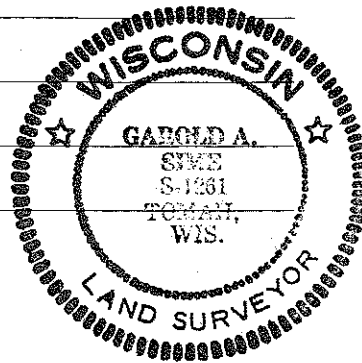

All trees are double blazed and distance shown is to a nail set in a hack in the side of the tree.

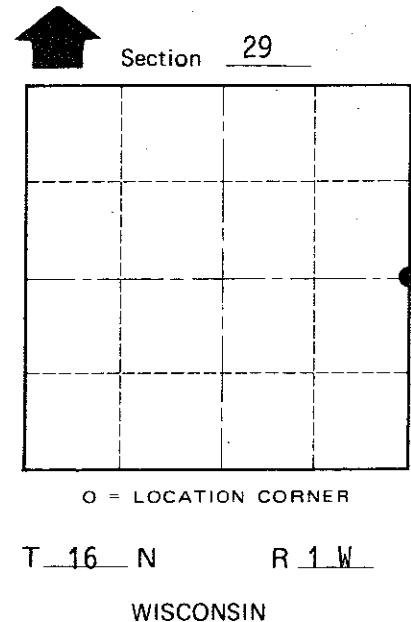

SURVEY CONTROL ORDER

Horizontal	_____
Vertical	_____

WISCONSIN COORDINATE SYSTEM

Corner	East (X)	North (Y)	Elevation (Z)	Zone
Control Sta. Name				

City, Village or Town of Wilton
 County of Monroe