

X21601280020

I, RONALD D. PARISH, do hereby certify that on the 20th day of JANUARY 1983, I found ~~(evidence)~~ (no evidence) of the N 1/4 corner of SECTION 33, T 16 N, R 1 W Fourth Principal Meridian, and I re-established said corner according to the Wisconsin Statutes as shown and described hereon.

Dated this 11th day of FEB. 1983.

Ronald D. Parish, R.L.S.

Title _____

History of corner establishment since Original Government Survey
NO RECORDED HISTORY SINCE ORIGINAL SURVEY

Description of corner evidence found:

**SET CORNER ON LINE EQUI DISTANCE FROM
 NW COR. SEC. 33 & NE COR. SEC. 33**

Description of corner and witness monuments, references and accessories used to perpetuate the original or re-established location of this corner:

Witnesses to corner location:

RONALD D. PARISH

DAN DOWNING

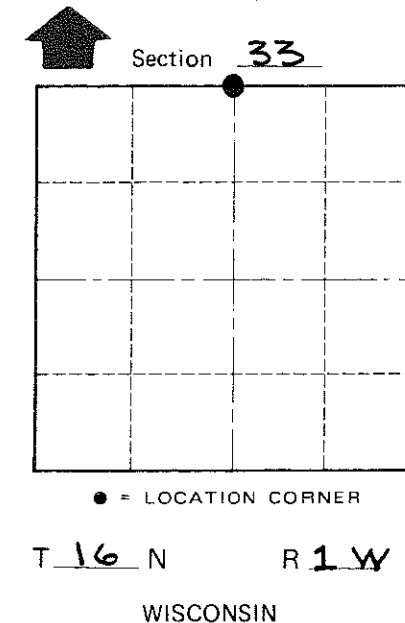
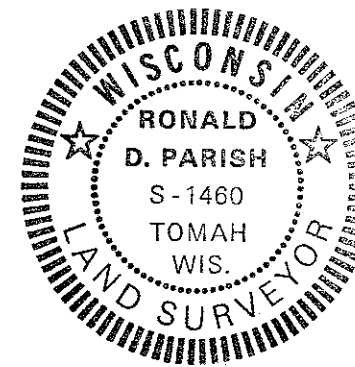
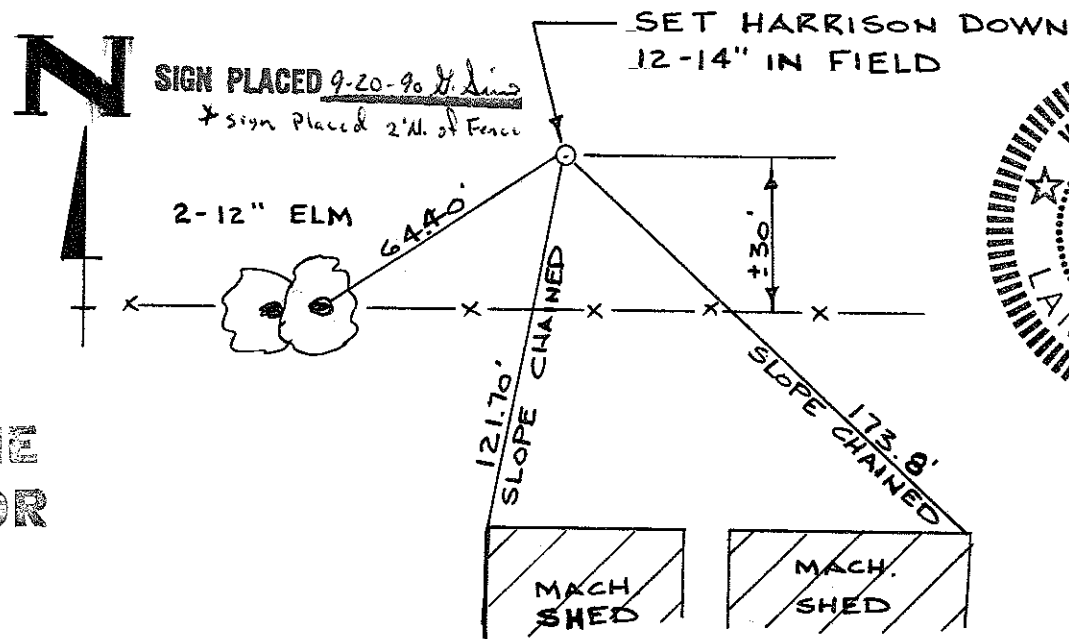

COUNTY SURVEYOR FORM NO. 1

Approved: **HARLEY A. SIME**
MONROE CO. SURVEYOR

SURVEY CONTROL ORDER

Horizontal	_____
Vertical	_____

WISCONSIN COORDINATE SYSTEM

Corner	East (X)	North (Y)	Elevation (Z)	Zone
Control Sta. Name				

City, Village or Town WILTON
 County of MONROE