

CERTIFICATE

CERTIFIED LAND CORNER

No. 107

2160128000

I, Harley A. Sime, do hereby certify that on the 26th day of September 1980, I found ~~(no evidence)~~ (no evidence) of the Northwest corner of Section 34, T16 N, R 1 W Fourth Principal Meridian, and I re-established said corner according to the Wisconsin Statutes as shown and described hereon.

History of corner establishment since Original Government Survey  
No known recorded history since the original government survey.

Dated this 26th day of Sept. 1980.

Description of corner evidence found:

Projected line west between N¼ & NE corners and intersected it with N-S fence line of west line of section to establish NW corner. Set Harrison Monument.

**Approved: HARLEY A. SIME**  
**MONROE CO. SURVEYOR**  
Title

COUNTY SURVEYOR FORM NO. 1

Description of corner and witness monuments, references and accessories used to perpetuate the original or re-established location of this corner:

Witnesses to corner location:

- G. Dechant
- B. Meyer
- C. Dade

Note: Both trees are double blazed with nails and caps set in the lower blaze.

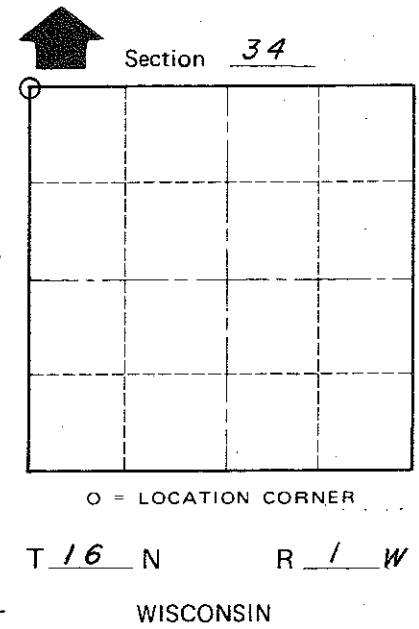
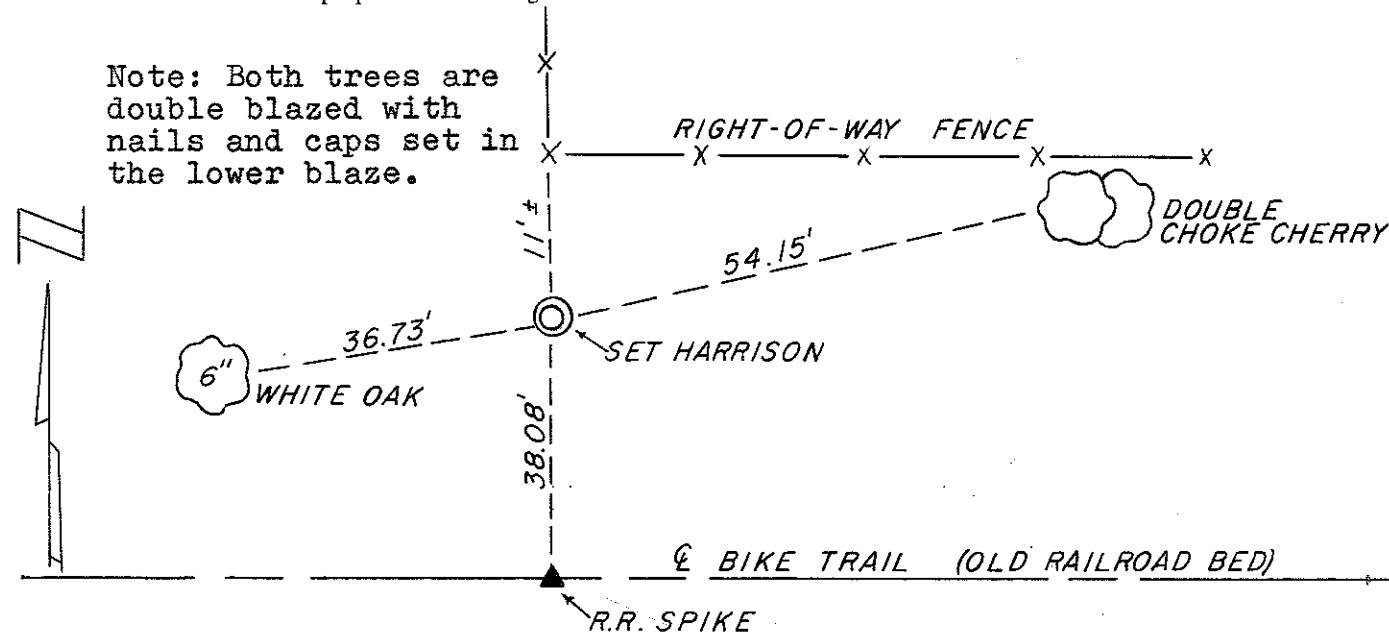

SURVEY CONTROL ORDER

Horizontal	
Vertical	

WISCONSIN COORDINATE SYSTEM

Corner	East (X)	North (Y)	Elevation (Z)	Zone
Control Sta. Name				

City, Village or Town of Wilton  
County of Monroe  
Wisconsin