

CERTIFICATE

CERTIFIED LAND CORNER

No. 98

21601272000

I, Garold A. Sime, do hereby certify that on the 5th day of August 1986, I found (evidence) (~~no evidence~~) of the E¹/₄ corner of Section 27, T 16 N, R 1W Fourth Principal Meridian, and I re-established said corner according to the Wisconsin Statutes as shown and described hereon.

Dated this 29th day of Dec 1986.

Garold A. Sime

Deputy County Surveyor
Title

History of corner establishment since Original Government Survey

*See previous land corner record

Description of corner evidence found:

I set this corner at a previously computed location. This fit the D.O.T. ties fairly well. The monuments had been disturbed.

COUNTY SURVEYOR FORM NO. 1

Description of corner and witness monuments, references and accessories used to perpetuate the original or re-established location of this corner:

Set Harrison Monument at corner

Witnesses to corner location:

Garold A. Sime, R.L.S.

Dallas Wilhite

Joel Tralmer

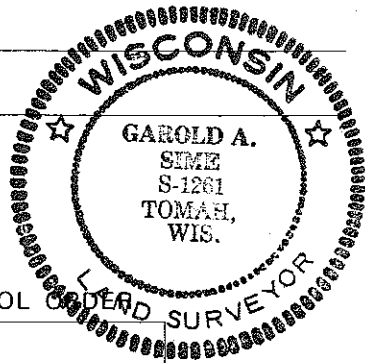

SURVEY CONTROL

Horizontal	
Vertical	

EX. D.O.T. BERNSTEN MONU. (Top bent to north)

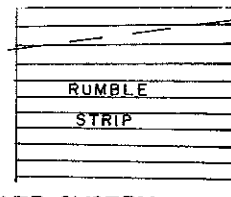

S.T.H. HWY 131

121.68' (REC. AS 121.32')

24.50'

50.34'

SET 3/4" x 24" I.B.

EX. D.O.T. BERNSTEN MONU.

75.38' (REC. AS 75.70')

SET HARRISON MONUMENT

SET 3/4" x 24" I.B.

SIGN PLACED 11'± E. OF HARRISON

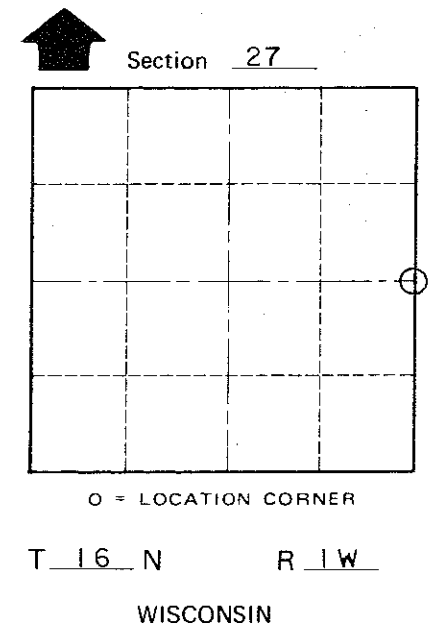

WISCONSIN COORDINATE SYSTEM

Corner	East (X)	North (Y)	Elevation (Z)	Zone
Control Sta. Name				

~~City or Village~~ or Town Wilton

County of Monroe

COUNTY MONROE		
TOWN WILTON		
HIGHWAY S.T.H. 131		
SECTION 26	TOWNSHIP 16 N	RANGE 1 W
TYPE OF LANDMARK 3/4" IRON BAR. SET BY MONROE CO. SURVEYOR 1977		

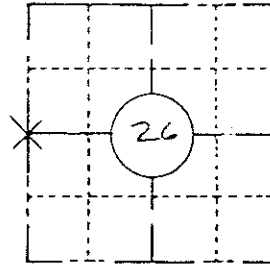

LOCATION SKETCH
 (Location of landmark indicated by "x")

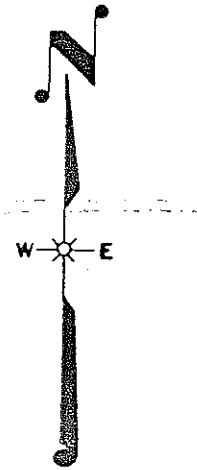

This space for copy of field notes or ties to the above described landmarks

○ = 3/4" IRON BAR
 △ = WIS. D.O.T. BERNSTEIN MONU.
 SET ALONG NEW S.T.H. 131 R/W

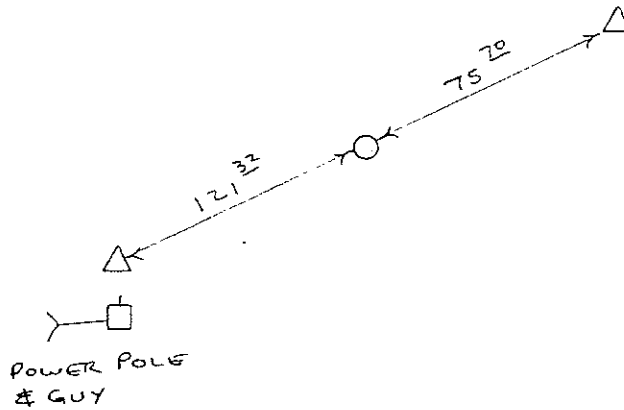

CREW CHIEF M. WEGE.

FILED UNDER PROJECT NUMBER 5130-05-72		COUNTY CLERK'S OFFICE COUNTY OF WISCONSIN } SS	
SHC DISTRICT OFFICE NUMBER #5	CITY LACROSSE	COUNTY LACROSSE	DATE RECEIVED FOR RECORD
LOCATED OR ESTABLISHED BY PERPETUATED NAME <u>DERALD E. KADING</u>		DATE COPY SENT TO COUNTY SURVEYOR	
TITLE <u>SURVEY COORDINATOR</u> DATE <u>5-14-84</u>		SIGNATURE OF COUNTY CLERK	

CERTIFICATE

CERTIFIED LAND CORNER

William C. Jung, do hereby certify that on the 28th day of October 1977, I found ~~evidence~~ (no evidence) of the West 1/4 corner of Section 26, T 16 N, R 1 W, Fourth Principal Meridian, and I re-established said corner according to the Wisconsin statutes as shown and described hereon.

History of original corner establishment:

No recorded history since the original government survey.

Dated this 3rd day of Nov. 1977.

Description of corner evidence found:

Measured the distance from the Center 1/4 of Section 26 to the N.W. corner of the NE1/4-SW1/4. Projected this line West from the aforesaid 1/8 corner at a distance equal to the aforesaid measured distance and set the corner. This creates a bend at the West 1/4 of Section 26, but it fits the evidence found along the East-West 1/4 line, and also fairly well an old line fence to the South of the intersection of S.T.H. "71" and "131".

William C. Jung, R.L.S. 1323

Crew Chief, County Surveyor's
Title Office

Description of corner and witness monuments, references and accessories used to perpetuate the original or re-established location of this corner:

Set a 3/4"x24" iron bar in the road, down 1", and 7.5 ft. East of the "131" centerline. (Very hard pounding.)

Witnesses to corner location:

W. C. Jung

G. Dechant

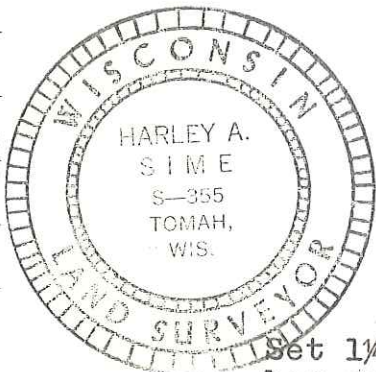
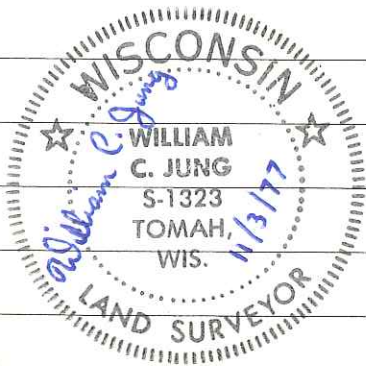

Approved: Harley Sime
County Surveyor

SURVEY CONTROL ORDER

Horizontal	_____
Vertical	<u>Scaled Elev.</u>

WISCONSIN COORDINATE SYSTEM

Corner	East (X)	North (Y)	Elevation (Z)	Zone
	<u>1875000.402</u>	<u>669104.350</u>	<u>1070 +</u>	<u>SOUTH</u>
Control Sta. Name				

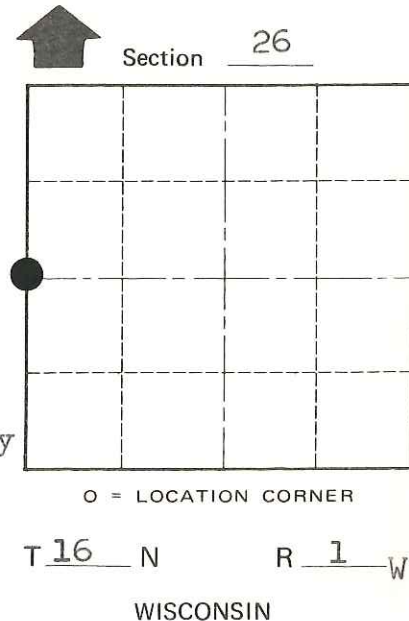
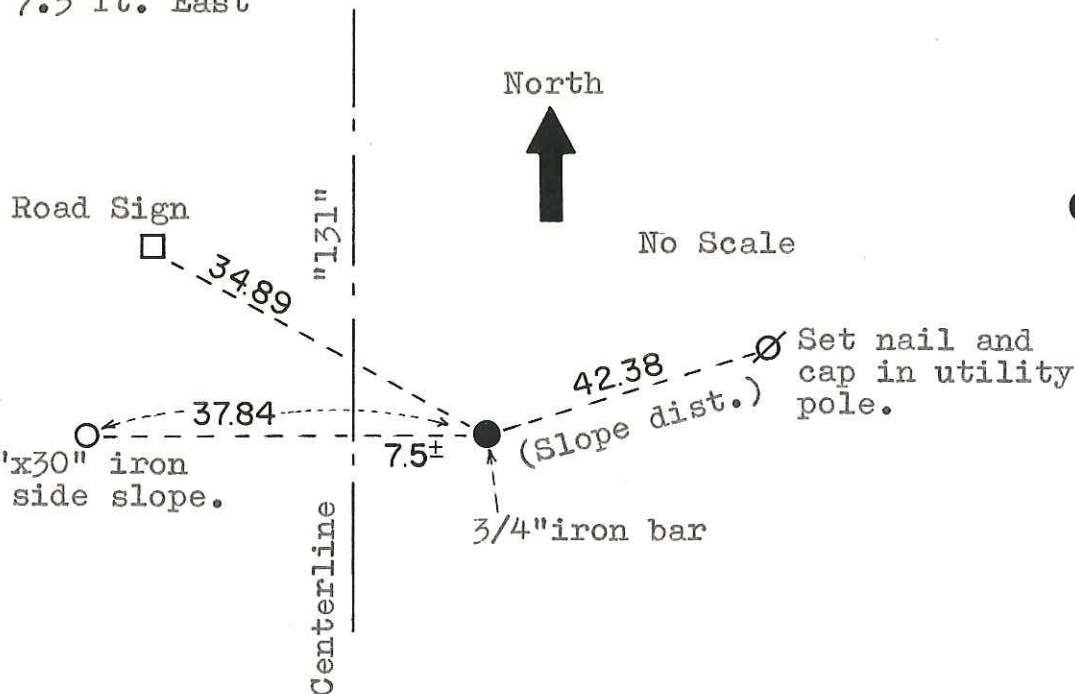

City, Village or Town Wilton
County of Monroe