

21601220020

I, Garold A. Sime, do hereby certify that on the 13<sup>th</sup> day of June 1986, I found (evidence) ~~(no evidence)~~ of the S<sup>1</sup>/<sub>4</sub> corner of Sec. 22, T16 N, R1W Fourth Principal Meridian, and I re-established said corner according to the Wisconsin Statutes as shown and described hereon.

Dated this 13<sup>th</sup> day of June 1986.

Garold A. Sime

Deputy County Surveyor  
Title

History of corner establishment since Original Government Survey

No recorded history since the Original Government Survey

Description of corner evidence found:

Found Original Bearing Tree Stump and monumented S<sup>1</sup>/<sub>4</sub> corner from same

Description of corner and witness monuments, references and accessories used to perpetuate the original or re-established location of this corner:

Set Harrison Monument at corner

Witnesses to corner location:

G. Sime

D. WILHITE

J. TRALMER

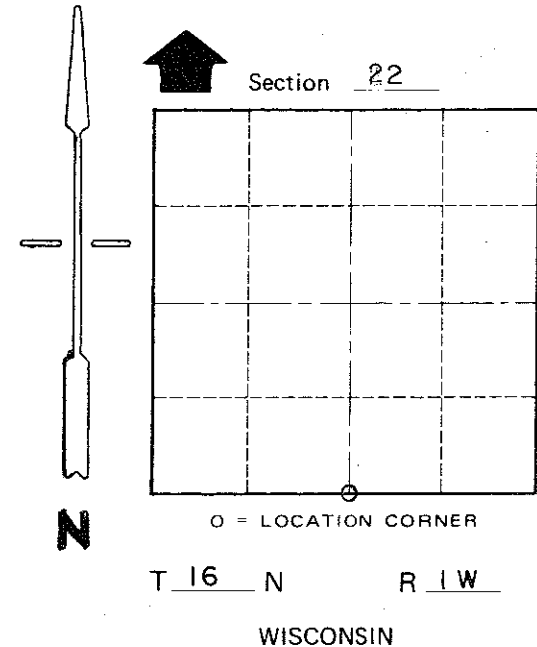
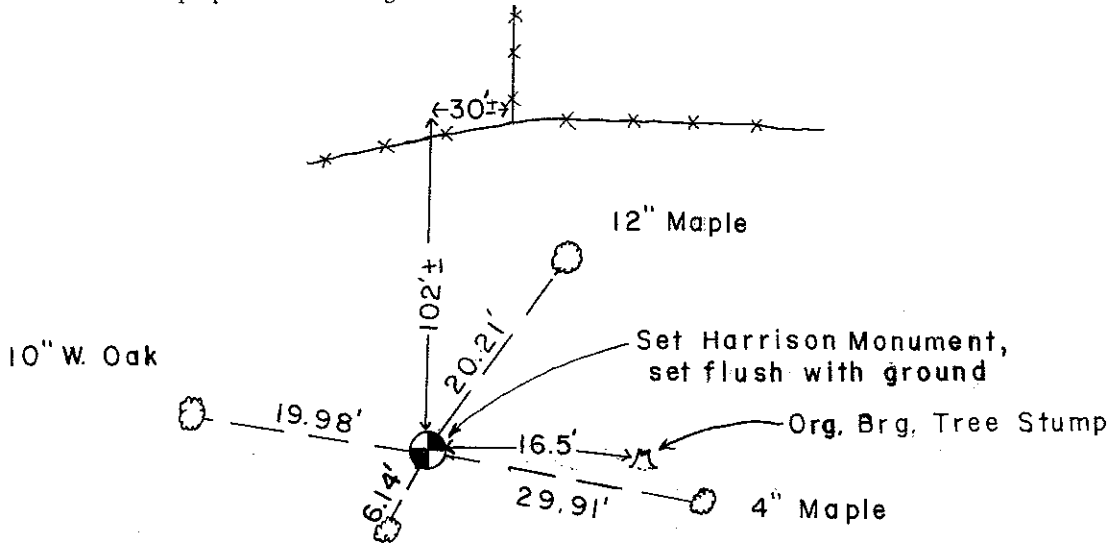
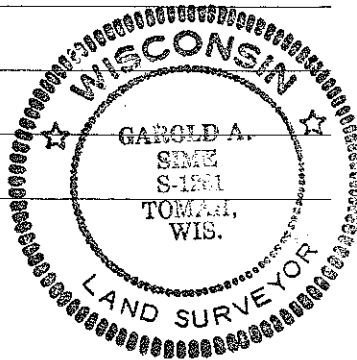

Trees Double Blazed and distances are to nail set in hack in side of tree.

SURVEY CONTROL ORDER

Horizontal	_____
Vertical	_____

WISCONSIN COORDINATE SYSTEM

Corner	East (X)	North (Y)	Elevation (Z)	Zone
Control Sta. Name				

City, Village or Town Wilton

County of Monroe

COUNTY SURVEYOR FORM NO. 1