

CERTIFICATE

CERTIFIED LAND CORNER

No. 44

Page 2

21601110020

I, Gary L. Dechant, do hereby certify that on the 30th day of Dec. 1993, I found (evidence) ~~(no evidence)~~ of the N¹/₄ corner of Sec. 14, T 16 N, R 1 W Fourth Principal Meridian, and I re-established said corner according to the Wisconsin Statutes as shown and described hereon.

Dated this 30th day of Dec. 1993.

Gary L. Dechant
Registered Land Surveyor, 1744
Title

History of corner establishment since Original Government Survey

O. R. Dahl was at this corner in 1869.
 W. C. Jung set this corner October 25, 1977 with a 2 1/2" iron pipe.

Description of corner evidence found:

I assisted W. C. Jung in setting this corner in Nov. of 1977 and distinctly remember leaving a large pipe up several feet and placing a very huge rock pile around the pipe. The pipe is now gone and the rock piles are more numerous and much smaller than I remember. After, talking to Aaron Borntreger, landowner of this area, stated he remembers seeing a large iron pipe in a very large stone pile early this spring. He also stated that his neighbor and himself were clearing trees and brush along this line which would explain the lone bearing tree no longer existing, but he says he does not know what happened to the pipe.

We reset the corner at the same distances from the S¹/₄ and NW corners of Section 14 as shown on W. C. Jung's section summary dated Oct. 1977. This fits the new east-west fence and between section corners very well.

Description of corner and witness monuments, references and accessories used to perpetuate the original or re-established location of this corner:

Witnesses to corner location:

David E. Madison

Gary L. Dechant

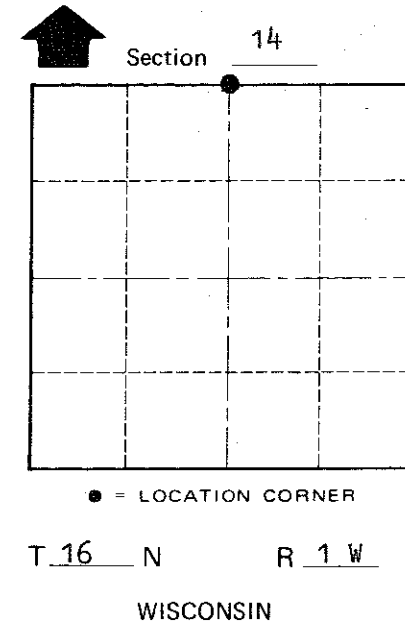
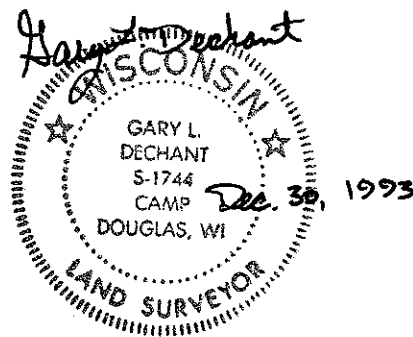
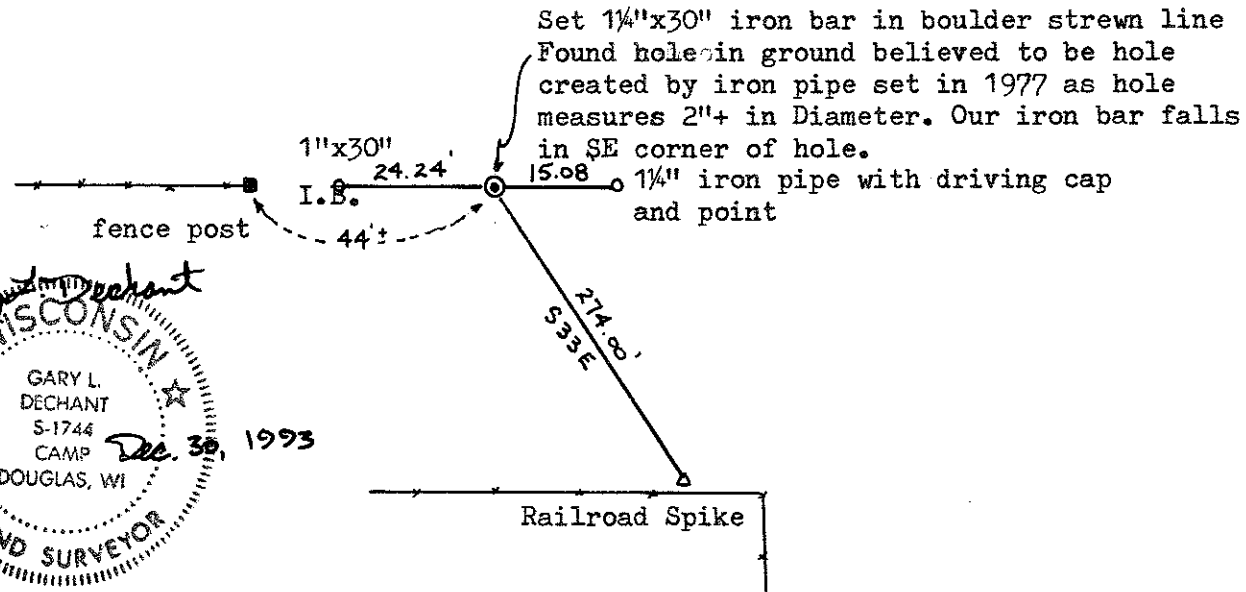

SURVEY CONTROL ORDER

Horizontal	_____
Vertical	_____

WISCONSIN COORDINATE SYSTEM

Corner	East (X)	North (Y)	Elevation (Z)	Zone
Control Sta. Name				

~~City, Village or~~ Town Wilton
 County of Monroe

COUNTY SURVEYOR FORM NO. 1

CERTIFICATE

CERTIFIED LAND CORNER

No. 44
See Pg. 2

I, William C. Jung, do hereby certify that on the 25th day of October 1977, I found (evidence) (~~no evidence~~) of the N 1/4 corner of Section 14, T 16 N, R 1 W, Fourth Principal Meridian, and I re-established said corner according to the Wisconsin Statutes as shown and described hereon.

History of original corner establishment:

O. R. Dahl was at this corner in 1869.

Description of corner evidence found:

Intersected the existing occupied line along the North line of the NW 1/4 of Section 14 with the existing occupied line along the N-S 1/4 line of Section 14. This location fits the existing evidence very well.

Dated this 11th day of Nov. 1977.

William C. Jung, R.L.S. 1323

County Surveyor's Office
Title

Description of corner and witness monuments, references and accessories used to perpetuate the original or re-established location of this corner:

Set a 2 1/2" x 7' iron pipe.

Witnesses to corner location:

W. C. Jung
G. Dechant

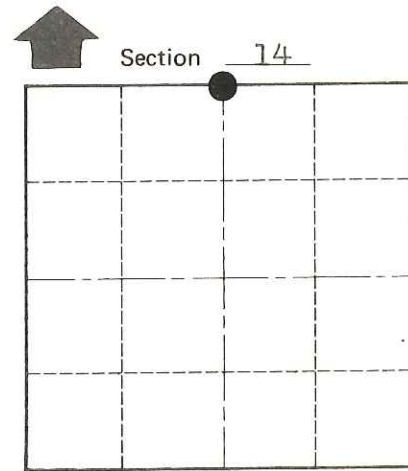
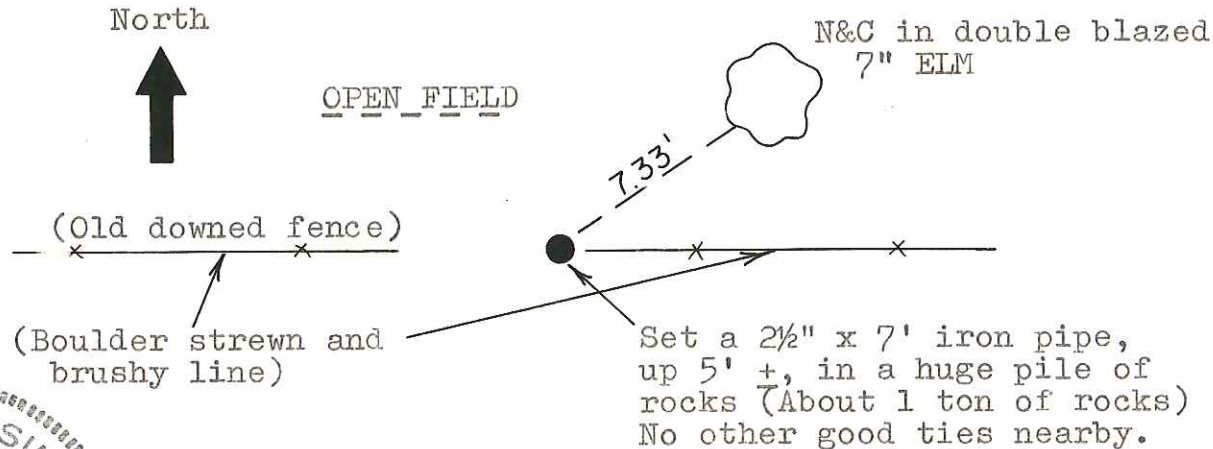
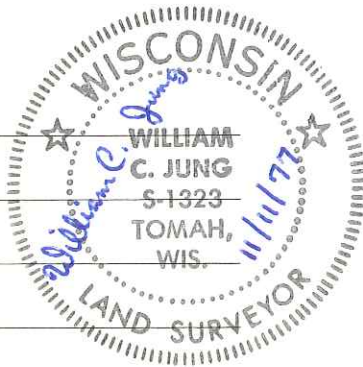

O = LOCATION CORNER

T 16 N R 1 W
WISCONSIN

Approved: Harley Sime
County Surveyor

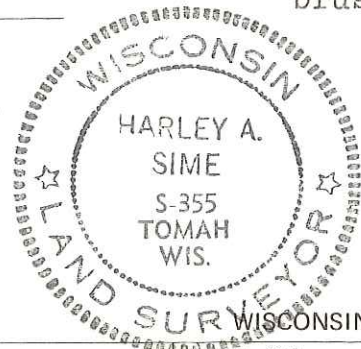

SURVEY CONTROL ORDER

Horizontal _____
Vertical Scaled Elev.

WISCONSIN COORDINATE SYSTEM				
Corner	East (X)	North (Y)	Elevation (Z)	Zone
	<u>1877705.552</u>	<u>682295.677</u>	<u>1330 +</u>	<u>SOUTH</u>
Control Sta. Name				

City, Village or Town Wilton
County of Monroe

COUNTY SURVEYOR FORM NO. 1