

CERTIFICATE

CERTIFIED LAND CORNER

No. 46

21601100020

I, Bryan H. Meyer, do hereby certify that on the 2nd day of July 19 86, I found (evidence) ~~no evidence~~ of the South 1/4 corner of Section 10, T 16 N, R 1 W Fourth Principal Meridian, and I re-established said corner according to the Wisconsin Statutes as shown and described hereon.

Dated this 15th day of Dec. 19 86.

Bryan H. Meyer

Deputy County Surveyor  
Title

History of corner establishment since Original Government Survey

James J. Carroll was here in May of 1976 and set an 8" spike at the fence corner.

Description of corner evidence found:

I found Mr. Carroll's spike at a three-way fence corner and accepted it as the corner.



COUNTY SURVEYOR FORM NO. 1

Description of corner and witness monuments, references and accessories used to perpetuate the original or re-established location of this corner:

Crew: Meyer, Wilhite, Tralmer

Date: July 2, 1986

Weather: Partly Cloudy, Breezy, 75°±.

Witnesses to corner location:

Bryan H. Meyer

Dallas Wilhite

Joel Tralmer

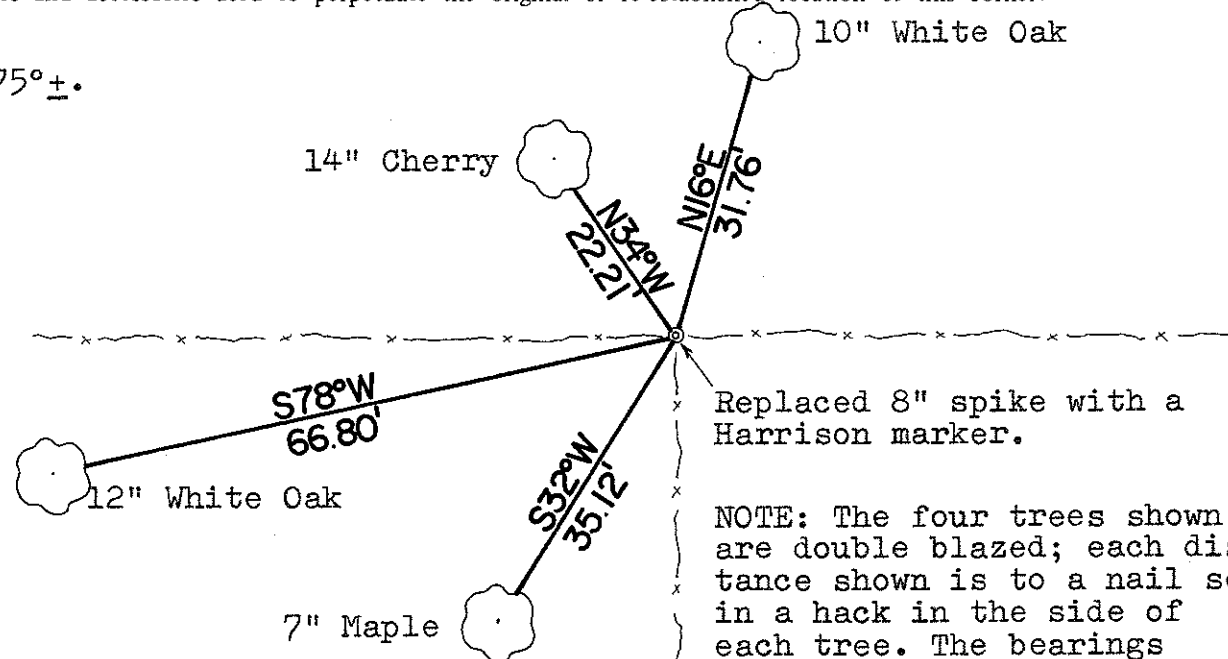

Replaced 8" spike with a Harrison marker.

NOTE: The four trees shown are double blazed; each distance shown is to a nail set in a hack in the side of each tree. The bearings shown are magnetic hand compass bearings. The fences shown are in poor condition!

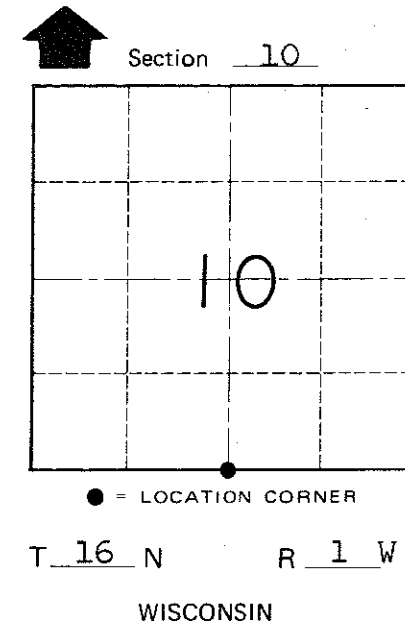

SURVEY CONTROL ORDER

Horizontal \_\_\_\_\_  
Vertical \_\_\_\_\_

WISCONSIN COORDINATE SYSTEM

Corner	East (X)	North (Y)	Elevation (Z)	Zone
Control Sta. Name				

~~City, Village or Town~~ of Wilton

County of Monroe