

CERTIFICATE

CERTIFIED LAND CORNER

No. 24

21601020020

I, Bryan H. Meyer, do hereby certify that on the 1st day of August 1986, I found (evidence) ~~no evidence~~ of the North 1/4 corner of Section 11, T16 N, R1 W Fourth Principal Meridian, and I re-established said corner according to the Wisconsin Statutes as shown and described hereon.

History of corner establishment since Original Government Survey

Nothing recored.

Description of corner evidence found:

I accepted the three-way fence corner as the best available evidence.

Dated this 15th day of Dec. 1986.

Bryan H. Meyer  
Deputy County Surveyor  
Title



COUNTY SURVEYOR FORM NO. 1

Description of corner and witness monuments, references and accessories used to perpetuate the original or re-established location of this corner:

Crew: Wilhite, Tralmer  
Date: August 1, 1986

Witnesses to corner location:

Joel Tralmer  
Dallas Wilhite  
Bryan Meyer

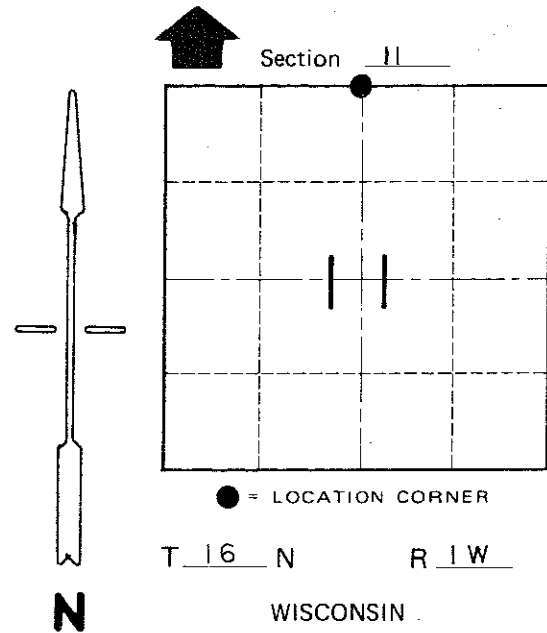
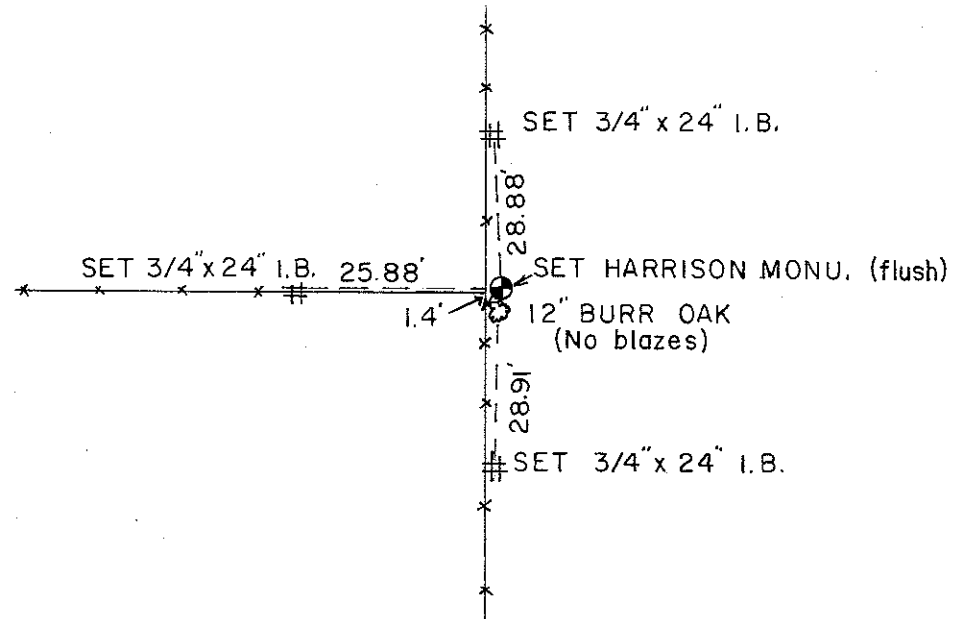

SURVEY CONTROL ORDER

Horizontal	_____
Vertical	_____

WISCONSIN COORDINATE SYSTEM

Corner	East (X)	North (Y)	Elevation (Z)	Zone
Control Sta. Name				

~~City/Village of~~ Town of Wilton

County of Monroe