

**U.S. PUBLIC LAND CORNER
MAINTENANCE**

98
Corner ID: W1/4 Sec. 26, T16N-R1E
41601272000

<u>DATE</u>	<u>CREW</u>	<u>MONUMENT TYPE</u>
October 4, 2019	Zachariah P. Dechant Gary L. Dechant	Harrison, top broke off, down 16", 5' east of fence

References:

- 1) Set 3/4"x24" round iron bar, down 4", 4' SW of 6" Walnut
- 2) Set 3/4"x24" round iron bar, down 4", 4' SW of 14" Red Pine
- 3) Set 3/4"x24" round iron bar, down 4", 4' NW of 8" White Pine
- 4) Set 3/4"x24" round iron bar, down 4" 4' east of 12" White Pine

<u>Bearing</u>	<u>Distance</u>
N21E	17.37'
N66E	70.59'
S32E	59.30'
N89W	47.07'



I, Harley A. Sime, do hereby certify that on the 2 day of June 1976, I found (evidence) (~~no evidence~~) of the W 1/4 corner of Section 26, T 16 N, R 1 E, Fourth Principal Meridian, and I re-established said corner according to the Wisconsin Statutes as shown and described hereon.

History of original corner establishment:

Approved: HARLEY A. SIME
MONROE CO. SURVEYOR

See Reverse Side
For Maintenance

Description of corner evidence found:

Set the corner on a bearing projected through the E 1/4 and C 1/4 corners (this bearing also fits the forty corner West of the C 1/4 corner), and at a distance from the C 1/4 corner, double that from the C 1/4 corner West to the forty corner. After setting the corner thusly, we found a file buried in the fence 5' West of the corner. Looked as if someone might have placed there for a reason, although there is nothing on record for this corner. Did not accept the fence as aerial photos show this N-S fence to meander all over.

Dated this 7 day of Sept. 1977.

County Surveyor

Title

Description of corner and witness monuments, references and accessories used to perpetuate the original or re-established location of this corner:

Witnesses to corner location:

W. Jung - Crew Chief

G. Dechant

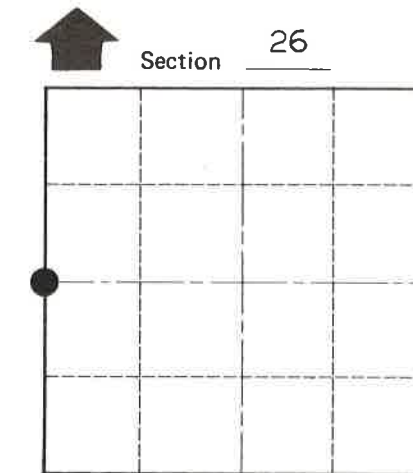
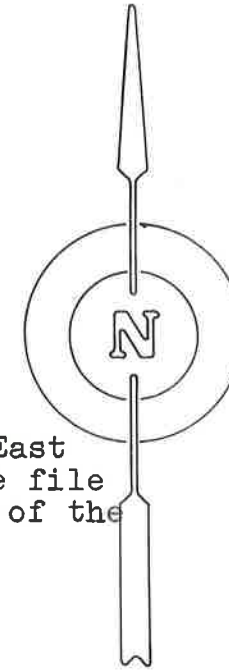
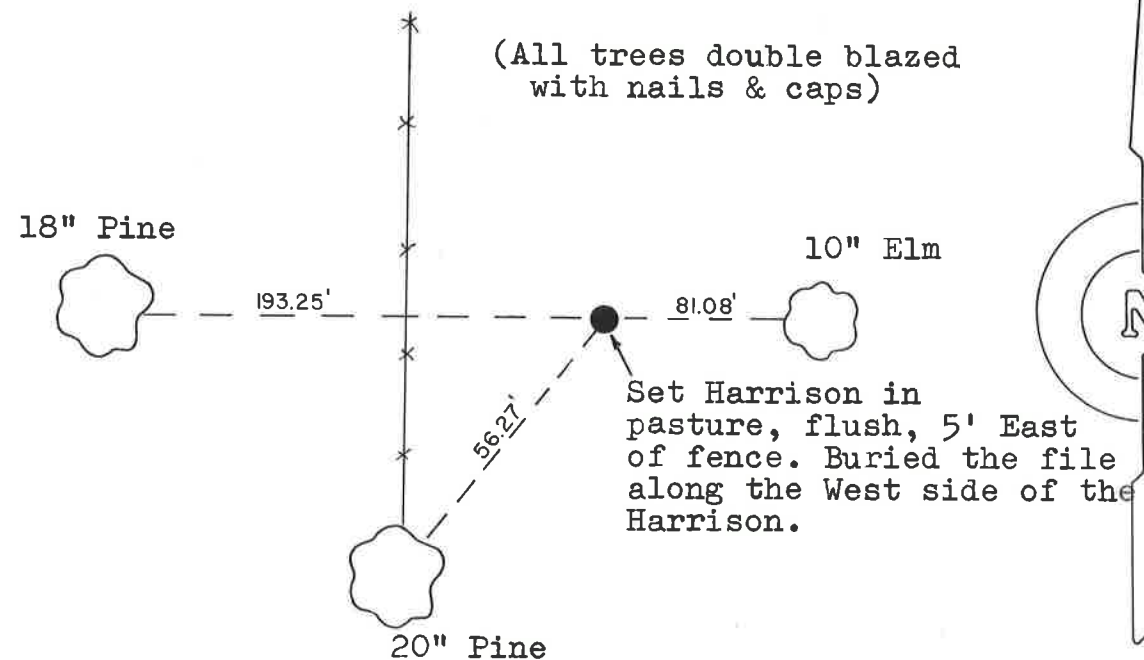
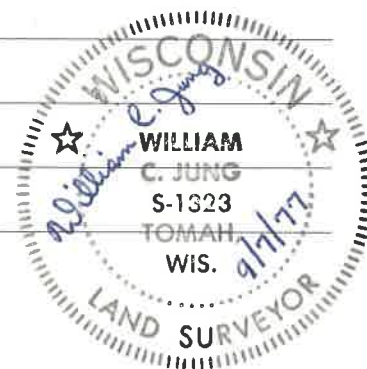

O = LOCATION CORNER
 T 16 N R 1 E
 WISCONSIN

SURVEY CONTROL ORDER

Horizontal	_____
Vertical	_____

WISCONSIN COORDINATE SYSTEM

Corner	East (X)	North (Y)	Elevation (Z)	Zone
Control Sta. Name				

City, Village or Town Clifton

County of Monroe

COUNTY SURVEYOR FORM NO. 1