

**U.S. PUBLIC LAND CORNER
MAINTENANCE**

106

Corner ID: N1/4 Sec. 34, T16N-R1E

41601270020

<u>DATE</u>	<u>CREW</u>	<u>MONUMENT TYPE</u>
October 4, 2019	Zachariah P. Dechant Gary L. Dechant	Harrison intact, 8' west of woven wire fence Set stones around Harrison, sign 1' north. Approx. 150' S30W of west side of rock outcrop

References:

	<u>Bearing</u>	<u>Distance</u>
1) Set 3/4"x24" round iron bar, down 4", 5' SW of 18" Dble White Oak w/burl at bottom	N69E	32.37'
2) Set 3/4"x24" round iron bar, down 4", 4' NW of 14" Maple	S76E	24.19'
3) Set 3/4"x24" round iron bar, 4' north of 3" Hickory north of pit	S80W	22.63'
4) Set 3/4"x24" round iron bar, down 4", SW side of stone	N33W	14.68'

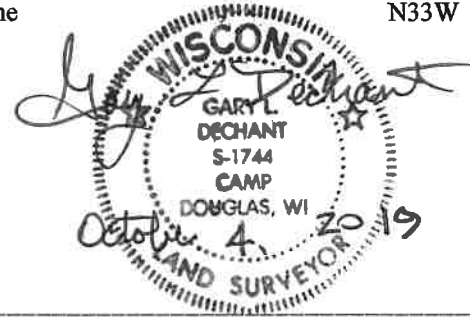

I, Harley A. Sime, do hereby certify that on the 30th day of July 1981, I found ~~(evidence)~~ (no evidence) of the N¹/₄ corner of Section 34, T 16 N, R 1 E Fourth Principal Meridian, and I re-established said corner according to the Wisconsin Statutes as shown and described hereon.

Dated this 5th day of August 1981.

Harley A. Sime, R.L.S. 355

County Surveyor
Title

History of corner establishment since Original Government Survey

No known recorded history since the original government survey.

Description of corner evidence found:

Set by single proportionate measurement. Could not accept the occupied fence corner as it is approximately 100 feet too far to the North.

See Reverse Side For Maintenance

Description of corner and witness monuments, references and accessories used to perpetuate the original or re-established location of this corner:

Witnesses to corner location:

G. Dechant

B. Meyer

C. Pietz

COUNTY SURVEYOR FORM NO. 1

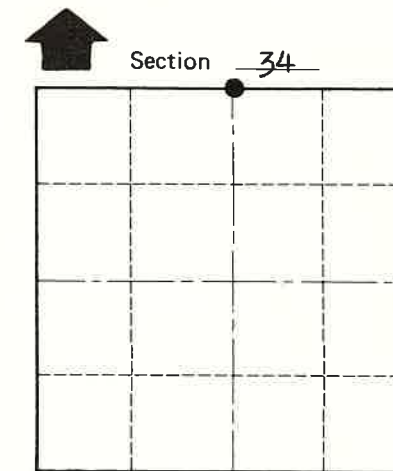
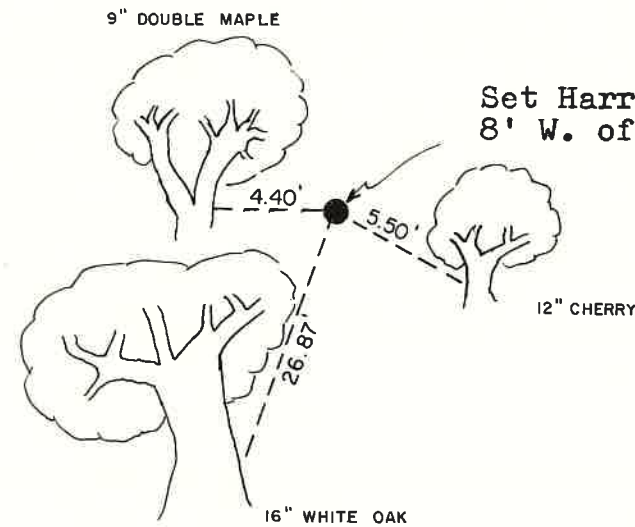

● = LOCATION CORNER

T 16 N R 1E

WISCONSIN

Approved: **HARLEY A. SIME**
MONROE CO. SURVEYOR

(All trees double blazed with nails set)

SURVEY CONTROL ORDER

Horizontal _____

Vertical _____

WISCONSIN COORDINATE SYSTEM

Corner	East (X)	North (Y)	Elevation (Z)	Zone
Control Sta. Name				

City, Village or Town Clifton

County of Monroe