

# 83

**U.S. PUBLIC LAND CORNER  
MAINTENANCE**

**Corner ID : NE Sec.26, T16N-R1E  
41601230000**

<u>DATE</u>	<u>CREW</u>	<u>MONUMENT TYPE</u> -----
March 7, 2019	Zachariah P.Dechant Gary L. Dechant	Existing Harrison intact, at remains of fence corner. Survey sign 1' NE

References:

	<u>Bearing</u>	<u>Distance</u>
1) Set 24" section of steel fence post (T-post)	N40E	14.33'
2) Set 24" section of steel fence post, 4' NW of 8" Maple	S60E	22.82'
3) Set 24" section of steel fence post, 6" NE of 24" White Pine	S74W	24.32'
4) Set 24" section of steel fence post, 5' NE of 36" Double Maple (1977 BT)	N60W	22.65'

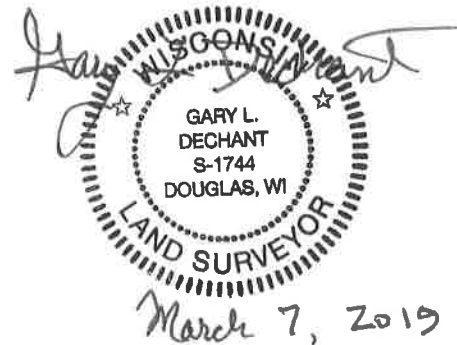

I, Harley A. Sime, do hereby certify that on the 25 day of May 1976, I found (evidence) ~~(no evidence)~~ of the NE corner of Section 26, T. 16 N, R. 1 E, Fourth Principal Meridian, and I re-established said corner according to the Wisconsin Statutes as shown and described hereon.

Dated this 7 day of Sept. 1977.

History of original corner establishment:

O.R.Dahl was at this corner in December of 1870.

Description of corner evidence found:

Accepted a four way fence as the best available evidence. Checked very well with the original government notes along the North line of Section 26.

County Surveyor Title

Approved: **HARLEY A. SIME**  
**MONROE CO. SURVEYOR**

See Reverse Side  
For Maintenance

Description of corner and witness monuments, references and accessories used to perpetuate the original or re-established location of this corner:

Witnesses to corner location:

W. Jung

D. Malliet

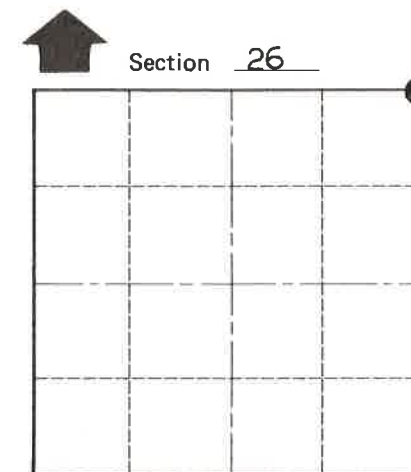
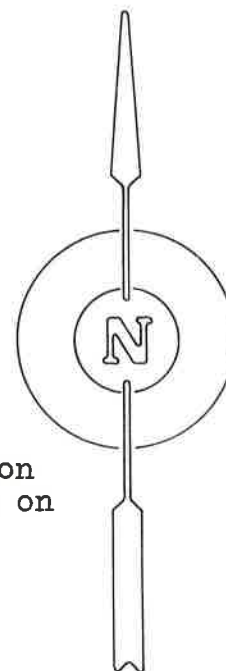
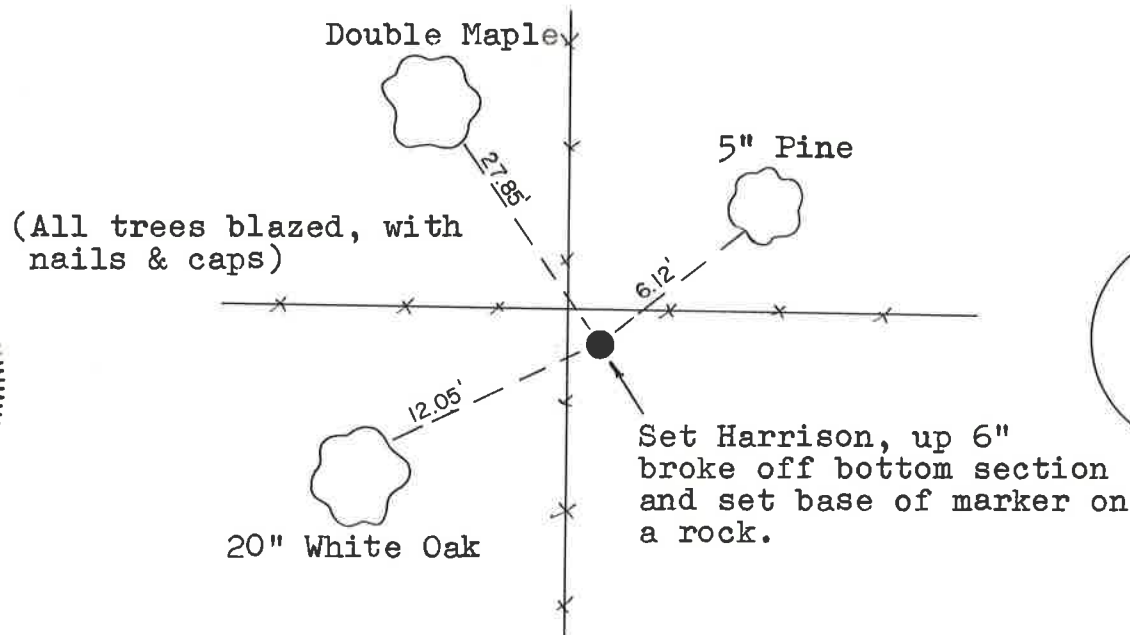

O = LOCATION CORNER  
T 16 N R 1 E  
WISCONSIN

SURVEY CONTROL ORDER

Horizontal	_____
Vertical	_____

WISCONSIN COORDINATE SYSTEM

Corner	East (X)	North (Y)	Elevation (Z)	Zone
Control Sta. Name				

City, Village or Town Clifton

County of Monroe

COUNTY SURVEYOR FORM NO. 1