

**U.S. PUBLIC LAND CORNER  
MAINTENANCE**

# 86

Corner ID: N1/4 Sec. 27, T16N-R1E

41601220020

<u>DATE</u>	<u>CREW</u>	<u>MONUMENT TYPE-----</u>
October 3, 2019	Zachariah P. Dechant Gary L. Dechant	Harrison intact at remnants of old down fence corner. New north fence only 3' east. 17' north of dry run/stream. Set sign 1' north

References:

	<u>Bearing</u>	<u>Distance</u>
1) Set 3/4"x24" round iron bar, down 4", stone over bar	N30E	31.34'
2) Set 3/4"x24" round iron bar, down 4", stone over bar, 20' north of stream/dry run	S69E	23.55'
3) Set 3/4"x24" round iron bar, down 4", with two stones, 10' south of dry run/stream	S20W	26.95'
4) Set 3/4"x24" round iron bar, down 4", 3' south of 8" Cherry	N18W	29.77'

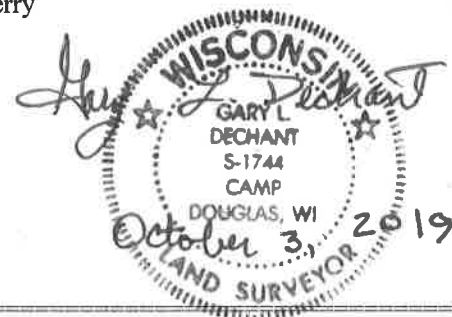

MONROE  
~~JUNEAU~~ COUNTY

Survey Monument Record

TYPE OF MONUMENT: 1" PIPE  
STATE PLANE COORDINATES: N \_\_\_\_\_  
E \_\_\_\_\_  
ELEVATION — M.S.L. DATUM: \_\_\_\_\_  
THETA ANGLE: \_\_\_\_\_  
FIELD BOOK: \_\_\_\_\_ PAGE \_\_\_\_\_

CORNER NO. \_\_\_\_\_  
SECTION 27  
TOWN 16  
RANGE 1 E

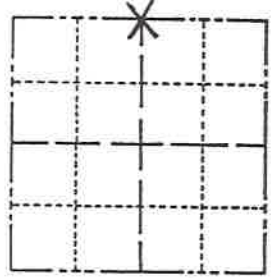

LOCATION  
(Indicated by 'X')

SEAL:

BASIS FOR MONUMENT LOCATION

(Use reverse side if necessary)

Show info such as: History of corner, with reference to Vol. and pg, dates, surveyor; exact description of monument replaced; if location computed, by taped or EDM traverse; landowner remarks, etc.

Set 1"x24" iron pipe at the fence corner location. Dug and probed the area for any previous monument but found nothing. Accepted the fence corner as the corner location.



**See Reverse Side  
For Maintenance**

CERTIFIED CORRECT  
James J. Carroll  
Registered Land Surveyor  
DATE: Oct. 12, 1983

TIE SKETCH

(Show at least four ties)

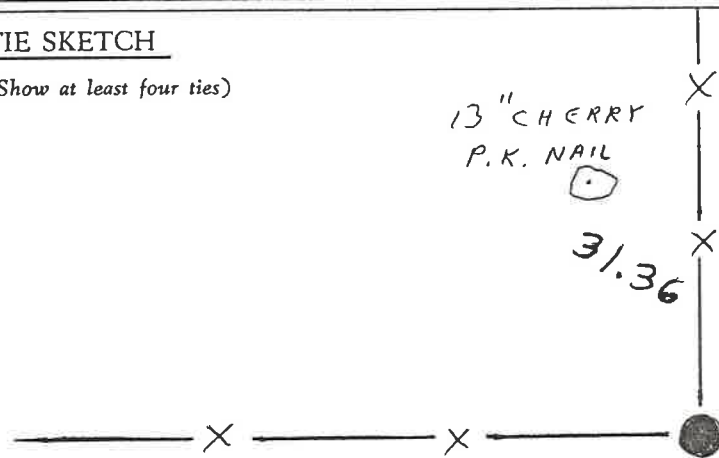

A1601220020

24" HICKORY 54.45  
P.K. NAIL

44.50

101.00

14" HICKORY  
P.K. NAIL

22" HICKORY  
P.K. NAIL

#86

41601220020

I, James J. Carroll, do hereby certify that on the 23rd day of May 1984, I found ~~(evidence)~~ (no evidence) of the N 74 corner of Sec. 27, T. 16 N, R. 1E Fourth Principal Meridian, and I re-established said corner according to the Wisconsin Statutes as shown and described hereon.

Dated this 28 day of May 1984.

James J. Carroll  
RLS S-606  
 Title

History of corner establishment since Original Government Survey

We ran an extensive EDM traverse of Section 27, T16N, R1E tying together all the visible physical features that could be found. The location of this corner post seems to justify the true location for this corner. We accepted this location for the true corner.  
 Description of corner evidence found:

Accepted the existing old leaning fence corner as the true corner location.

**See Reverse Side For Maintenance**

Description of corner and witness monuments, references and accessories used to perpetuate the original or re-established location of this corner:

Witnesses to corner location:

Mike Carroll  
Dan Carroll  
Kevin Carroll

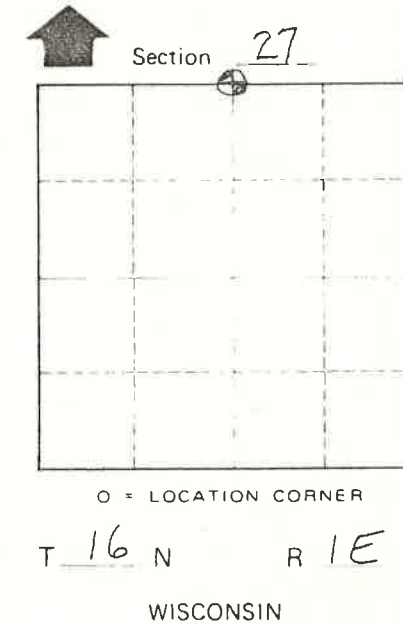
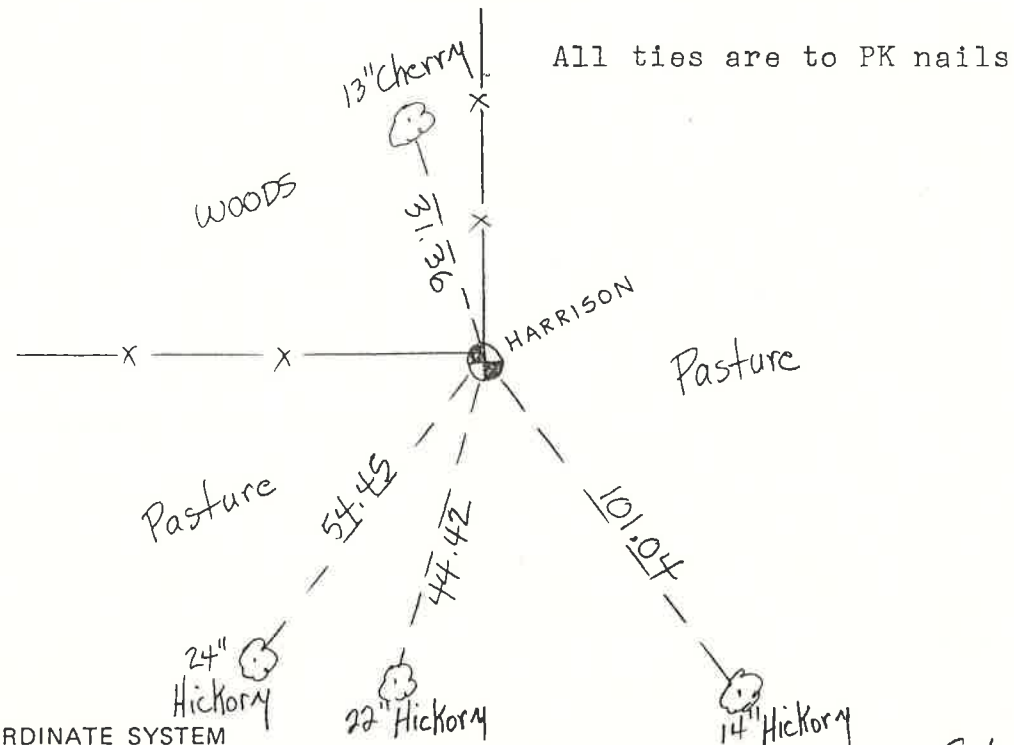

SURVEY CONTROL ORDER

Horizontal
Vertical

WISCONSIN COORDINATE SYSTEM				
Corner	East (X)	North (Y)	Elevation (Z)	Zone
Control Sta. Name				

City, Village or Town CLIFTON  
 County of MONROE

COUNTY SURVEYOR FORM NO. 1