

U.S. LAND CORNER MAINTENANCE

Corner ID : S1/4 Sec.11, T16N-R1E
41601110020

<u>DATE</u>	<u>CREW</u>	<u>MONUMENT TYPE -----</u>
May 10, 2013	Zachariah P.Dechant Gary L. Dechant	Harrison in centerline road, down 8"

References:

Set 1"x24" iron pipe, down 16"
Set 1"x24" iron pipe, down 16"
Set 1"x24" iron pipe 2' north of buried cable sign
Set 1"x24" iron pipe flush north of shrub and telephone ped

<u>Bearing</u>	<u>Distance</u>
N45W	44.50'
N81E	40.92'
S48W	41.20'
S45E	49.40'

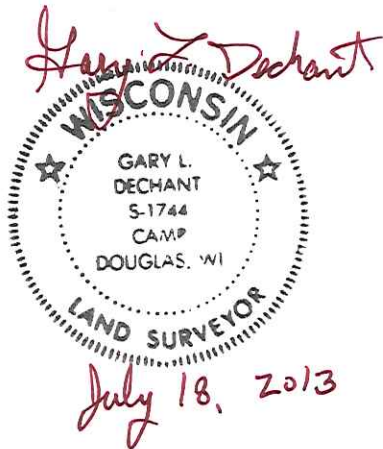

CERTIFICATE

CERTIFIED LAND CORNER

No. 44

41601110020

I, William C. Jung, do hereby certify that on the 13th day of February 1978, I found (evidence) (~~no evidence~~) of the N 1/4 corner of Section 14, T 16 N, R 1 E, Fourth Principal Meridian, and I re-established said corner according to the Wisconsin Statutes as shown and described hereon.

History of original corner establishment:

Fred Holden re-established the corner in November of 1906.

Description of corner evidence found:

Accepted a 3/4" iron bar used in previous surveys as the corner.

Replaced the iron bar with a Harrison marker on 3/28/78.
Crew: Dechant and Pietz

Dated this 13th day of Feb. 1978.

William C. Jung, R.L.S. 1323

Crew Chief, County Surveyor's
Title Office

Description of corner and witness monuments, references and accessories used to perpetuate the original or re-established location of this corner:

Witnesses to corner location:

W. Jung

G. Dechant

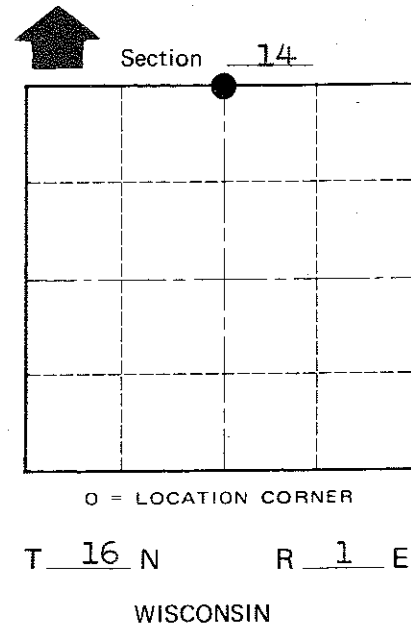
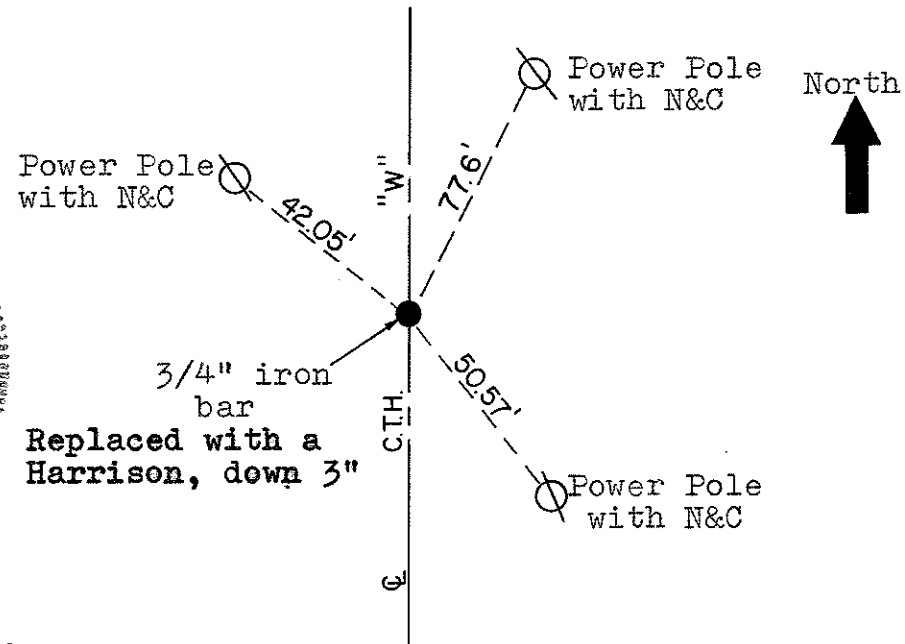
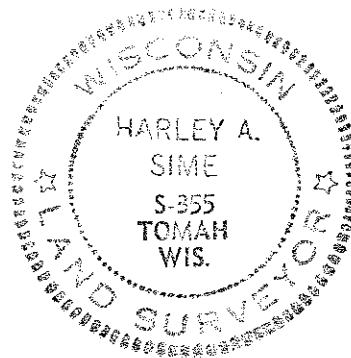
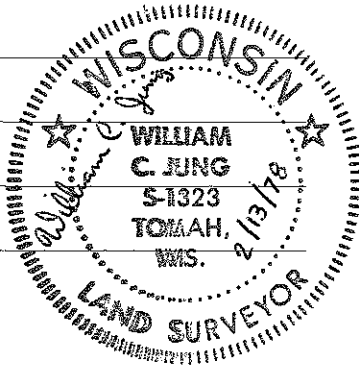

COUNTY SURVEYOR FORM NO. 1

SURVEY CONTROL ORDER

Horizontal _____
Vertical _____

Approved by: Harley A. Sime
County Surveyor

WISCONSIN COORDINATE SYSTEM

Corner	East (X)	North (Y)	Elevation (Z)	Zone
Control Sta. Name				

City, Village or Town Clifton
County of Monroe