

22

**U.S. PUBLIC LAND CORNER
MAINTENANCE**

**Corner ID : S1/4 Sec. 1, T16N-R1E
41601010020**

<u>DATE</u>	<u>CREW</u>	<u>MONUMENT TYPE -----</u>
April 15, 2016	Zachariah P.Dechant Gary L. Dechant	Found Harrison intact at fence corner. Set new survey sign 1' south.

References:

	<u>Bearing</u>	<u>Distance</u>
1) Existing nail in hole on face of stone ledge, 1' up from ground level	N50E	slope distance 22.65' (21.55')
2) Set 3/4"x24" iron pipe, down 6", 4' north of fence	NE	10.78'
3) Existing cross on ledge 3' up from ground level	S85E	slope distance 44.22' (43.58)
4) Set 3/4"x24" iron pipe, down 6", 15' south of fence 3' south of 10" Red Oak	SE	17.57'
5) Set 3/4" x24" iron pipe 4' SE of 15" Black Oak (BT) (Distance to nail in tree checks, 23.66')	N71W	19.62'



I, Gary L. Dechant, do hereby certify that on the 7th day of May 1993, I found (evidence) (~~no evidence~~) of the N¹/₄ corner of Section 12, T 16 N, R 1 E Fourth Principal Meridian, and I re-established said corner according to the Wisconsin Statutes as shown and described hereon.

Dated this 10th day of May 1993.

Gary L. Dechant
 R.L.S. 1744
 Title

History of corner establishment since Original Government Survey

J. Carroll set an 1 1/4" iron pipe here in 1988.

Description of corner evidence found:

Found Carroll's iron pipe tipped. Accepted it as the corner as it fits other section datum very well and replaced the iron pipe with a TCP monument.

Description of corner and witness monuments, references and accessories used to perpetuate the original or re-established location of this corner:

Witnesses to corner location:

David E. Madison

Gary L. Dechant

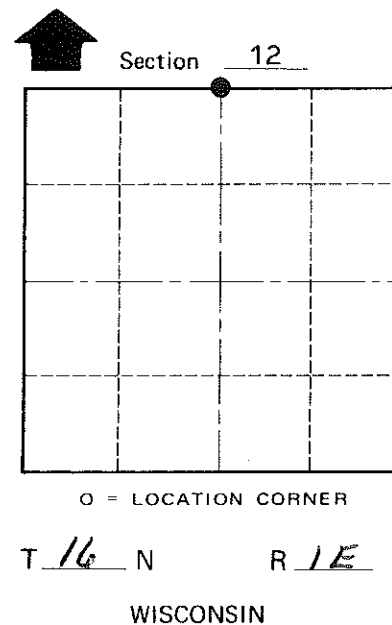
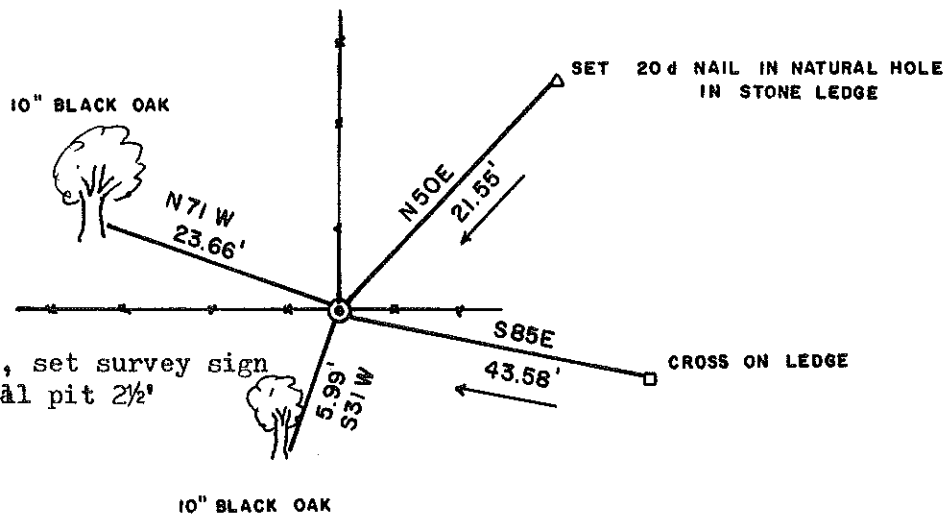
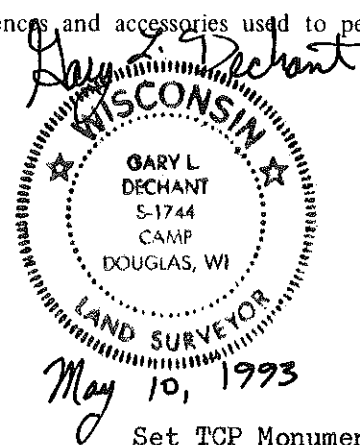

SURVEY CONTROL ORDER

Horizontal	_____
Vertical	_____

WISCONSIN COORDINATE SYSTEM

Corner	East (X)	North (Y)	Elevation (Z)	Zone
Control Sta. Name				

(Trees double blazed with 20d nails set)
 (Arrow indicates slope distance and direction of slope)

~~City, Village or~~ Town Clifton
 County of Monroe

COUNTY SURVEYOR FORM NO. 1