

CERTIFICATE

CERTIFIED LAND CORNER

No. 111

**2150430000**

I, Douglas J. Malliet, do hereby certify that on the 11 day of May 19 78, I found ~~XXXXX~~ (no evidence) of the Northwest corner of Section 32, T 15 N, R 4W ~~XX~~ Fourth Principal Meridian, and I re-established said corner according to the Wisconsin Statutes as shown and described hereon.

Dated this 17 day of May 19 78.

Douglas J. Malliet

REGISTERED LAND SURVEYOR, S-1266  
Title

History of original corner establishment:

No subsequent history of monument perpetuation since the original U.S. Government Survey.

Description of corner evidence found:

This corner was established on line and at the prorated distance between the N $\frac{1}{2}$  corner of Sec. 32 and the N $\frac{1}{2}$  corner of Sec. 31. There was no evidence of corner occupation, except for an east-west fence to the East of this corner location, which agreed fairly well with the corner as we established it. This location also agreed very well with measurements  $\frac{1}{2}$  mile South and 1 mile North. Taking into account the very steep terrain, this method of establishment was considered as the best way to re-establish this corner.

Description of corner and witness monuments, references and accessories used to perpetuate the original or re-established location of this corner:

nail & washer in blazed 3" hickory

nail & washer in blazed 10" white oak

Witnesses to corner location:

Douglas J. Malliet

Lawrence A. Feddersen

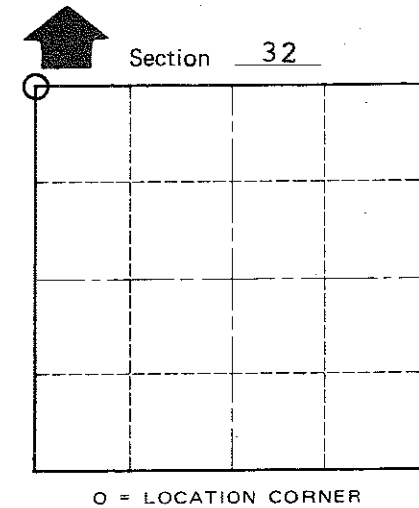
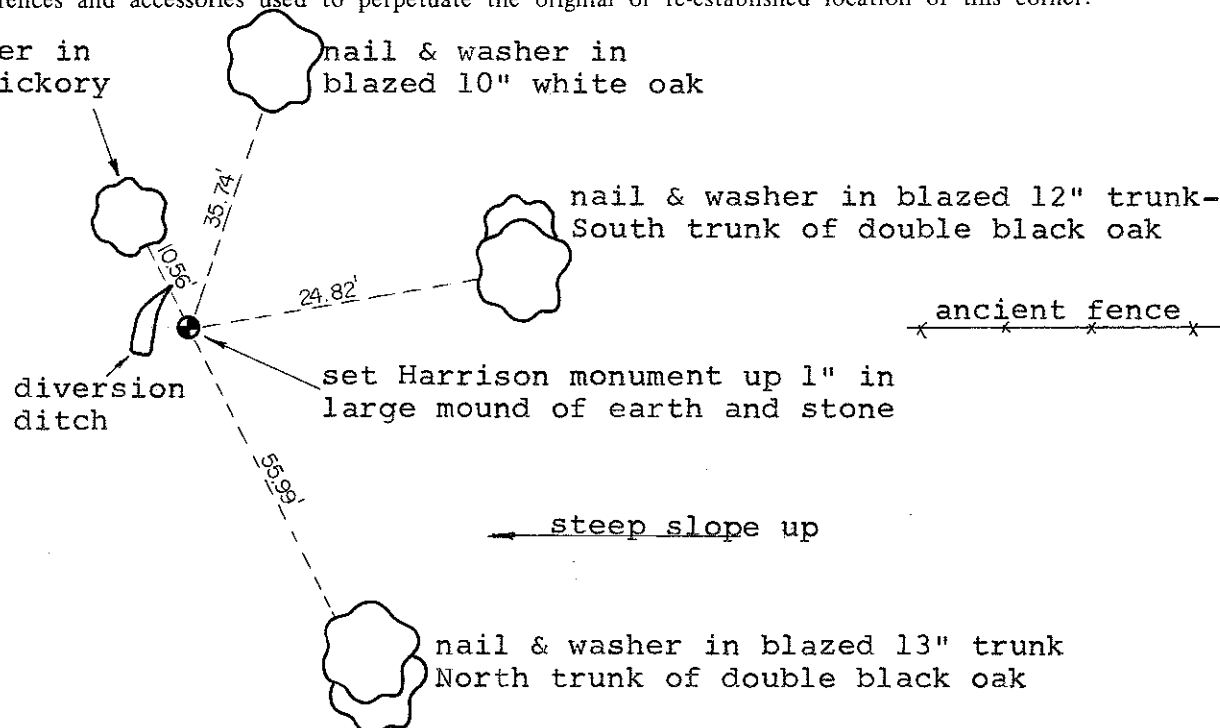

T 15 N R 4 W  
WISCONSIN

COUNTY SURVEYOR FORM NO. 1

SURVEY CONTROL ORDER

|            |       |
|------------|-------|
| Horizontal | _____ |
| Vertical   | _____ |

WISCONSIN COORDINATE SYSTEM

| Corner            | East (X) | North (Y) | Elevation (Z) | Zone |
|-------------------|----------|-----------|---------------|------|
| Control Sta. Name |          |           |               |      |

City, Village or Town of PORTLAND

County of MONROE