

CERTIFICATE

CERTIFIED LAND CORNER

No. 100

21504252000

I, Bryan H. Meyer, do hereby certify that on the 2nd day of July 1982, I found (evidence) ~~(evidence)~~ of the East 1/4 corner of Section 25, T 15 N, R 4 W Fourth Principal Meridian, and I re-established said corner according to the Wisconsin Statutes as shown and described hereon.

History of corner establishment since Original Government Survey
 Fred Holden was here in December of 1909. Gary Sime found an existing pipe here in his December, 1976 survey. Doug Malliet was here in March of 1977 and used an existing pipe.

Dated this 17th day of Jan. 1983.

Description of corner evidence found:

Found a 1 1/4"x36" iron pipe, up 12".

Bryan H. Meyer
 Deputy County Surveyor
 Title

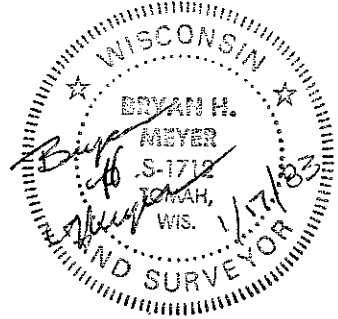

COUNTY SURVEYOR FORM NO. 1

Description of corner and witness monuments, references and accessories used to perpetuate the original or re-established location of this corner:

Found a 1 1/4"x36" iron pipe, up 12", and replaced it with a Harrison monument.

Note: The trees shown are double blazed, with the blazes facing the corner. They are also hacked in the side with a nail set in the hack. Distances Harrison are to the nails.

Witnesses to corner location:

Bryan H. Meyer

John Fox

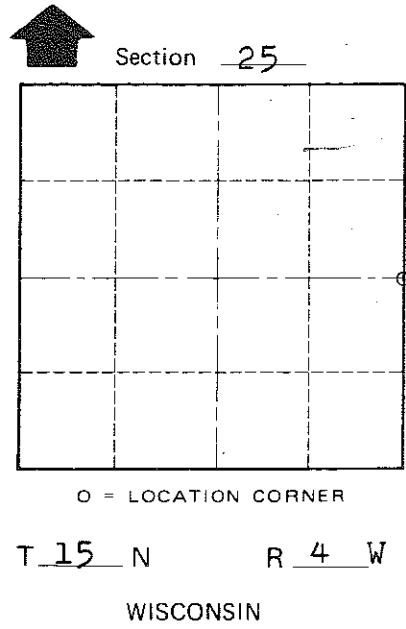
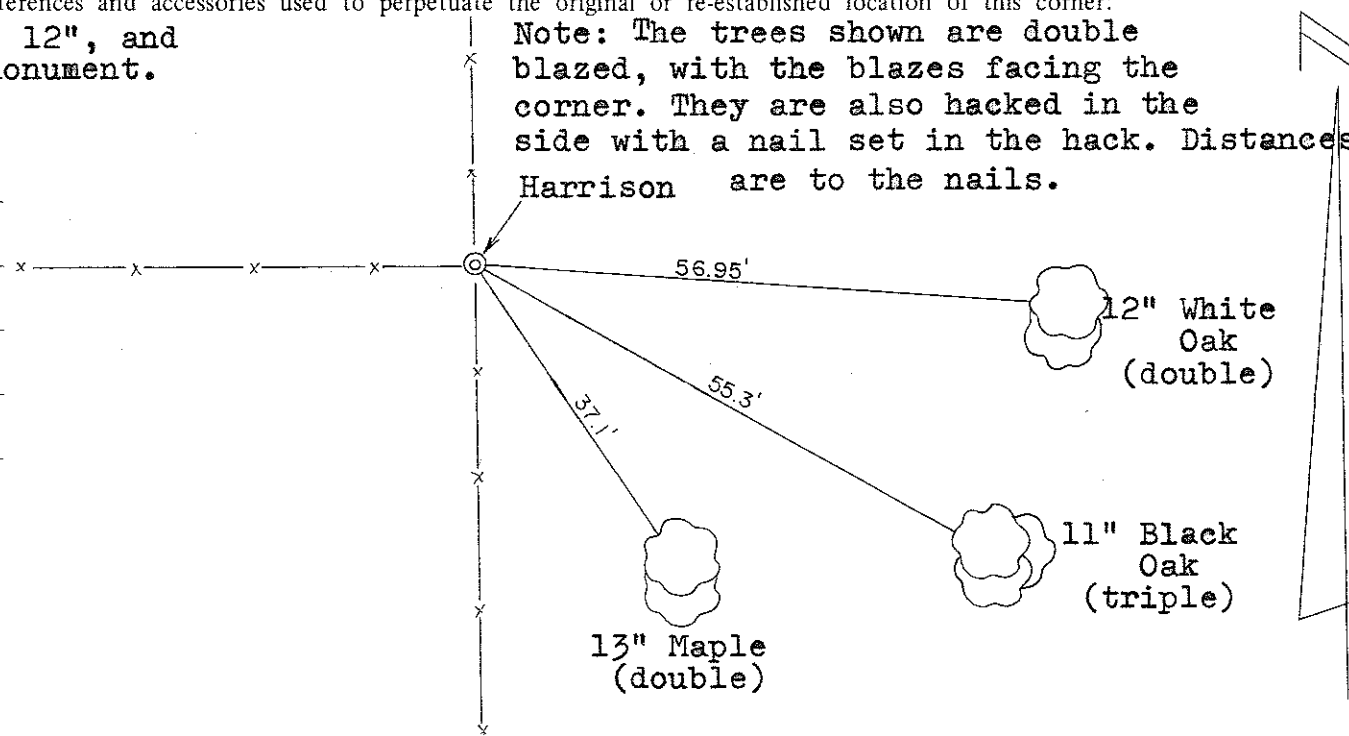

SURVEY CONTROL ORDER

Horizontal	_____
Vertical	_____

WISCONSIN COORDINATE SYSTEM

Corner	East (X)	North (Y)	Elevation (Z)	Zone
Control Sta. Name				

~~City, Village or~~ Town of Portland
 County of Monroe