

21504220000

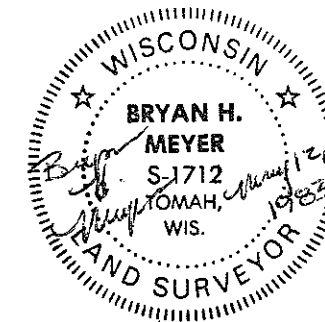

I, Bryan H. Meyer, do hereby certify that on the 10th day of May 19 83, I found (evidence) ~~nothing~~ of the Northwest corner of Section 26, T 15 N, R 4 W Fourth Principal Meridian, and I re-established said corner according to the Wisconsin Statutes as shown and described hereon.

History of corner establishment since Original Government Survey

Nothing recorded.

Description of corner evidence found:

I accepted the 3 way fence corner as the best available evidence.

Dated this 12th day of May 19 83.

Bryan H. Meyer
Deputy County Surveyor

Approved: HARLEY A. SIME
MONROE CO. SURVEYOR

Description of corner and witness monuments, references and accessories used to perpetuate the original or re-established location of this corner:

Date: May 10, 1983 - 2:30 P.M.

Weather: Windy, Sunny, 67°±.

Witnesses to corner location:

Bryan H. Meyer
Bryan H. Meyer - R.L.S. 1712

Set Harrison monument, up 1", on West side of corner post.
Set 5/8"x24" iron rod with round thing-a-ma-bob on top, down 13" in hay field.

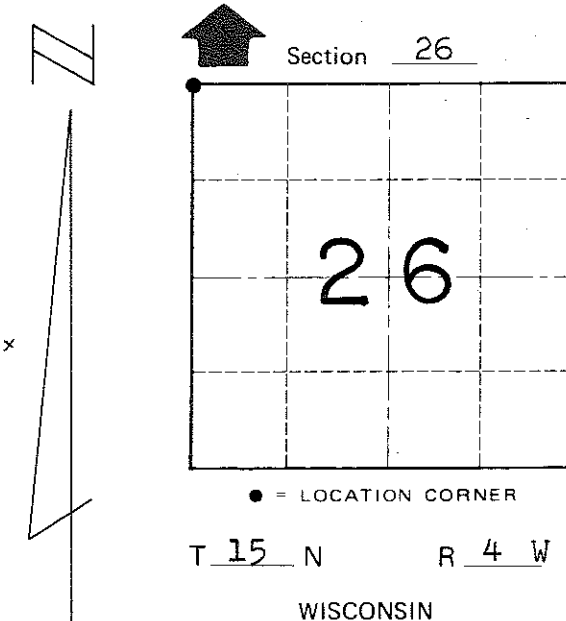
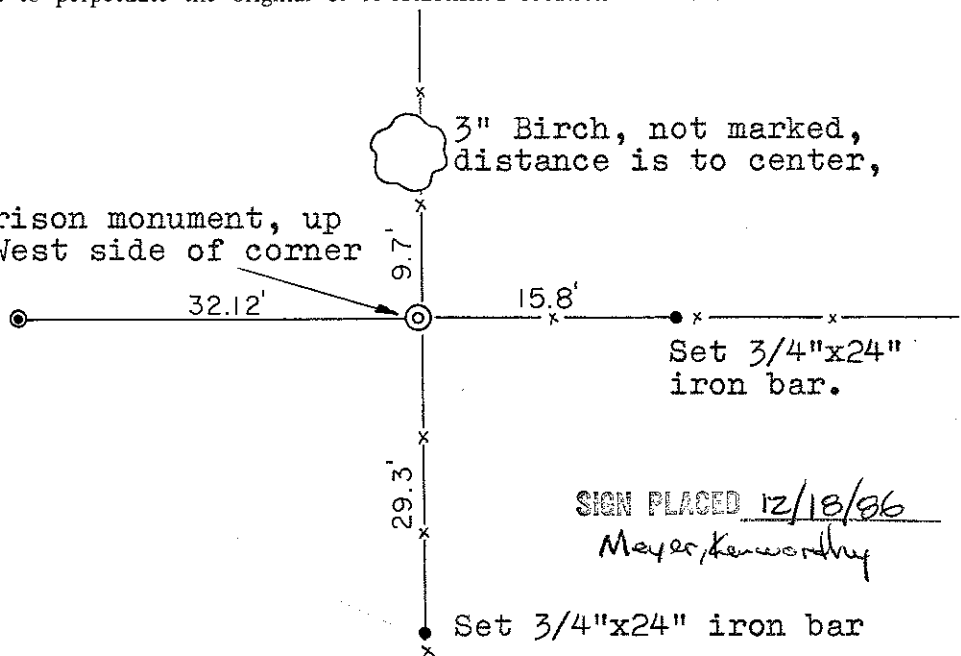

COUNTY SURVEYOR FORM NO. 1

SURVEY CONTROL ORDER

Table with 2 rows: Horizontal, Vertical

Bottle 2' N.

WISCONSIN COORDINATE SYSTEM

Table with 5 columns: Corner, East (X), North (Y), Elevation (Z), Zone

~~Village of~~ Town of Portland
County of Monroe