

CERTIFICATE

I, William C. Jung, do hereby certify that on the 9th day of January 1980, I found (evidence) () of the Northwest corner of Section 29, T 15 N, R 4 W, Fourth Principal Meridian, and I re-established said corner according to the Wisconsin Statutes as shown and described hereon.

Dated this 5th day of Feb. 1981.

William C. Jung  
 William C. Jung, R.L.S. 1323

Approved: <sup>Title</sup> **HARLEY A. SIME**  
**MONROE CO. SURVEYOR**

Description of corner and witness monuments, references and accessories used to perpetuate the original or re-established location of this corner:

Witnesses to corner location:

Jung  
Tormoen  
Hayden  
Dechant

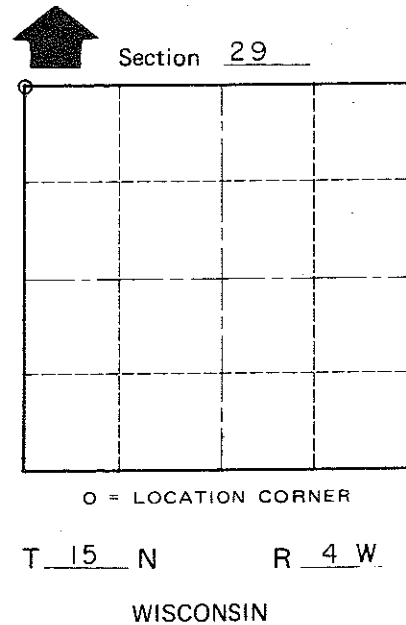
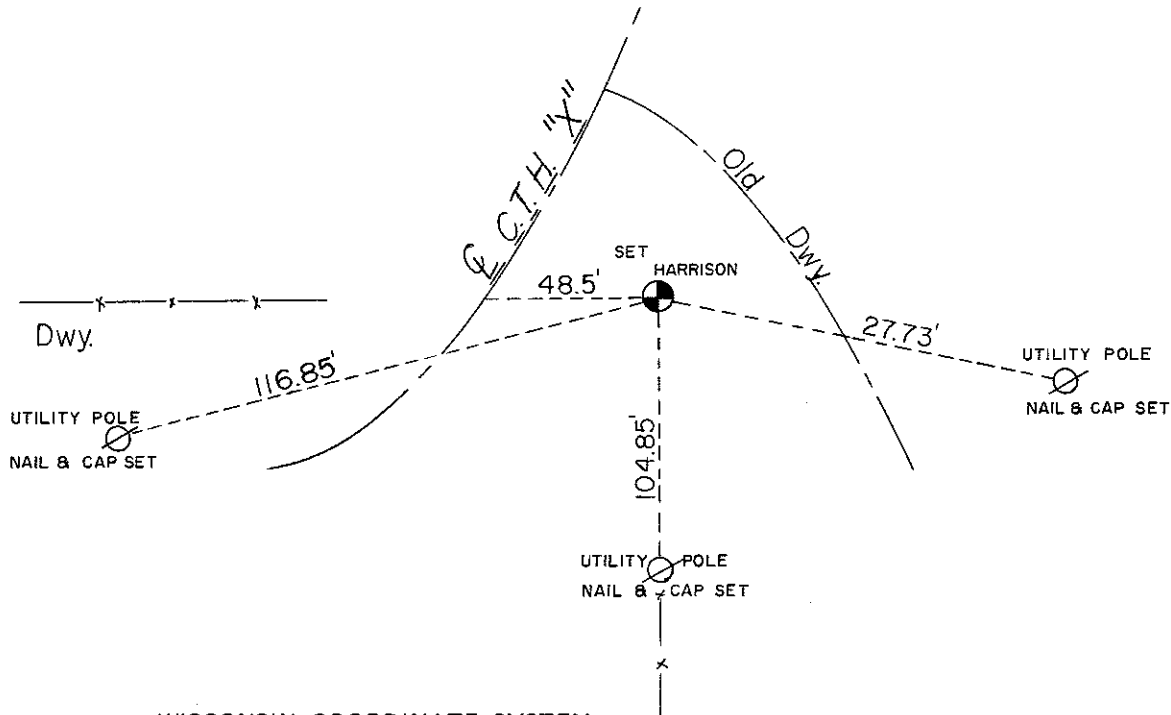
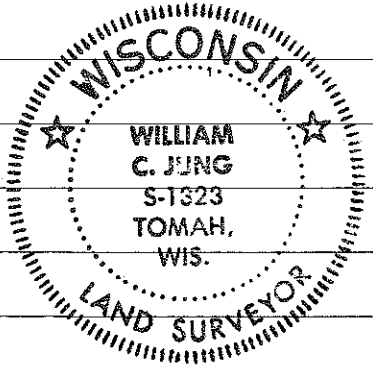

CERTIFIED LAND CORNER

No. 91

**21504190000**

History of original corner establishment:

Holden reestablished this corner in April of 1905.  
 Harley Sime set an iron pipe at this corner in 1964.

Description of corner evidence found:

In July of 1979, Brian Meyer and Darwin Dade found that the iron pipe had been graded out. The old pipe had been at the occupied corner. Found a nail at the occupied corner, apparently set by Malliet and Feddersen. This nail location fits Sime's old position. Removed the nail and set a Harrison marker at the occupied corner. Set by best available evidence.

COUNTY SURVEYOR FORM NO. 1

SURVEY CONTROL ORDER

Horizontal	_____
Vertical	_____

WISCONSIN COORDINATE SYSTEM

Corner	East (X)	North (Y)	Elevation (Z)	Zone
Control Sta. Name				

or Town Portland  
 County of Monroe