

CERTIFICATE

CERTIFIED LAND CORNER

No. 73

2150513000



Bryan H. Meyer  
 H. A. Sime and Associates  
 P. O. Box 50  
 Tomah, Wisconsin 54660  
 Phone: (608)-372-5392

I, Bryan H. Meyer, do hereby certify that on the 30th day of October 19 97, I found (evidence) ~~(no evidence)~~ of the Northwest corner of Section 19, T 15 N, R 4 W Fourth Principal Meridian, and I re-established said corner according to the Wisconsin Statutes as shown and described hereon.

Dated this 27th day of Feb. 19 98.  
Bryan H. Meyer  
 Deputy County Surveyor  
Title

History of corner establishment since Original Government Survey

Fred A. Holden, County Surveyor for Monroe County was at this corner in April of 1905 while doing work in Section 19. No recorded history for this corner was found in the LaCrosse County records.

Description of corner evidence found:

I accepted the two-way fence corner as the best available evidence. This corner location fits very well along the township line.

COUNTY SURVEYOR FORM NO. 1

Description of corner and witness monuments, references and accessories used to perpetuate the original or re-established location of this corner:  
 Crew: Meyer, Malliet  
 Date: October 30, 1997 - 9:00 a. m.  
 Weather: Partly Cloudy, 45°±  
 Witnesses to corner location:

Bryan H. Meyer  
Douglas Malliet

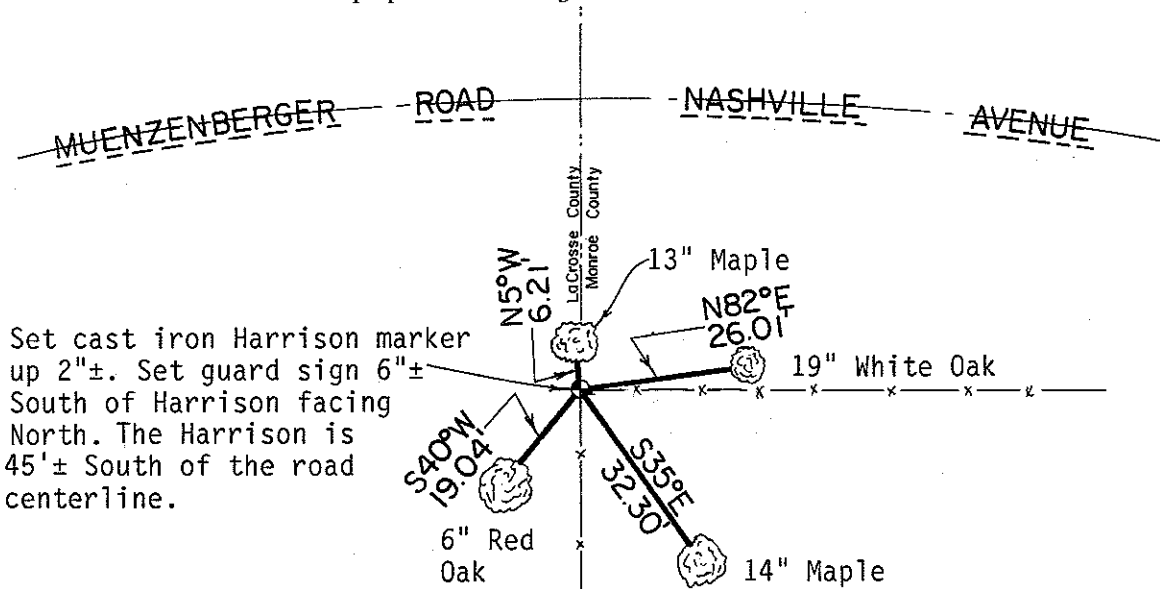

Set cast iron Harrison marker up 2"±. Set guard sign 6"± South of Harrison facing North. The Harrison is 45'± South of the road centerline.

The four trees shown are double blazed; the distance to each tree is to a nail set in a hack in the side of each tree.

The bearings shown on this sheet are magnetic hand compass bearings.

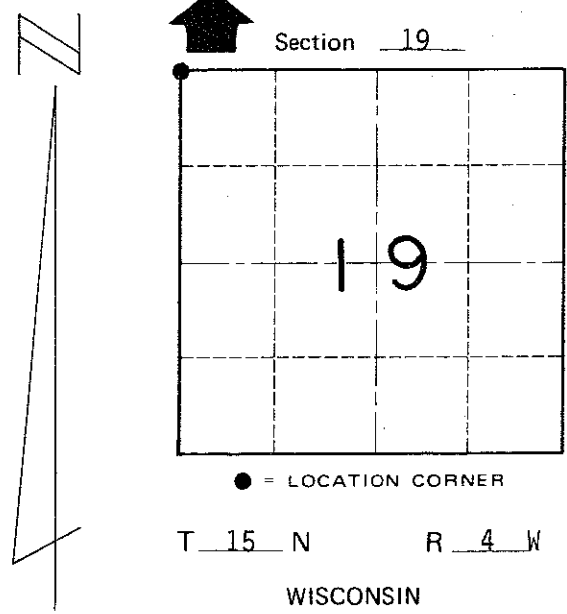

SURVEY CONTROL ORDER

|            |       |
|------------|-------|
| Horizontal | _____ |
| Vertical   | _____ |

WISCONSIN COORDINATE SYSTEM

| Corner            | East (X) | North (Y) | Elevation (Z) | Zone |
|-------------------|----------|-----------|---------------|------|
| Control Sta. Name |          |           |               |      |

~~Village of~~ Town of Portland  
 County of Monroe