

21504152000

I, Bryan H. Meyer, do hereby certify that on the 10th day of May 1983, I found (evidence) ~~of the~~ of the West 1/4 corner of Section 14, T 15 N, R 4 W Fourth Principal Meridian, and I re-established said corner according to the Wisconsin Statutes as shown and described hereon.

Dated this 12th day of May 1983.

Bryan H. Meyer
Deputy County Surveyor

Approved: ^{Title} **HARLEY A. SIME**
MONROE CO. SURVEYOR

Description of corner and witness monuments, references and accessories used to perpetuate the original or re-established location of this corner:
Date: May 10, 1983 - 9:00 A.M.
Weather: Sunny, Breezy, 60°±.

Witnesses to corner location:

Bryan H. Meyer
Bryan H. Meyer - R.L.S. 1712

History of corner establishment since Original Government Survey

O.R. Dahl was here in January of 1869.

Description of corner evidence found:

I accepted the 3 way fence corner as the best available evidence.

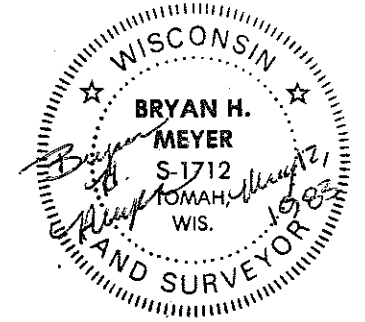

COUNTY SURVEYOR FORM NO. 1

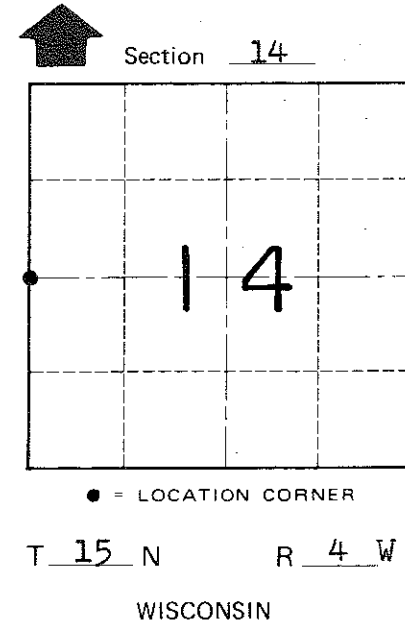
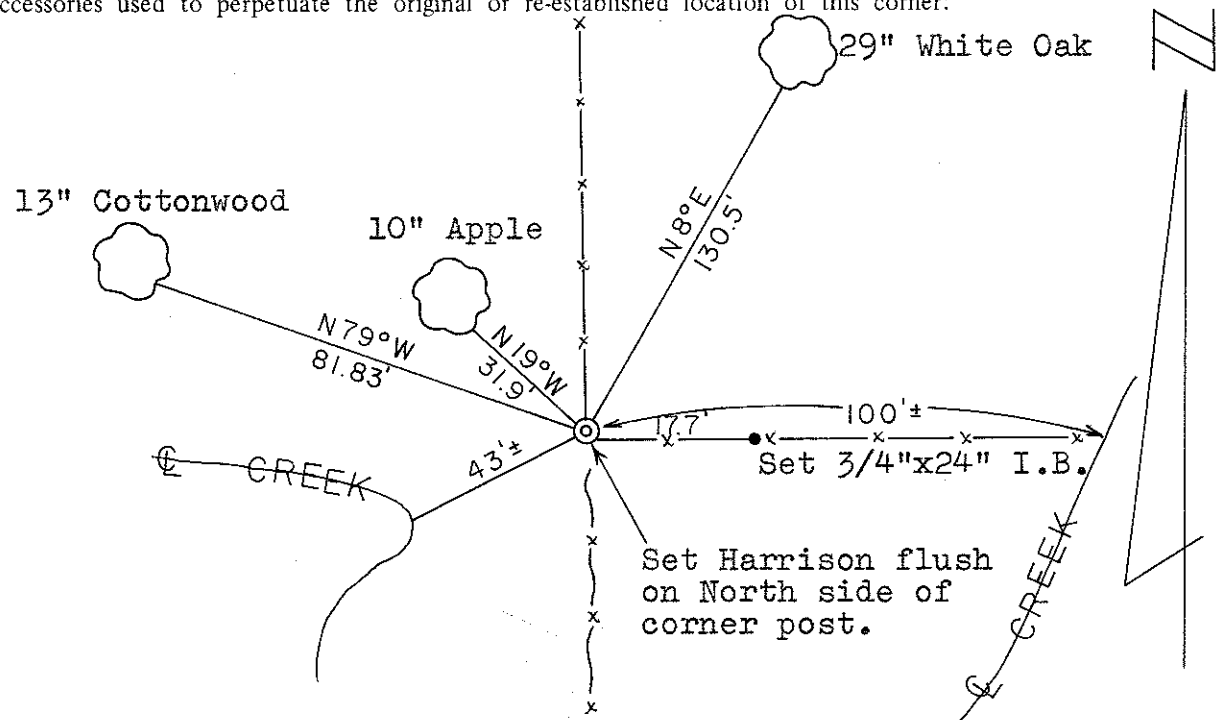

SURVEY CONTROL ORDER

Horizontal	_____
Vertical	_____

WISCONSIN COORDINATE SYSTEM

Corner	East (X)	North (Y)	Elevation (Z)	Zone
Control Sta. Name				

~~City, Village or~~ Town of Portland
County of Monroe