

66

**U.S. PUBLIC LAND CORNER
MAINTENANCE**

**Corner ID : S1/4 Sec. 15, T15N-R4W
21504150020**

DATE	CREW	MONUMENT TYPE -----
August 24, 2017	Zachariah P.Dechant Gary L. Dechant	Corner destroyed. Falls over shallow culvert. Reset with railroad spike. from existing ties. Corner falls approx 6' East of Navy Road and 19' north of Nebraska Ave.

References:	Bearing	Distance
1) Set 3/4"x24" round iron bar in field, down 8"	N31E	69.10'
2) Existing nail in sawed off power pole (from tie sheet 5-19-1983)	NE	39.68'
3) Set 3/4"x24" round iron bar 5' north and 14' east of gravestone for Aberiana & Noel Dunhem January 15, 2008 October 11, 2009	S46E	67.58'
4) Set 3/4"x24" round iron bar 20' NE of huge double Maple	S31W	87.46'
5) Existing 2" iron pipe (from tie sheet 5-19-1983) Set survey sign 6" north	N70W	34.75'
6) Set 3/4" round iron bar in field, down 10"	N46W	54.66'
7) NW corner of steeple of church (from tie sheet 5-19-1983.)	SW	178.20' (178.17')

**Railroad spike and reference markers 1 & 4 set on straight line.
Railroad spike and reference markers 3 & 6 set on straight line.**

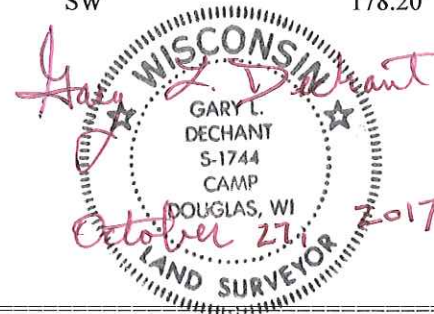

21504150020

I, Bryan H. Meyer, do hereby certify that on the 16th day of May 1983, I found ~~evidence~~ (no evidence) of the North 1/4 corner of Section 22, T 15 N, R 4 W Fourth Principal Meridian, and I re-established said corner according to the Wisconsin Statutes as shown and described hereon.

History of corner establishment since Original Government Survey

Nothing recorded.

See Reverse Side For Maintenance



Dated this 19th day of May 1983.

Bryan H. Meyer
Deputy County Surveyor
Title

Description of corner evidence found:
Set this corner on line and equidistant between the Northwest and Northeast corners of Section 22.

COUNTY SURVEYOR FORM NO. 1

Description of corner and witness monuments, references and accessories used to perpetuate the original or re-established location of this corner:

Date: May 16, 1983 - 11:30 A.M.
Weather: Overcast 50°±.

Witnesses to corner location:

Bryan H. Meyer - R.L.S. 1712

Dallas Wilhite

Approved: **HARLEY A. SIME**
MONROE CO. SURVEYOR

Set 2 1/2"x30" iron pipe on Southeast side of street sign.

Nail in powerpole.

Set Harrison down 1"±.

ELDORA AVE.

Double Maple (distance is to nail only)

Northwest corner of steeple of Portland Lutheran Church.

SIGN PLACED 12/18/86
Meyer, Kenworthy



SURVEY CONTROL ORDER

Horizontal	_____
Vertical	_____

WISCONSIN COORDINATE SYSTEM

Corner	East (X)	North (Y)	Elevation (Z)	Zone
Control Sta. Name				

~~City, Village or~~ Town of Portland
County of Monroe