

CERTIFICATE

CERTIFIED LAND CORNER

No. 63

21504140000

I, Bryan H. Meyer, do hereby certify that on the 18th day of May 1983, I found (evidence) ~~no evidence~~ of the Southeast corner of Section 14, T 15 N, R 4 W Fourth Principal Meridian, and I re-established said corner according to the Wisconsin Statutes as shown and described hereon.

History of corner establishment since Original Government Survey

Nothing Recorded.

Description of corner evidence found:

Accepted E-W fence on West side of road and the centerline of the Town Road from South as the best available evidence.

Dated this 21st day of Dec. 1983.

Bryan H. Meyer
Deputy County Surveyor
Title

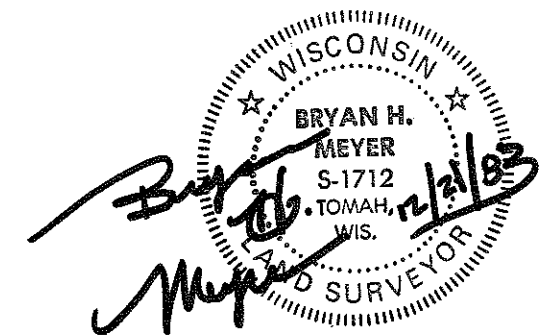

COUNTY SURVEYOR FORM NO. 1

Description of corner and witness monuments, references and accessories used to perpetuate the original or re-established location of this corner:

Crew: Meyer, Wilhite
Date: May 18, 1983 - 11:00 A.M.
Weather: Overcast, 50°±.

Witnesses to corner location:

Bryan H. Meyer
Dallas Wilhite

APPROVED: Harley A. Sime
Monroe County Surveyor

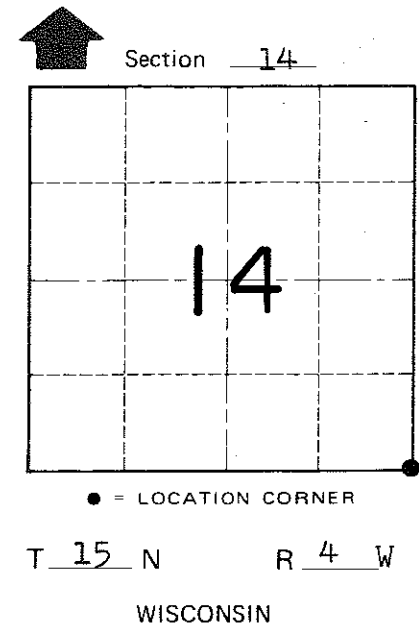
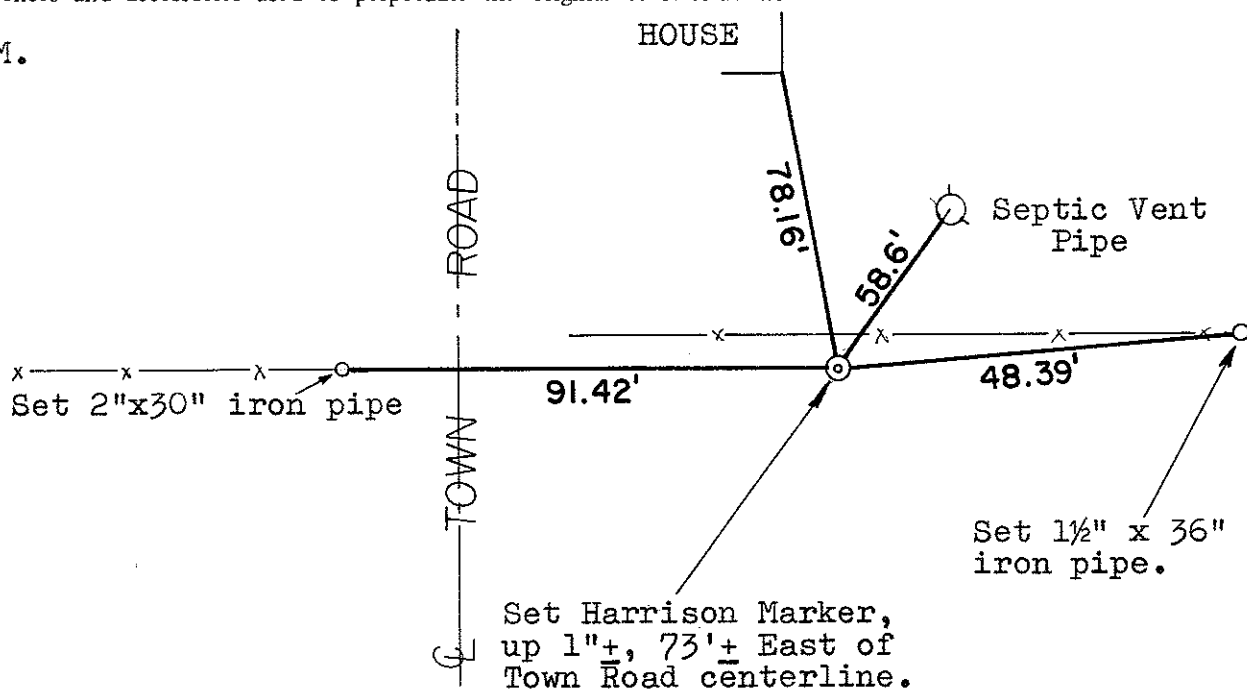

SURVEY CONTROL ORDER

Horizontal	_____
Vertical	_____

WISCONSIN COORDINATE SYSTEM

Corner	East (X)	North (Y)	Elevation (Z)	Zone
Control Sta. Name				

~~City, Village or~~ Town Of Portland
County of Monroe