

CERTIFICATE

CERTIFIED LAND CORNER

No. 62

21504130020

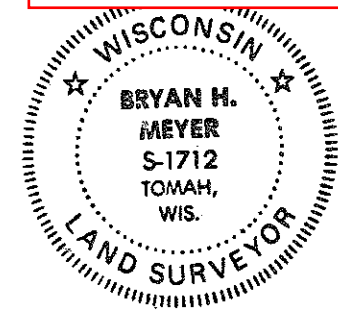

Bryan H. Meyer
 H. A. Sime and Associates
 P. O. Box 50
 Tomah, Wisconsin 54660
 Phone: (608)-372-5392

I, Bryan H. Meyer, do hereby certify that on the 3rd day of September 1998, I found (evidence) ~~no evidence~~ of the South 1/4 corner of Section 13, T 15 N, R 4 W Fourth Principal Meridian, and I re-established said corner according to the Wisconsin Statutes as shown and described hereon.

Dated this 5th day of October 1998.

Bryan H. Meyer

Deputy County Surveyor
Title

History of corner establishment since Original Government Survey

No recorded history.

Description of corner evidence found:

I found the occupied three-way fence corner and took measurements North and East to existing monumentation and accepted the three-way corner as the best available evidence.

Description of corner and witness monuments, references and accessories used to perpetuate the original or re-established location of this corner:

Crew: Meyer, Miller
 Date: September 3, 1998
 Weather: Clear, 60°±
 Witnesses to corner location:

Bryan H. Meyer

Bruce Miller

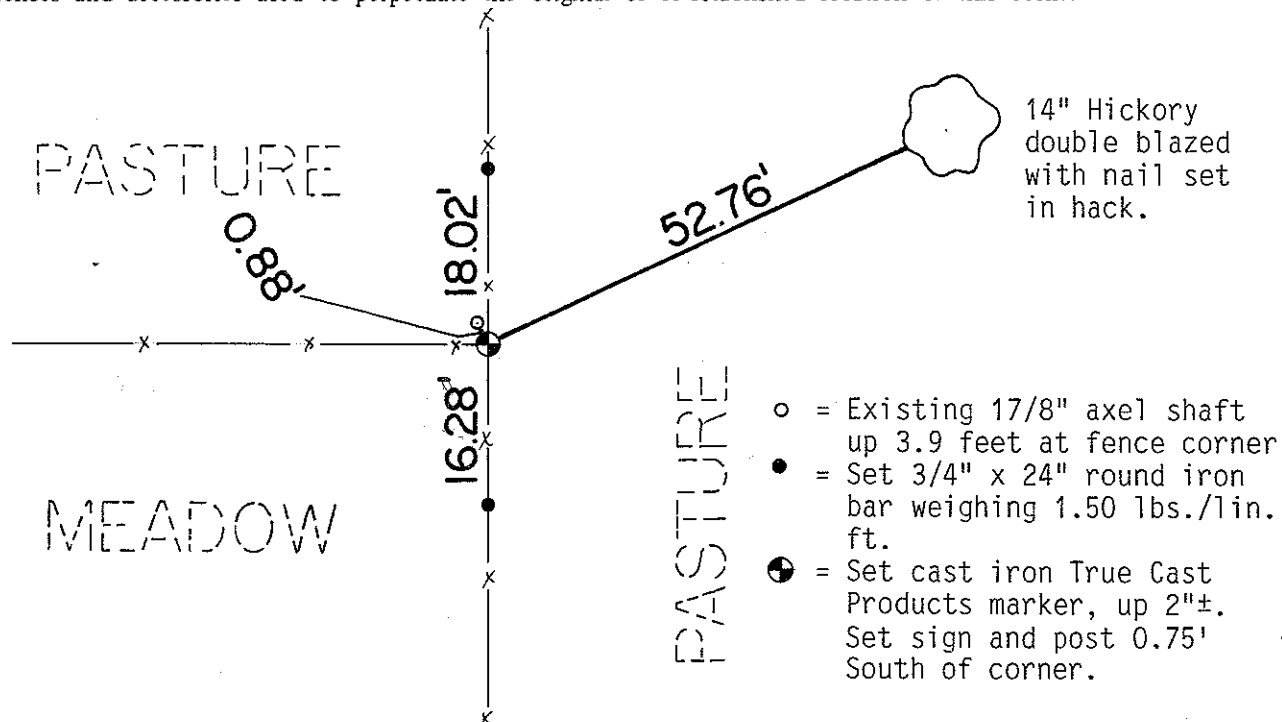

14" Hickory double blazed with nail set in hack.

- = Existing 17/8" axel shaft up 3.9 feet at fence corner
- = Set 3/4" x 24" round iron bar weighing 1.50 lbs./lin. ft.
- ⊕ = Set cast iron True Cast Products marker, up 2"±. Set sign and post 0.75' South of corner.

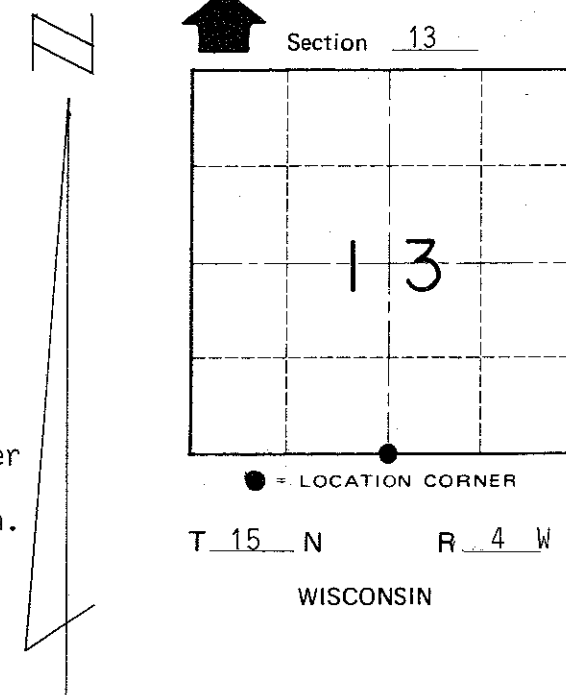

COUNTY SURVEYOR FORM NO. 1

SURVEY CONTROL ORDER

Horizontal	_____
Vertical	_____

WISCONSIN COORDINATE SYSTEM

Corner	East (X)	North (Y)	Elevation (Z)	Zone
Control Sta. Name				

~~Village of~~ Town of Portland

County of Monroe