

CERTIFICATE

CERTIFIED LAND CORNER

No. 34

21505122000

I, Gary L. Dechant, do hereby certify that on the 19th day of November 19 86, I found (evidence) (no evidence) of the W 1/4 corner of Section 7, T 15 N, R 4W Fourth Principal Meridian, and I re-established said corner according to the Wisconsin Statutes as shown and described hereon.

Dated this 17th day of Dec. 19 86.

Gary L. Dechant

Registered Land Surveyor, 1744

Title

History of corner establishment since Original Government Survey

No known recorded history since the original government survey.

Description of corner evidence found:

Accepted 4-way fence corner as best available evidence. My "Rookie Assistant" has this Harrison facing west.

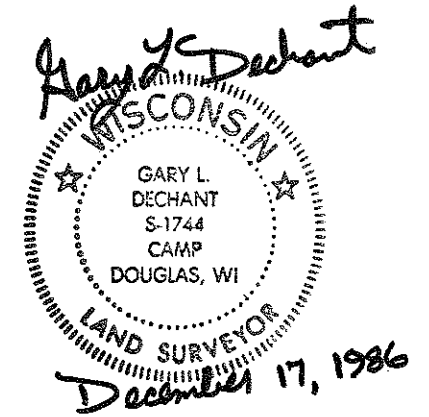

COUNTY SURVEYOR FORM NO. 1

Description of corner and witness monuments, references and accessories used to perpetuate the original or re-established location of this corner:

Cloudy, Gusting Winds

Witnesses to corner location:

David E. Madison (rookie)

Gary L. Dechant

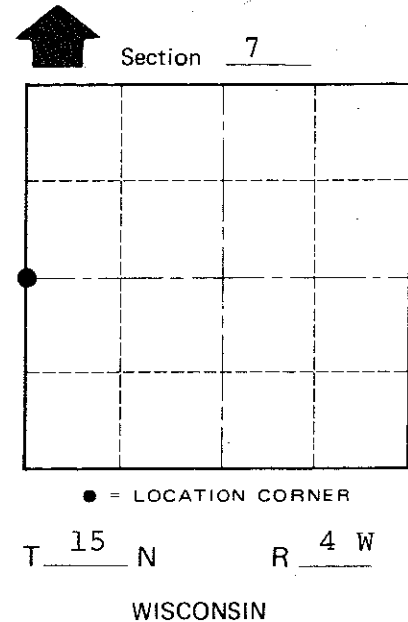
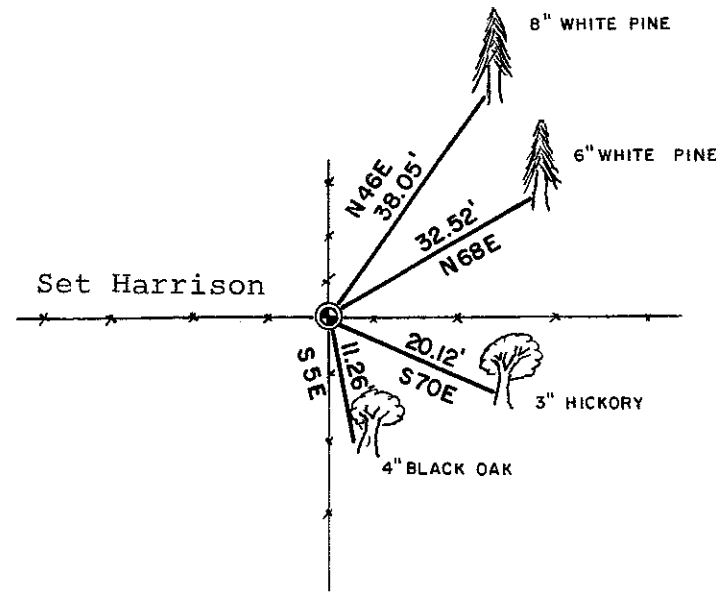

(Trees double blazed with N&C's set)

SURVEY CONTROL ORDER

Horizontal _____
Vertical _____

WISCONSIN COORDINATE SYSTEM

Table with 5 columns: Corner, East (X), North (Y), Elevation (Z), Zone. Row 1: Control Sta. Name

City/Village/Town: Portland
County of: Monroe