

21504100000

I, Lawrence A. Feddersen, do hereby certify that on the First day of September 19 92, I found (evidence) (no evidence) of the Northeast corner of Section 15, T 15 N, R 4 W Fourth Principal Meridian, and I re-established said corner according to the Wisconsin Statutes as shown and described hereon.

Dated this 21st day of Sept. 1992.

Lawrence A. Feddersen

Registered Land Surveyor, S-1226  
Title

History of corner establishment since Original Government Survey

No known history recorded since original government survey.

Description of corner evidence found:

Projected corner of two-way fence does not agree with distances to forty fence corner to South and the East Quarter corner of Section 15. Corner was set on a straight line and distance prorated between the Southeast corner of Section 15 and the East Quarter corner of Section 10.

Description of corner and witness monuments, references and accessories used to perpetuate the original or re-established location of this corner:

Witnesses to corner location:

Lawrence A. Feddersen

Timothy J. Jeatran

Henry V. Amberson

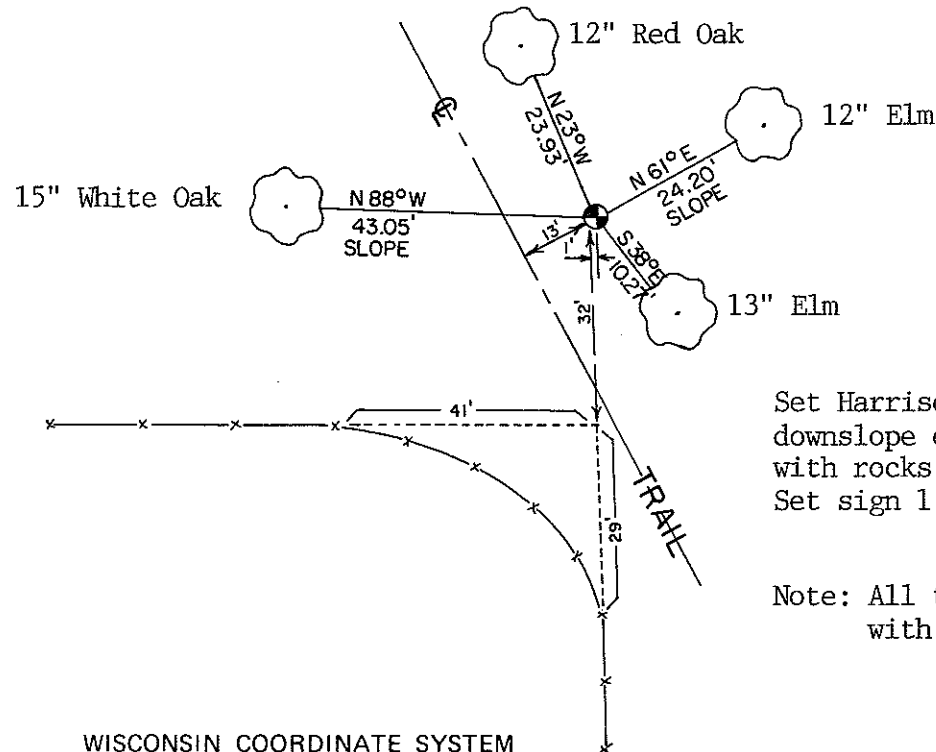

Set Harrison monument up 2\"/>

Note: All trees shown are double blazed with nail & washer in bottom blaze.

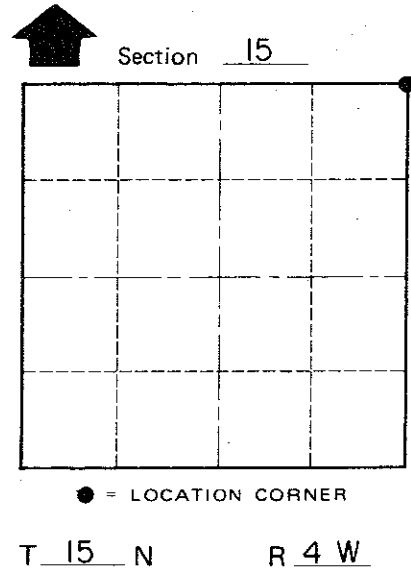

COUNTY SURVEYOR FORM NO. 1

SURVEY CONTROL ORDER

Table with 2 rows: Horizontal, Vertical

WISCONSIN COORDINATE SYSTEM

Table with 5 columns: Corner, East (X), North (Y), Elevation (Z), Zone

City or Village or Town of Portland  
County of Monroe