

CERTIFICATE

I, Gary L. Dechant, do hereby certify that on the 19th day of November 1986, I found (evidence) ~~(no evidence)~~ of the S 1/4 corner of Section 7, T15 N, R 4 W Fourth Principal Meridian, and I re-established said corner according to the Wisconsin Statutes as shown and described hereon.

Dated this 17th day of Dec. 1986.

Gary L. Dechant

Registered Land Surveyor, 1744  
Title

CERTIFIED LAND CORNER

History of corner establishment since Original Government Survey

No known recorded history since the original government survey.

Description of corner evidence found:

Accepted 4-way fence corner as best available evidence.

No. 52

**21504070020**

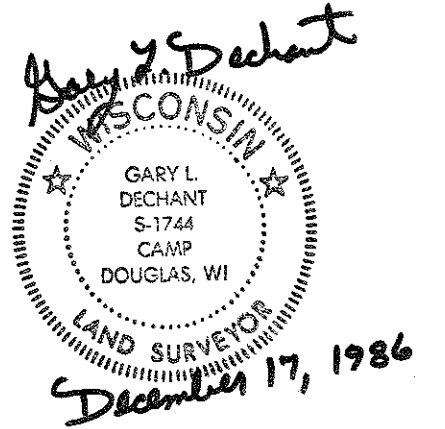

COUNTY SURVEYOR FORM NO. 1

Description of corner and witness monuments, references and accessories used to perpetuate the original or re-established location of this corner:

Witnesses to corner location:

David E. Madison

Gary L. Dechant

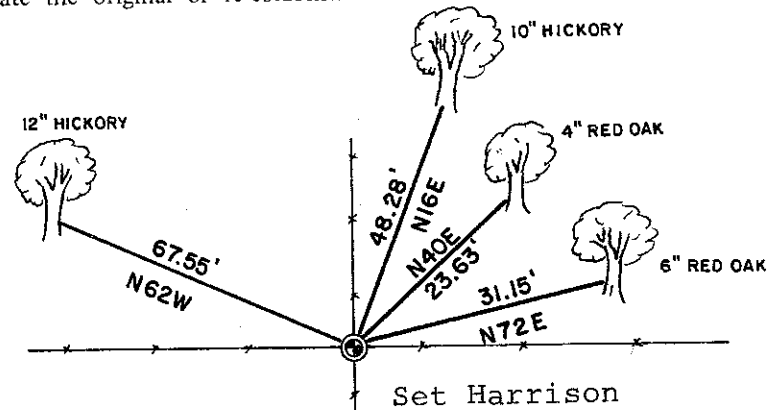

(Trees double blazed with N&C'sset)

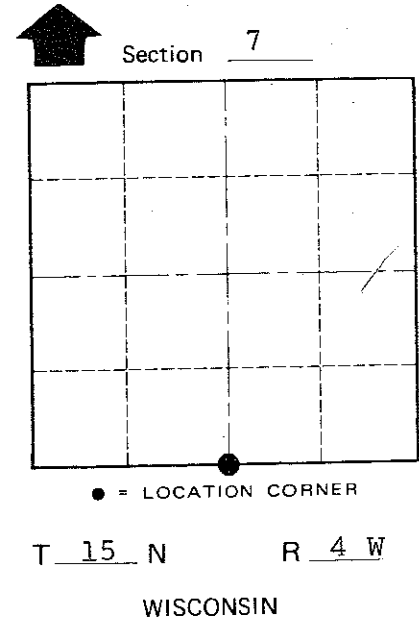

SURVEY CONTROL ORDER

Horizontal \_\_\_\_\_  
Vertical \_\_\_\_\_

WISCONSIN COORDINATE SYSTEM

Corner	East (X)	North (Y)	Elevation (Z)	Zone
Control Sta. Name				

~~City, Village or~~ Town Portland  
County of Monroe