

CERTIFICATE

CERTIFIED LAND CORNER

No. 31

21504060000

Gary L. Dechant  
WISCONSIN  
GARY L. DECHANT  
S-1744  
CAMP  
DOUGLAS, WI  
LAND SURVEYOR  
December 17, 1986

I, Gary L. Dechant, do hereby certify that on the 28th day of November 19 86, I found (evidence) (no evidence) of the NE corner of Section 7, T 15 N, R 4w Fourth Principal Meridian, and I re-established said corner according to the Wisconsin Statutes as shown and described hereon.

Dated this 17th day of Dec. 19 86.

Gary L. Dechant

Registered Land Surveyor, 1744  
Title

History of corner establishment since Original Government Survey

No known recorded history since the original government survey.

Description of corner evidence found:

Replaced 1 1/4" round iron bar, set by us earlier in the year, at the intersection of Section line fences, with a Harrison Monument. This corner fits other Section corners well.

Description of corner and witness monuments, references and accessories used to perpetuate the original or re-established location of this corner:

Sunny & Pleasant

Witnesses to corner location:

David E. Madison

Lawrence A. Feddersen

Gary L. Dechant

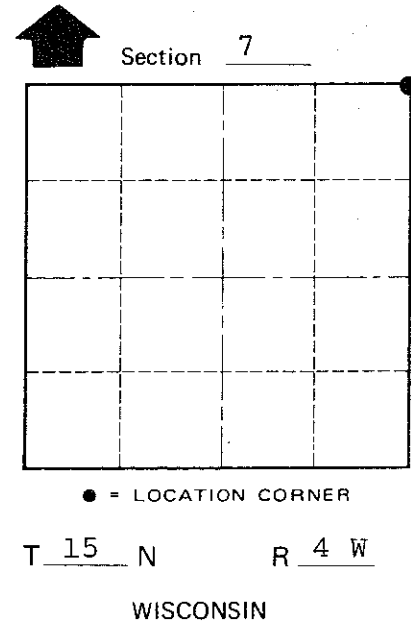
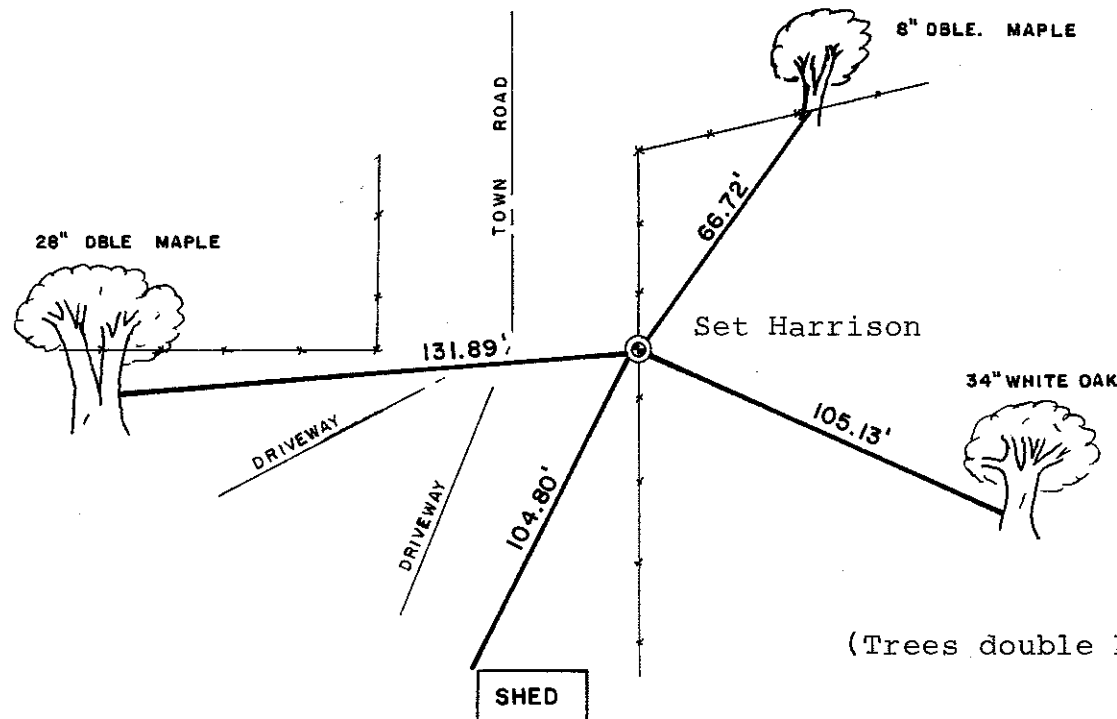

(Trees double blazed with N&C's set)

COUNTY SURVEYOR FORM NO. 1

SURVEY CONTROL ORDER

Horizontal \_\_\_\_\_  
Vertical \_\_\_\_\_

WISCONSIN COORDINATE SYSTEM

Corner	East (X)	North (Y)	Elevation (Z)	Zone
Control Sta. Name				

~~City, Village or~~ Town Portland  
County of Monroe