

CERTIFICATE

CERTIFIED LAND CORNER

No. 30

21504050020

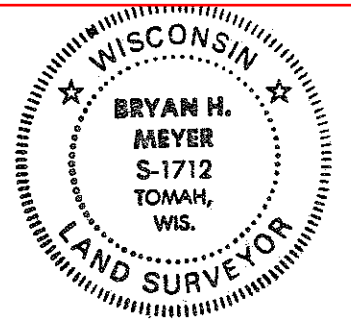

H. A. Sime and Associates
P. O. Box 705, Tomah, WI
Phone: (608)-372-5392

I, Bryan H. Meyer, do hereby certify that on the 13th day of December 19 89, I found (evidence) ~~of the~~ of the North 1/4 corner of Section 8, T 15 N, R 4 W Fourth Principal Meridian, and I re-established said corner according to the Wisconsin Statutes as shown and described hereon.

Dated this 15th day of Dec. 19 89.

Bryan H. Meyer
Deputy County Surveyor
Title

History of corner establishment since Original Government Survey

A. B. Holden was here in March of 1880.

Description of corner evidence found:

I set this corner at the intersection of fenceline projections from the North, East and South.

COUNTY SURVEYOR FORM NO. 1

Description of corner and witness monuments, references and accessories used to perpetuate the original or re-established location of this corner:

Crew: Meyer, Forsythe
Date: December 13, 1989

Witnesses to corner location:

Bryan H. Meyer

Brian Forsythe

Note: The bearings shown hereon are magnetic hand compass bearings.

Note: Harrison is 11'± West of Town Road centerline

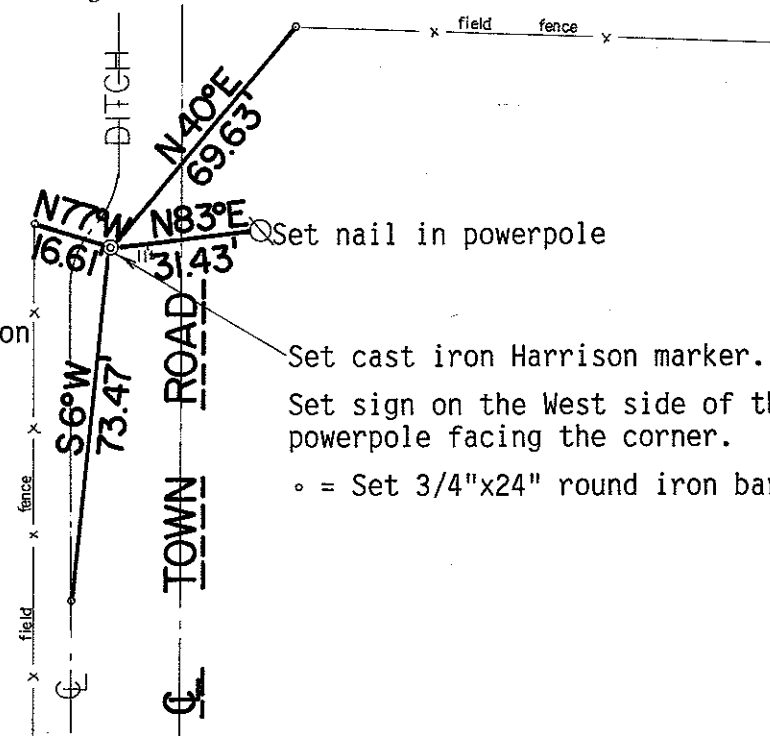

Set nail in powerpole
Set cast iron Harrison marker.
Set sign on the West side of the powerpole facing the corner.
◦ = Set 3/4"x24" round iron bar

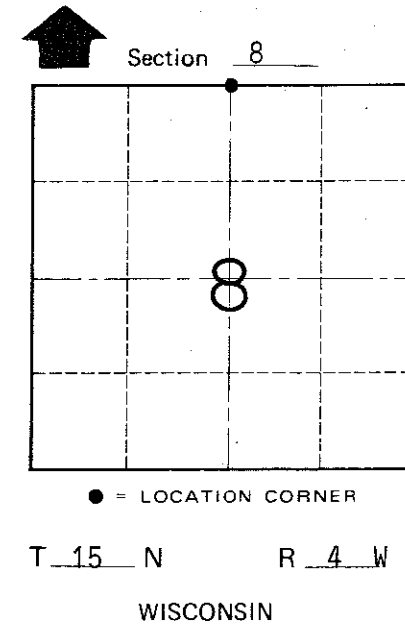

SURVEY CONTROL ORDER

Horizontal	_____
Vertical	_____

WISCONSIN COORDINATE SYSTEM

Corner	East (X)	North (Y)	Elevation (Z)	Zone
Control Sta. Name				

~~City/Village of~~ Town of Portland
County of Monroe