

21503280020

I, William C. Jung, do hereby certify that on the 16th day of December 19 81, I found (evidence) ~~no evidence~~ of the North 1/4 corner of Section 33, T 15 N, R 3 W Fourth Principal Meridian, and I re-established said corner according to the Wisconsin Statutes as shown and described hereon.

Dated this 24th day of Dec. 19 81.

William C. Jung

Registered Land Surveyor 1323

Title

William C. Jung

Description of corner and witness monuments, references and accessories used to perpetuate the original or re-established location of this corner:

Witnesses to corner location:

Jung

Dechant

Meyer

COUNTY SURVEYOR FORM NO. 1

History of corner establishment since Original Government Survey

None recorded since the original government survey.

Description of corner evidence found: Found the remains of an old brace post at the occupied corner. My measurements show this point to match very well all of the existing field evidence found along the North-South Quarter line of Section 33. Accepted this point as the best available evidence of the original government corner. It should be noted that this corner was set erroneously by the original government surveyors and that my final measurements show this to be a fact.

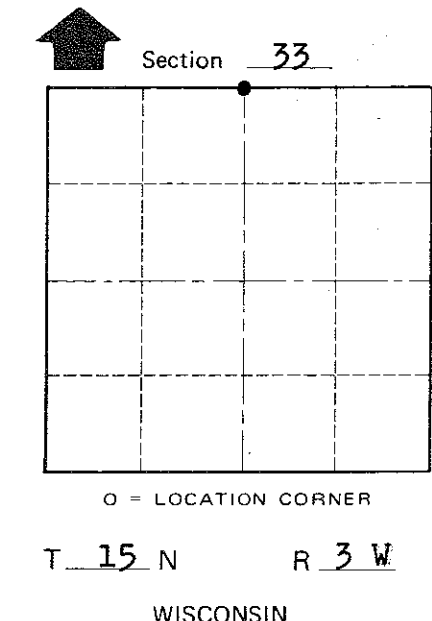
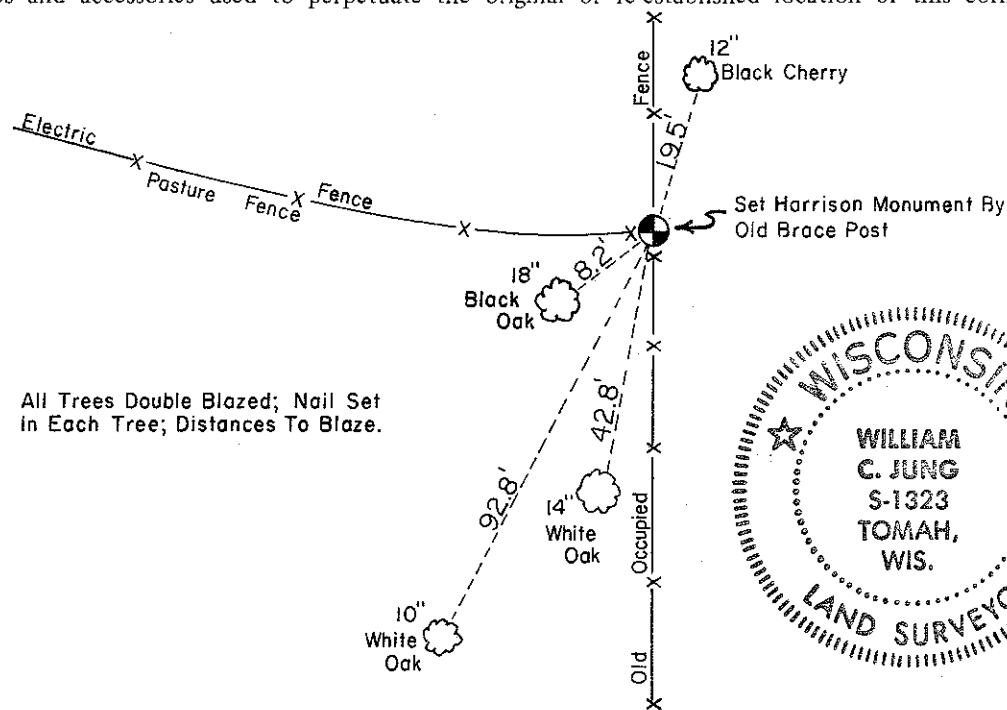

Approved: **HARLEY A. SIME**
MONROE CO. SURVEYOR

SURVEY CONTROL ORDER

Horizontal	_____
Vertical	_____

WISCONSIN COORDINATE SYSTEM

Corner	East (X)	North (Y)	Elevation (Z)	Zone
Control Sta. Name				

~~City, Village or~~ Town Jefferson
County of Monroe
Wisconsin