

21503262000

I, Mark R. Heidecke, do hereby certify that on the 6 day of February 19 79, I found ~~XXXXXX~~ (no evidence) of the West Quarter corner of Section 25, T 15 N, R 3 W, Fourth Principal Meridian, and I re-established said corner according to the Wisconsin Statutes as shown and described hereon.

Dated this 23 day of May 1979.

Mark R. Heidecke

Registered Land Surveyor  
Title

History of corner establishment since Original Government Survey

No history of subsequent monument perpetuation since the Original U. S. Government Survey.



Description of corner evidence found:

This corner was established in line of an old fence to the South and half way between the Northwest and Southwest section corners of Section 25 with a Harrison monument. This location fit the line of an old fence running East and West.

Description of corner and witness monuments, references and accessories used to perpetuate the original or re-established location of this corner:

Witnesses to corner location:

Mark R. Heidecke

Lawrence A. Feddersen

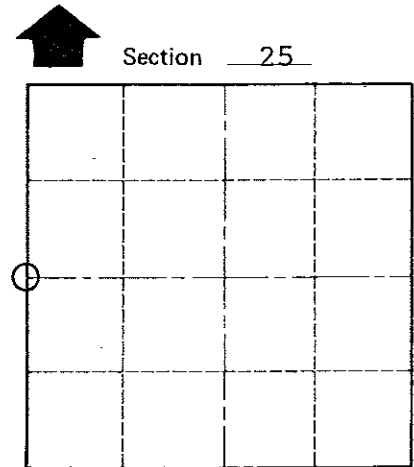
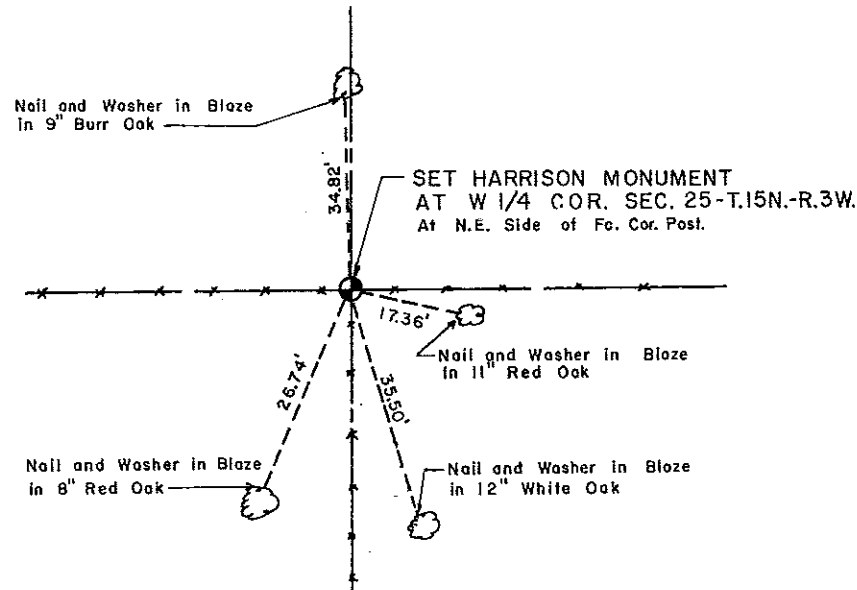

O = LOCATION CORNER

T 15 N R 3 W.

WISCONSIN

SURVEY CONTROL ORDER

Horizontal \_\_\_\_\_  
Vertical \_\_\_\_\_

WISCONSIN COORDINATE SYSTEM

Corner	East (X)	North (Y)	Elevation (Z)	Zone
Control Sta. Name				

~~XXXXXX~~ Town of Jefferson

County of Monroe

COUNTY SURVEYOR FORM NO. 1