

CERTIFICATE

CERTIFIED LAND CORNER

No. 103

21503260000

I, Mark R. Heidecke, do hereby certify that on the 6 day of February 19 79, I found ~~XXXXXX~~ (no evidence) of the Southwest corner of Section 25, T 15 N, R 3 W ~~E~~ Fourth Principal Meridian, and I re-established said corner according to the Wisconsin Statutes as shown and described hereon.

Dated this 23 day of May 19 79.

Mark R. Heidecke

Registered Land Surveyor
Title



Description of corner evidence found:

The corner set in 1899 was not found. A Harrison monument was set at the intersection of old fences to the North, South, and West.

Description of corner and witness monuments, references and accessories used to perpetuate the original or re-established location of this corner:

Witnesses to corner location:

Mark R. Heidecke

Lawrence A. Feddersen

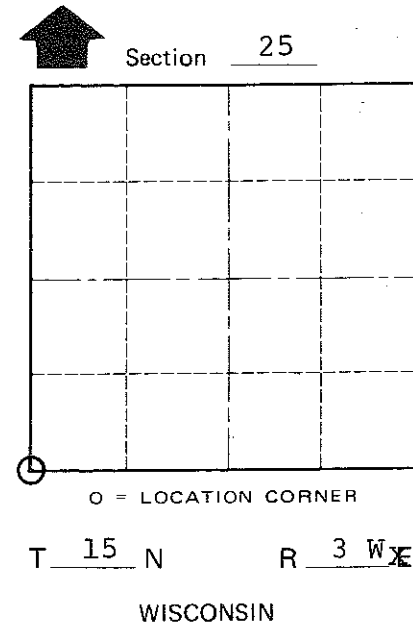
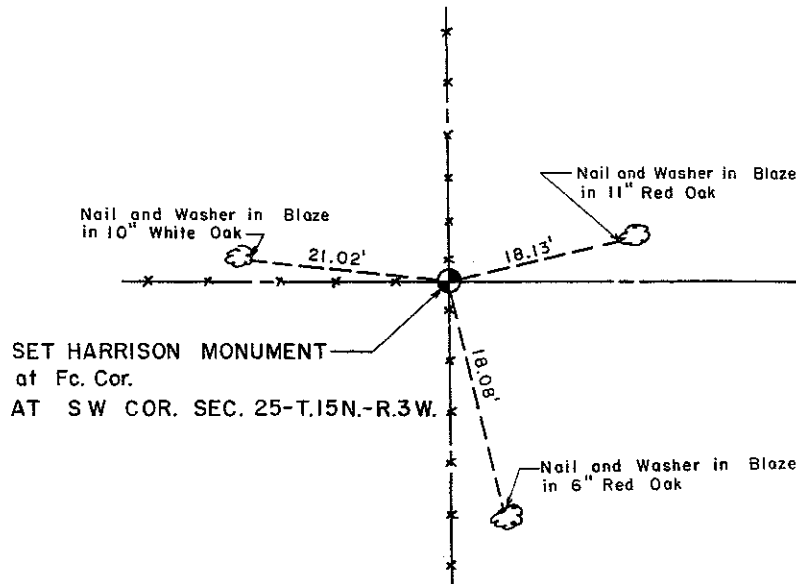

COUNTY SURVEYOR FORM NO. 1

SURVEY CONTROL ORDER

Table with 2 rows: Horizontal, Vertical.

WISCONSIN COORDINATE SYSTEM

Table with 5 columns: Corner, East (X), North (Y), Elevation (Z), Zone.

~~XXXXXX~~ Town of Jefferson
County of Monroe