

21503252000

I, Mark R. Heidecke, do hereby certify that on the 6 day of February 19 79, I found ~~XXXXXX~~ (no evidence) of the East 1/4 corner of Section 25, T 15 N, R 3 W, Fourth Principal Meridian, and I re-established said corner according to the Wisconsin Statutes as shown and described hereon.

Dated this 23 day of May 19 79.

Mark R. Heidecke

Registered Land Surveyor
Title



Description of corner evidence found:

This corner was established with a Harrison Monument in line of an old fence line to the South and an old fence line to the East in the location of an old rotted fence corner post.

Description of corner and witness monuments, references and accessories used to perpetuate the original or re-established location of this corner:

Witnesses to corner location:

Mark R. Heidecke

Lawrence A. Feddersen

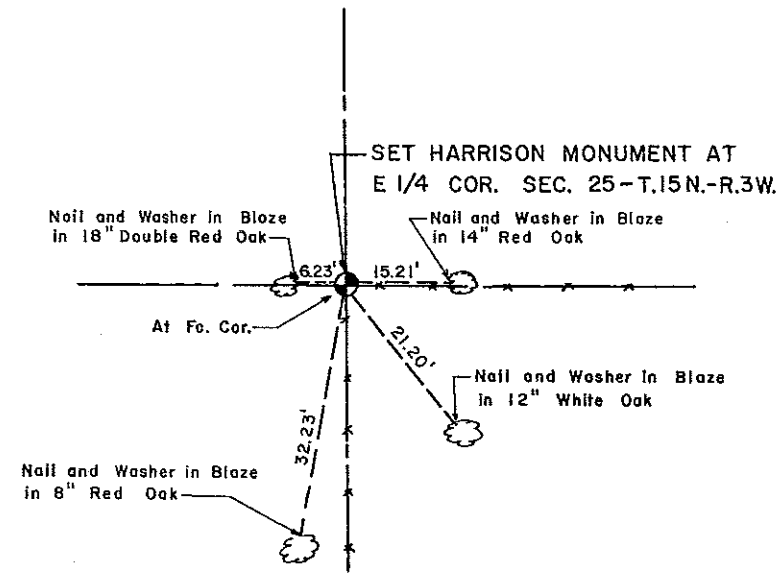

Section 25

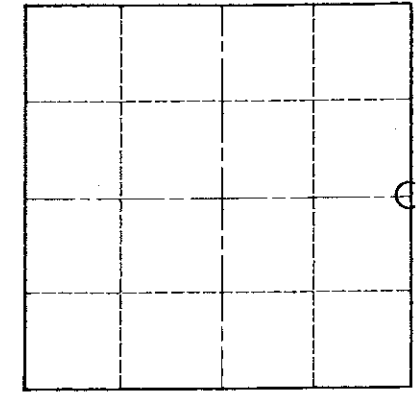

O = LOCATION CORNER

T 15 N R 3 W

WISCONSIN

SURVEY CONTROL ORDER

Horizontal	_____
Vertical	_____

WISCONSIN COORDINATE SYSTEM

Corner	East (X)	North (Y)	Elevation (Z)	Zone
Control Sta. Name				

~~XXXXXX~~ Town of Jefferson

County of Monroe

COUNTY SURVEYOR FORM NO. 1