

CERTIFICATE

CERTIFIED LAND CORNER

No. 82

21503240020

I, Mark R. Heidecke, do hereby certify that on the 6 day of February 19 79, I found ~~XXXXXX~~ (no evidence) of the North Quarter corner of Section 25, T 15 N, R 3 W ~~E~~ Fourth Principal Meridian, and I re-established said corner according to the Wisconsin Statutes as shown and described hereon.

Dated this 23 day of May 19 79.

Mark R. Heidecke

Registered Land Surveyor  
Title



Description of corner evidence found:

This corner was established with a Harrison monument in line of a fence to the East and half way between the Northwest and Northeast section corners of Section 25. This location fits the line of an old fence running North.

Description of corner and witness monuments, references and accessories used to perpetuate the original or re-established location of this corner:

Witnesses to corner location:

Mark R. Heidecke

Lawrence A. Feddersen

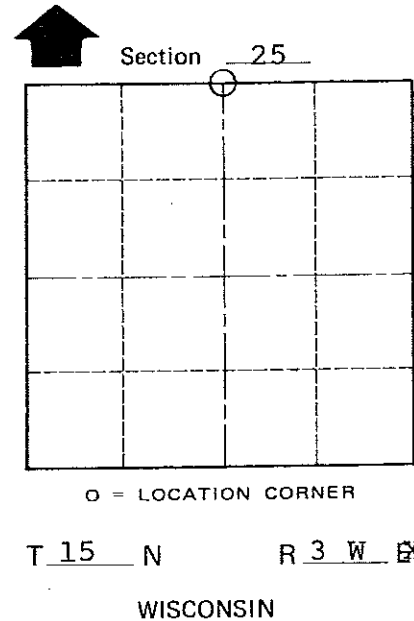
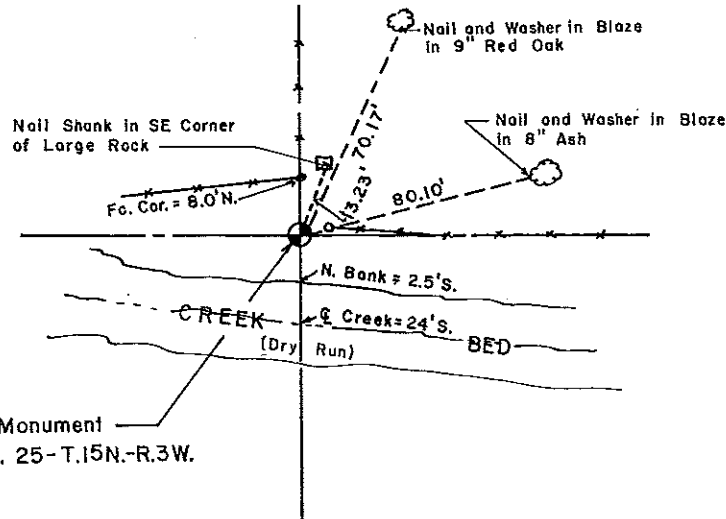

COUNTY SURVEYOR FORM NO. 1

SURVEY CONTROL ORDER

Horizontal \_\_\_\_\_  
Vertical \_\_\_\_\_

WISCONSIN COORDINATE SYSTEM

Corner	East (X)	North (Y)	Elevation (Z)	Zone
Control Sta. Name				

~~XXXXXX~~ Town of Jefferson

County of Monroe