

CERTIFICATE

CERTIFIED LAND CORNER

No. 81

21503240000

I, Mark R. Heidecke, do hereby certify that on the 6 day of February 19 79, I found ~~(evidence)~~ (no evidence) of the Northeast corner of Section 25, T 15 N, R 3 W ~~E~~, Fourth Principal Meridian, and I re-established said corner according to the Wisconsin Statutes as shown and described hereon.

Dated this 23 day of May 1979.

Mark R. Heidecke

Registered Land Surveyor
Title



Description of corner evidence found:

This corner was established with a Harrison monument at the location of the intersection of an old fence line running North and South with a fence to the East. This corner location makes the measurement of the East line of the Northeast Quarter of Sec. 25 to be considerably short (2582.24 feet); however, an old 1" Axle was found at the Northeast Corner of Sec. 24-T.15N.-R.3W. a distance of 5284.86 feet North, which indicates an error in the historical measurement of the East line of the Northeast Quarter of Sec. 25.

Description of corner and witness monuments, references and accessories used to perpetuate the original or re-established location of this corner:

Witnesses to corner location:

Mark R. Heidecke

Lawrence A. Feddersen

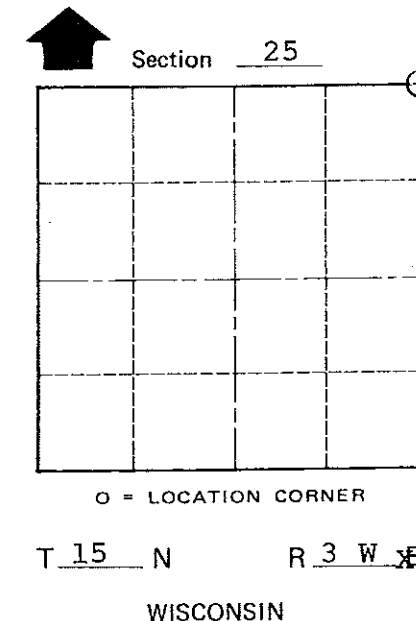
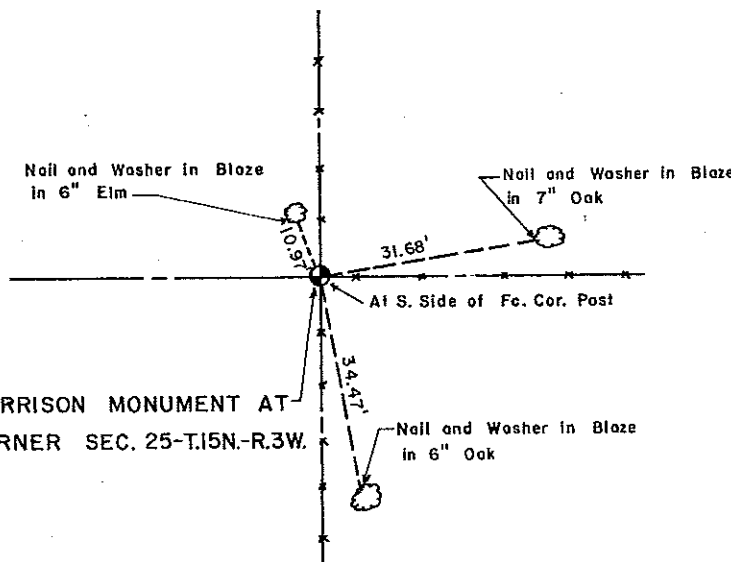

COUNTY SURVEYOR FORM NO. 1

SURVEY CONTROL ORDER

Horizontal _____
Vertical _____

WISCONSIN COORDINATE SYSTEM

Corner	East (X)	North (Y)	Elevation (Z)	Zone
Control Sta. Name				

City, Village or Town of Jefferson
County of Monroe