

CERTIFICATE

I, Harley A. Sime, do hereby certify that on the 20th day of May 1981, I found (evidence) (~~was~~) of the C/4 corner of Section 19, T15 N, R3 W Fourth Principal Meridian, and I re-established said corner according to the Wisconsin Statutes as shown and described hereon.

Dated this 3rd day of July 1981.

Harley A. Sime, R.L.S. 355

County Surveyor
Title

CERTIFIED LAND CORNER

No. 74 B

21503192020

History of corner establishment since Original Government Survey
Fred Holden was here in May of 1907.

Description of corner evidence found:
Set as per law; fits N-S fences very well.

COUNTY SURVEYOR FORM NO. 1

Description of corner and witness monuments, references and accessories used to perpetuate the original or re-established location of this corner:

Witnesses to corner location:

G. Dechant

B. Meyer

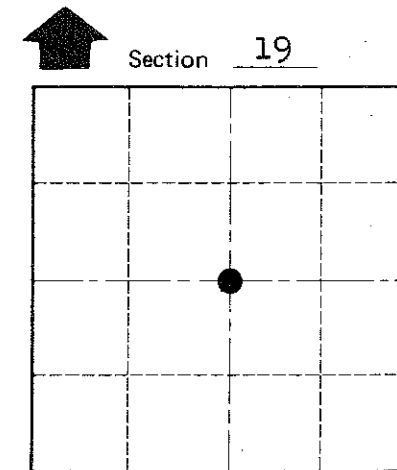
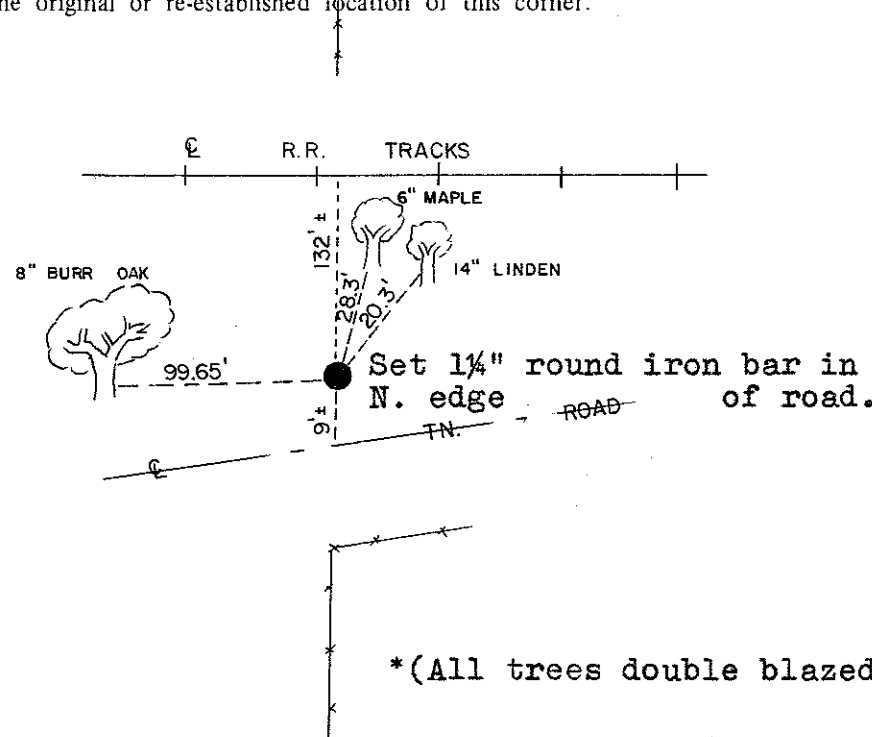

● = LOCATION CORNER

T 15 N R 3 W
WISCONSIN

**Approved: HARLEY A. SIME
MONROE CO. SURVEYOR**

SURVEY CONTROL ORDER

Horizontal	_____
Vertical	_____

WISCONSIN COORDINATE SYSTEM

Corner	East (X)	North (Y)	Elevation (Z)	Zone
Control Sta. Name				

~~City/Village~~ Town Jefferson

County of Monroe

(All trees double blazed with Nails set)