

CERTIFICATE

CERTIFIED LAND CORNER

No. 67

**21503160000**

I, Bryan H. Meyer, do hereby certify that on the 7th day of April 1989, I found (evidence) ~~(evidence)~~ of the Southwest corner of Section 15, T 15 N, R 3 W Fourth Principal Meridian, and I re-established said corner according to the Wisconsin Statutes as shown and described hereon.

Dated this 6th day of July 1989.

*Bryan H. Meyer*

Registered Land Surveyor

History of corner establishment since Original Government Survey  
Webster Kenyon was here in November of 1891.

Description of corner evidence found:

I accepted brace posts to the East and West in an East-West fence as the best available evidence.

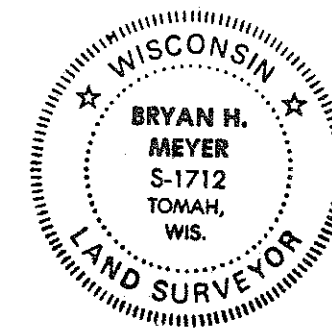

COUNTY SURVEYOR FORM NO. 1

Description of corner and witness monuments, references and accessories used to perpetuate the original or re-established location of this corner:

Crew: Meyer, Forsythe  
Date: April 7, 1989  
Weather: P. Cloudy, 50°±  
Witnesses to corner location:

Bryan H. Meyer

Brian Forsythe

**H. A. SIME & ASSOC.**

**Surveying & Land Planning**

1819 Stoughton Ave. - P.O. Box 705  
TOMAH, WI 54660  
608-372-5392

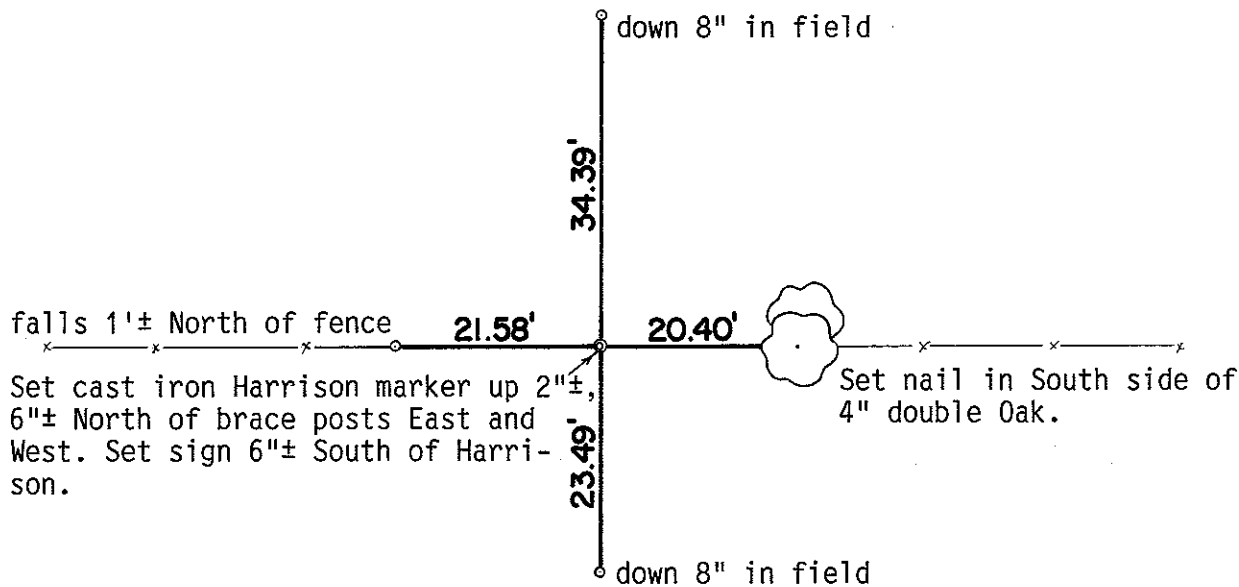

Set cast iron Harrison marker up 2"±, 6"± North of brace posts East and West. Set sign 6"± South of Harrison.

Set nail in South side of 4" double Oak.

o = Set 3/4"x24" round iron bar

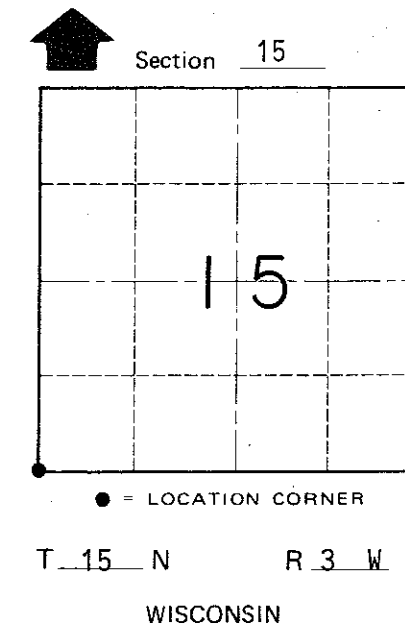

SURVEY CONTROL ORDER

Horizontal	_____
Vertical	_____

WISCONSIN COORDINATE SYSTEM

Corner	East (X)	North (Y)	Elevation (Z)	Zone
Control Sta. Name				

~~City, Village or~~ Town of Jefferson

County of Monroe