

CERTIFICATE

CERTIFIED LAND CORNER

No. 59

21503142000

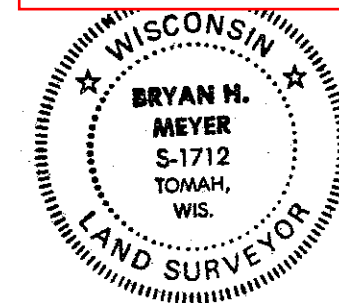

H. A. Sime and Associates  
 Surveying and Land Planning  
 P. O. Box 705, Tomah, WI  
 Phone: (608)-372-5392

I, Bryan H. Meyer, do hereby certify that on the 30th day of March 19 89, I found (evidence) ~~(evidence)~~ of the East 1/4 corner of Section 14, T 15 N, R 3 W Fourth Principal Meridian, and I re-established said corner according to the Wisconsin Statutes as shown and described hereon.

Dated this 11th day of July 19 89.

Bryan H. Meyer  
 Registered Land Surveyor  
Title

History of corner establishment since Original Government Survey

Nothing recorded.

Description of corner evidence found:

I accepted a three-way fence corner as the best available evidence.

COUNTY SURVEYOR FORM NO. 1

Description of corner and witness monuments, references and accessories used to perpetuate the original or re-established location of this corner:

Crew: Meyer, Forsythe  
 Date: March 30, 1989 - 1:45 P. M.  
 Weather: Overcast, Windy, 40°±  
 Witnesses to corner location:

Bryan H. Meyer

Brian Forsythe

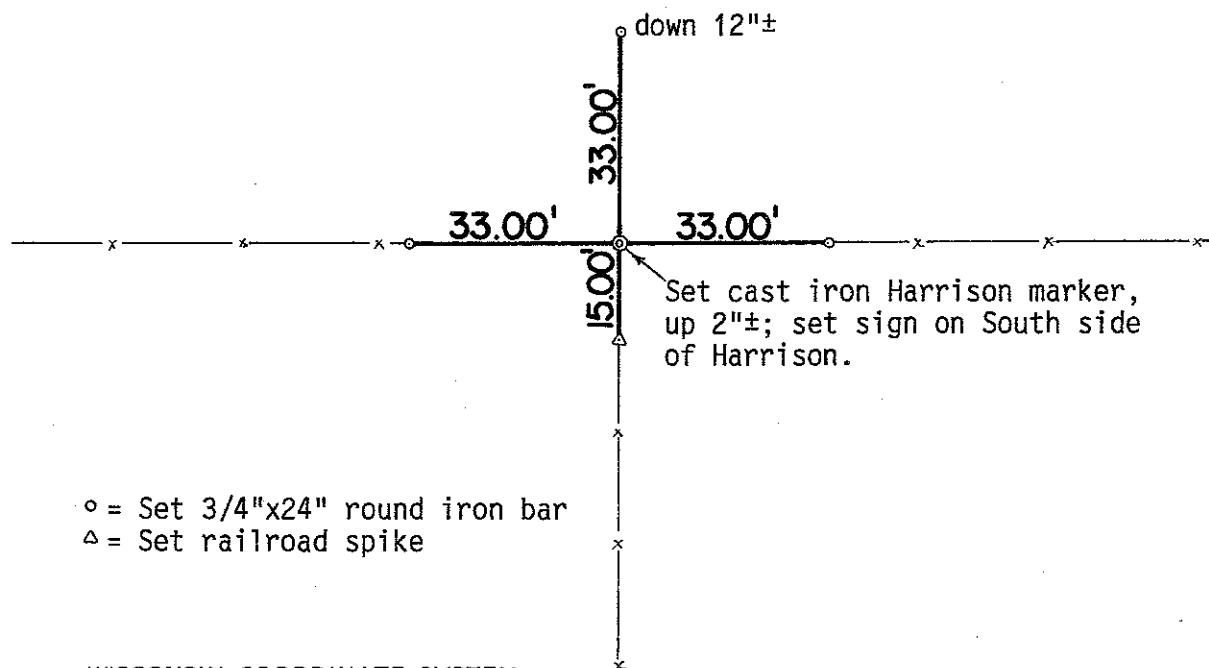

○ = Set 3/4"x24" round iron bar  
 △ = Set railroad spike

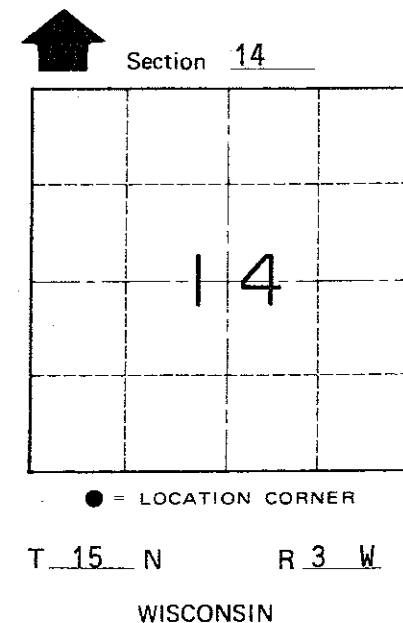

SURVEY CONTROL ORDER

Horizontal	_____
Vertical	_____

WISCONSIN COORDINATE SYSTEM

Corner	East (X)	North (Y)	Elevation (Z)	Zone
Control Sta. Name				

~~Village~~ Town of Jefferson  
 County of Monroe