

21503100000

I, Lawrence A. Feddersen, do hereby certify that on the 28th day of April 1978, I found (evidence) ~~(no evidence)~~ of the Southeast corner of Section 10, T 15 N, R 3 W, Fourth Principal Meridian, and I re-established said corner according to the Wisconsin Statutes as shown and described hereon.

Dated this 22 day of May 1978.

Lawrence A. Feddersen

REGISTERED LAND SURVEYOR, S-1226
Title

History of original corner establishment:

This corner was re-established by Kenyon in 1891, visited by Schroeder some time afterwards; and visited by Holden in 1908. In Sept., 1972, D.A. Marten set a 1 1/4" x 30" round iron bar at the intersection of at least three old fences at this corner location (Vol. 2, C.S.M., P. 95).

Description of corner evidence found:

The existing 1 1/4" x 30" round iron bar at this corner was accepted and replaced with a Harrison.

COUNTY SURVEYOR FORM NO. 1

Description of corner and witness monuments, references and accessories used to perpetuate the original or re-established location of this corner:

Witnesses to corner location:

Lawrence A. Feddersen

Douglas J. Malliet

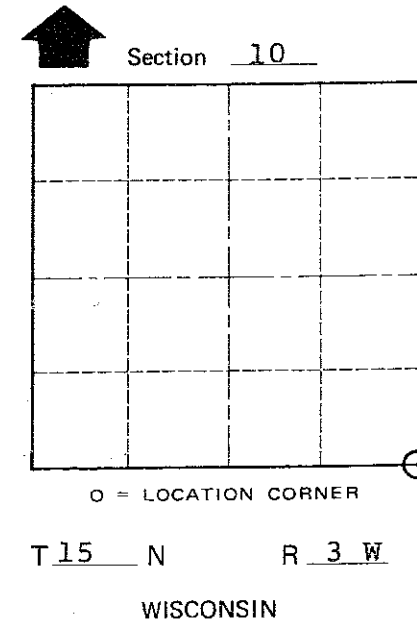
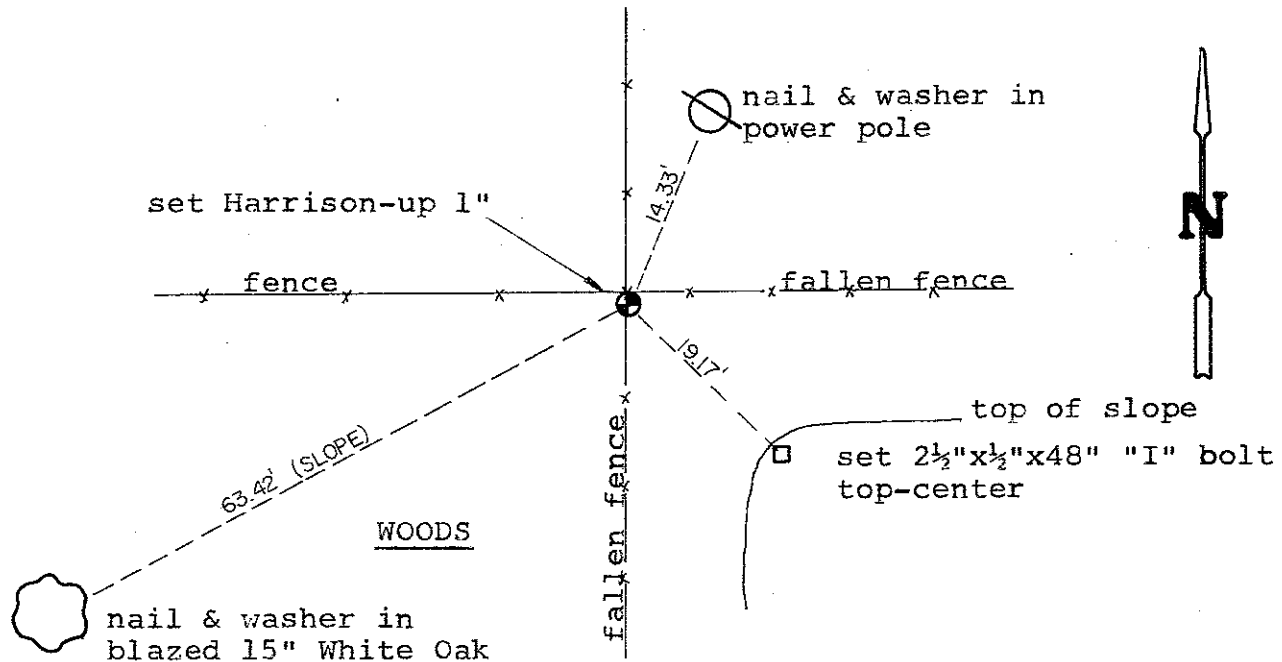

SURVEY CONTROL ORDER

Horizontal	_____
Vertical	_____

WISCONSIN COORDINATE SYSTEM

Corner	East (X)	North (Y)	Elevation (Z)	Zone
Control Sta. Name				

City, Village or Town of JEFFERSON

County of MONROE