

CERTIFICATE

CERTIFIED LAND CORNER

No. 48

21503090020

I, Gary L. Dechant, do hereby certify that on the 11th day of October 2000, I found (evidence) (~~no evidence~~) of the S¹/₄ corner of Section 9, T 15 N, R 3 W Fourth Principal Meridian, and I re-established said corner according to the Wisconsin Statutes as shown and described hereon.

Dated this 21 day of Oct. 2000.

Gary L. Dechant

R.L.S. 1744

Title

History of corner establishment since Original Government Survey

No known recorded history since the original government survey.

Description of corner evidence found:

Accepted intersection of centerline of Town Road and fence to the south as S¹/₄ corner. Fits conditions between section corners extremely well.

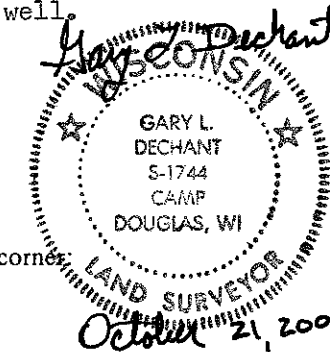

Description of corner and witness monuments, references and accessories used to perpetuate the original or re-established location of this corner.

Witnesses to corner location:

Zachariah P. Dechant

Gary L. Dechant

o = Set 1" O.D. x 24" iron pipe

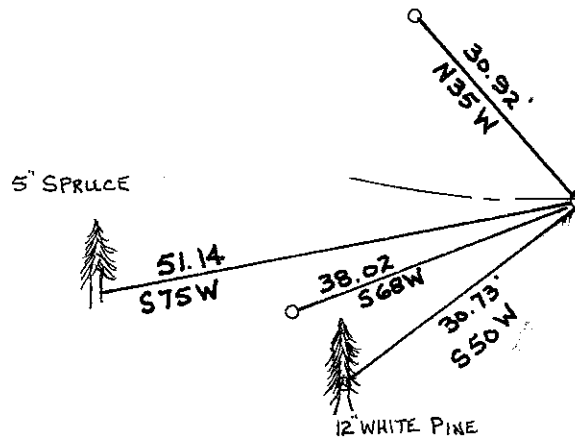

Set Cast Iron County Monument
Set survey sign 19'+ north, next to power pole

Trees are not blazed.
Set 40d nail on side of tree.

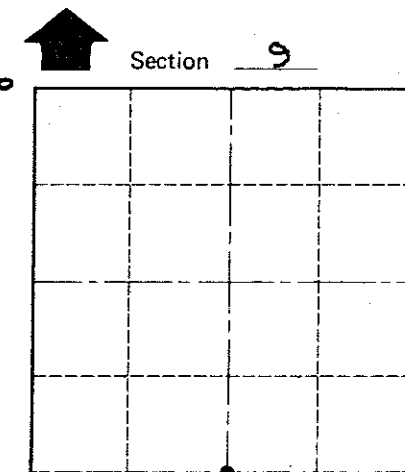

● = LOCATION CORNER

T 15 N R 3 W

WISCONSIN

SURVEY CONTROL ORDER

Horizontal _____

Vertical _____

WISCONSIN COORDINATE SYSTEM

Corner	East (X)	North (Y)	Elevation (Z)	Zone
Control Sta. Name				

City, Village or Town JEFFERSON

County of MONROE

COUNTY SURVEYOR FORM NO. 1