

21503072000

I, Garold A. Sime, do hereby certify that on the 27th day of July 1984, I found (evidence) ~~no evidence~~ of the E 1/4 corner of Section 7, T15 N, R 3 W Fourth Principal Meridian, and I re-established said corner according to the Wisconsin Statutes as shown and described hereon.

Dated this 28th day of Sept. 1984.

Garold A. Sime

Garold A. Sime, R.L.S. 1261  
Title

History of corner establishment since Original Government Survey

Fred Holden was at this corner in April & Oct. of 1910 and set a stone monument

Description of corner evidence found:

I found Holdens stone and accepted it as the corner. I set a Harrison Monument 1.00 feet east of stone for reference only. The Stone is the corner.

COUNTY SURVEYOR FORM NO. 1

Description of corner and witness monuments, references and accessories used to perpetuate the original or re-established location of this corner:

Stone Monument at corner (8"x 3") stone with cross

Witnesses to corner location:

G.A. Sime

Dallas Wilhite

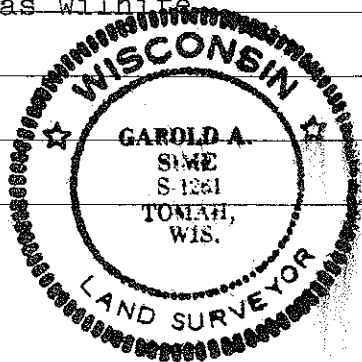

SURVEY CONTROL ORDER

Horizontal \_\_\_\_\_  
Vertical \_\_\_\_\_

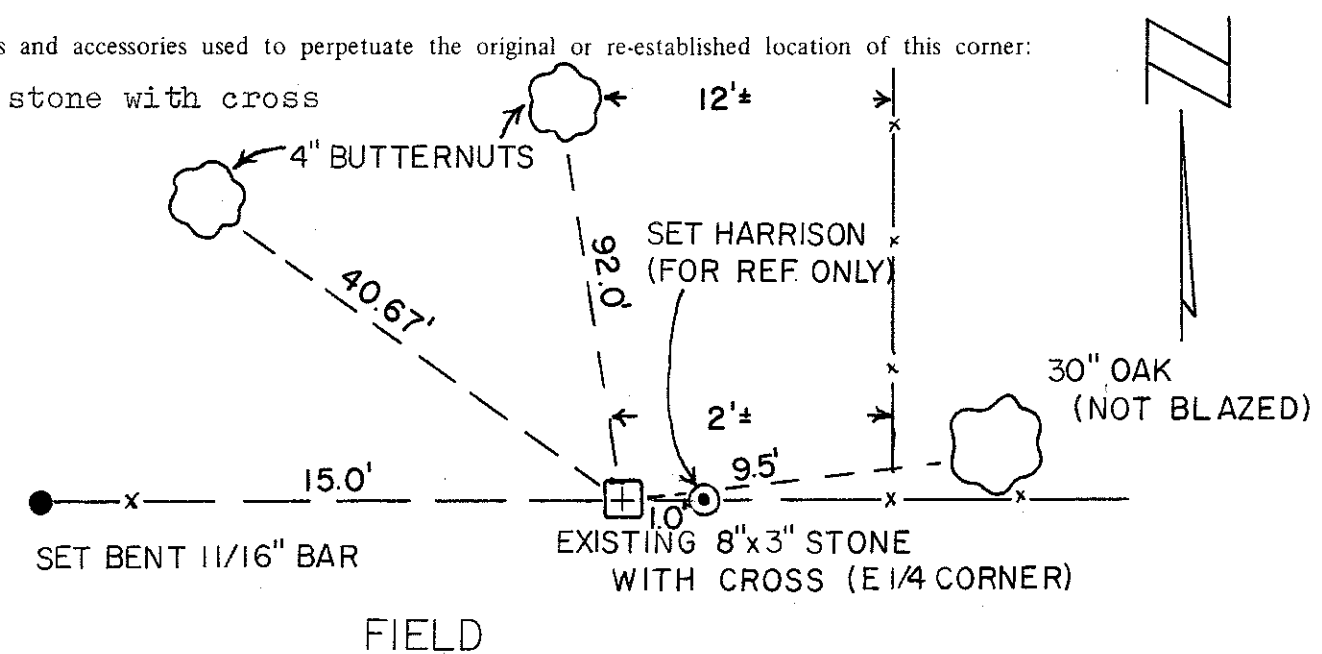

ALL DISTANCES TAKEN TO NAIL IN HACK ON SIDES OF TREES.

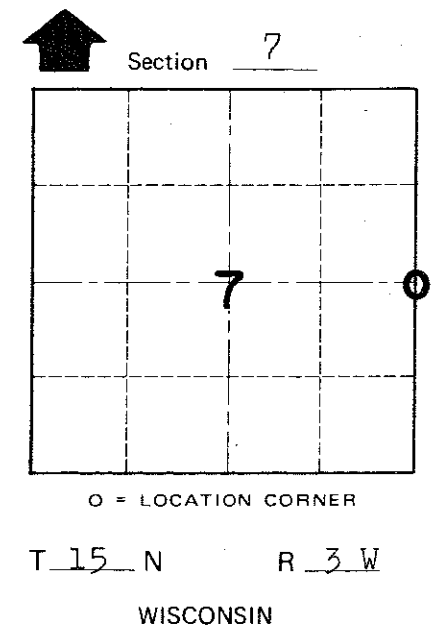

WISCONSIN COORDINATE SYSTEM

Corner	East (X)	North (Y)	Elevation (Z)	Zone
Control Sta. Name				

City, Village or Town Jefferson

County of Monroe