

# 27

**U.S. PUBLIC LAND CORNER  
MAINTENANCE**

**Corner ID : SE Sec.4, T15N-R3W**

**21503040000**

<u>DATE</u>	<u>CREW</u>	<u>MONUMENT TYPE -----</u>
June 8, 2016	Zachariah P.Dechant Gary L. Dechant	Harrison destroyed in pieces. Reset from BT's NW, S, & SE with a 1-1/8"x6' round iron bar, falls at fence corner. Set sign 1' west

References:

	<u>Bearing</u>	<u>Distance</u>
1) Set 3/4"x24" round iron bar, down 6", 4' SW of 4" Maple	NE	17.77'
2) Set 3/4"x24" round iron bar, down 6", 6' South of 16" White Oak (BT)	S35E	14.56'
3) Set 3/4"x24" round iron bar, down 6", 6' east of 14" White Oak with wire	S86W	34.70'
4) Set 3/4"x24" round iron bar, down 6", 4' SE of 16" White Oak (BT)	N34W	12.00'



I, Lawrence A. Feddersen, do hereby certify that on the 28th day of April 1978, I found (evidence) (~~XXXXXXXX~~) of the Northwest corner of Section 10, T15 N, R 3 W, Fourth Principal Meridian, and I re-established said corner according to the Wisconsin Statutes as shown and described hereon.

Dated this 22 day of May 1978.

Lawrence A. Feddersen

REGISTERED LAND SURVEYOR, S-1226  
Title

History of original corner establishment:

No subsequent history of monument perpetuation since the original U.S. Government Survey.

Description of corner evidence found:

This corner was established at the intersection of three old fences, as it was considered the best available evidence. Measurements 1 mile North, South, East and West agree well with the record Government notes.

**See Reverse Side For Maintenance**

Description of corner and witness monuments, references and accessories used to perpetuate the original or re-established location of this corner:

Witnesses to corner location:

Lawrence A. Feddersen

Douglas J. Malliet

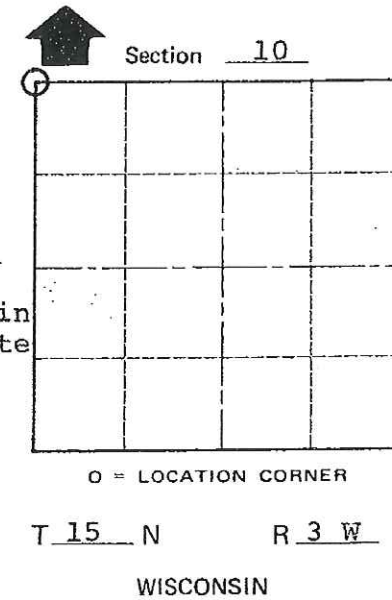
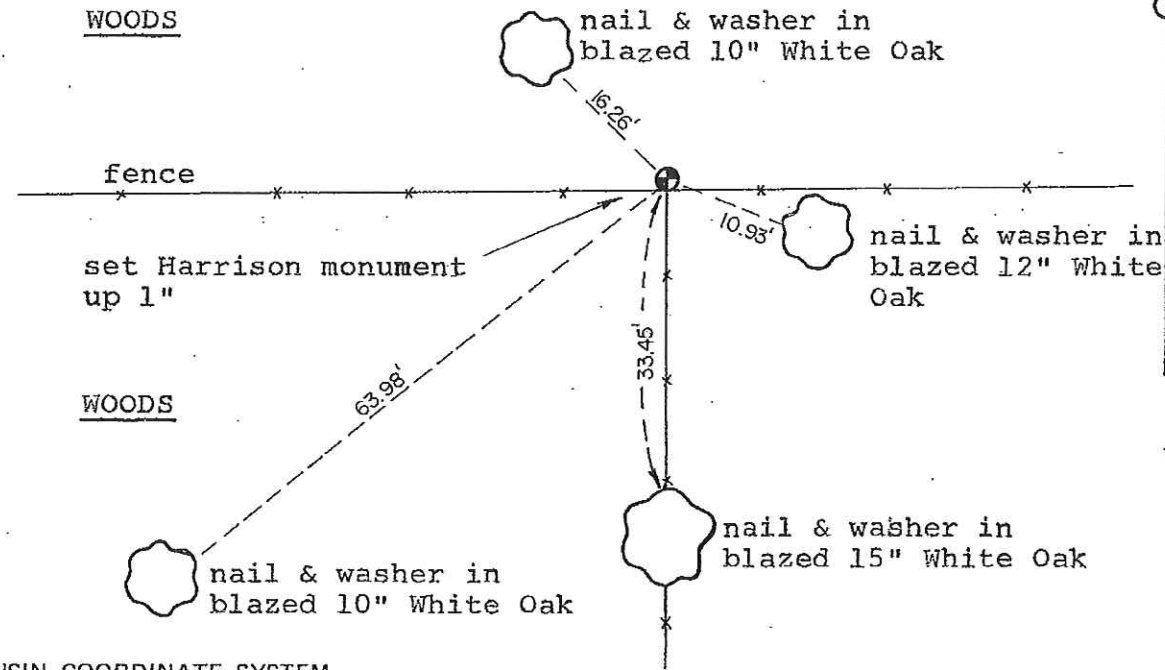

SURVEY CONTROL ORDER

Horizontal	_____
Vertical	_____

WISCONSIN COORDINATE SYSTEM

Corner	East (X)	North (Y)	Elevation (Z)	Zone
Control Sta. Name				

City, Village or Town of JEFFERSON

County of MONROE

COUNTY SURVEYOR FORM NO. 1