

CERTIFICATE

CERTIFIED LAND CORNER

No. 20

21503012000

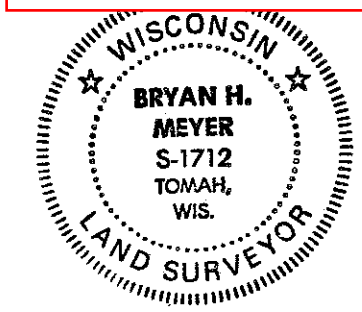

I, Bryan H. Meyer, do hereby certify that on the 7th day of November 19 90, I found (evidence) ~~occupied~~ of the East 1/4 corner of Section 1, T 15 N, R 3 W Fourth Principal Meridian, and I re-established said corner according to the Wisconsin Statutes as shown and described hereon.

History of corner establishment since Original Government Survey

Webster Kenyon was here in June of 1894.

Dated this 21st day of Dec. 19 90.

Bryan H. Meyer
Deputy County Surveyor
Title

Description of corner evidence found:

I accepted the occupied fence corner as the best available evidence.

Description of corner and witness monuments, references and accessories used to perpetuate the original or re-established location of this corner:

Crew: Meyer, Kenworthy
Date: November 7, 1990
Weather: P. Cloudy 30°±
Witnesses to corner location:

John Kenworthy
Bryan H. Meyer

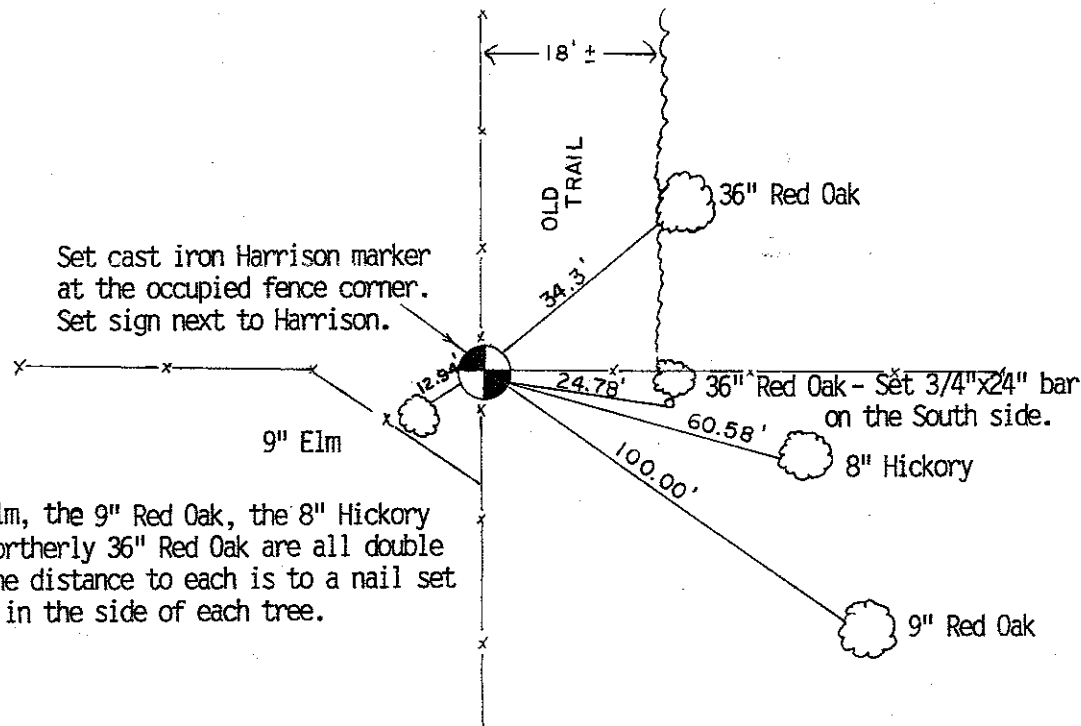

The 9" Elm, the 9" Red Oak, the 8" Hickory and the Northerly 36" Red Oak are all double blazed; the distance to each is to a nail set in a hack in the side of each tree.

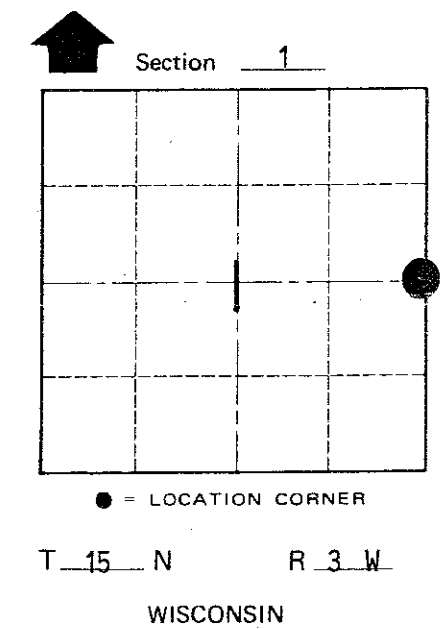
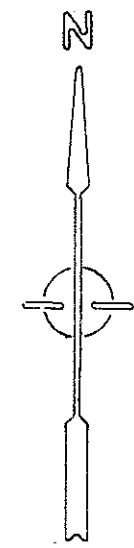

H. A. Sime and Associates
P. O. Box 705
Tomah, Wisconsin 54660
Phone: (608)-372-5392

COUNTY SURVEYOR FORM NO. 1

SURVEY CONTROL ORDER

Horizontal	_____
Vertical	_____

WISCONSIN COORDINATE SYSTEM

Corner	East (X)	North (Y)	Elevation (Z)	Zone
Control Sta. Name				

~~City, Village or~~ Town of Jefferson
County of Monroe