

# VERNON COUNTY CERTIFIED U.S. PUBLIC LAND SURVEY MONUMENT RECORD

INSTRUCTIONS: THIS RECORD SHALL SHOW THE LOCATION OF THE CORNER AND SHALL INCLUDE ALL OF THE FOLLOWING ELEMENTS (A-I)

(A) IDENTIFY THE CORNER BY REFERENCE TO THE U.S. PUBLIC LAND SURVEY SYSTEM

■ = CORNER MONUMENT RESTORED

WITNESSES TO CORNER LOCATION:

- 1) Robert M. Lampman
- 2) Jessica A. Zamor

VERNON COUNTY COORDINATES - NAD83(1991) - SURVEY FEET

NORTHING: 210961.717

EASTING: 793663.798

MONROE COUNTY COORDINATES - NAD83(1991) - SURVEY FEET

NORTHING: 300006.742

EASTING: 697212.572

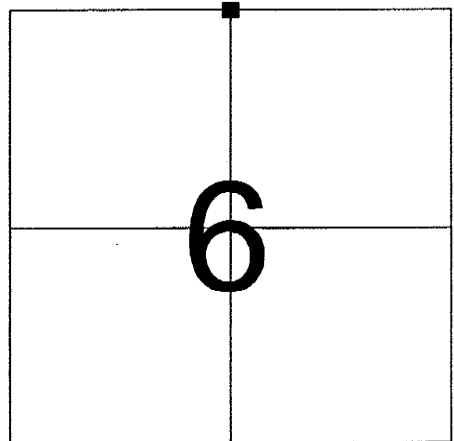

SECTION 6  
TOWN 14 NORTH, RANGE 1 WEST

(B) DESCRIBE ANY RECORD EVIDENCE, MONUMENT EVIDENCE, OCCUPATIONAL EVIDENCE, TESTIMONIAL EVIDENCE OR ANY OTHER MATERIAL EVIDENCE YOU CONSIDERED, AND WHETHER THE MONUMENT WAS FOUND OR PLACED.

Accepted existing True Cast Products Monument as the best available evidence of the original corner location.

Monument was placed by Gary Dechant in 1998. (See corner history on reverse for additional information.)

The accepted corner location falls only 0.56' north of a straight line between the Northwest and Northeast corners of Section 6. Distance westerly from this corner to the Northwest corner of Section 6 matches original government record within 2 feet. Distance easterly to the Northeast corner of Section 6 runs short at 2628.70 feet. However, the corner location is supported by north/south occupation in the area of the NW corner of the NE 1/4 of the NE 1/4 of Section 6. Said north/south occupation falls at equal distance from this corner and the Northeast corner of Section 6.

(C) IN THE PLAN VIEW DRAWING BELOW, PROVIDE REFERENCE TIES TO AT LEAST 4 WITNESS MONUMENTS OR, IF THE LOCATION IS WITHIN A MUNICIPALITY, TO AT LEAST 2 WITNESS MONUMENTS. (WITNESS MONUMENTS SHALL BE MADE OF CONCRETE, NATURAL STONE, IRON, OR OTHER EQUALLY DURABLE MATERIAL.) DESCRIBE WITNESS MONUMENTS.

(D) SHOW A PLAN VIEW DRAWING, DEPICTING THE RELEVANT MONUMENTS AND REFERENCE TIES, WHICH IS SUFFICIENTLY DETAILED TO ENABLE ACCURATE RELOCATION OF THE CORNER MONUMENT IF IT IS DISTURBED.

NOT TO SCALE

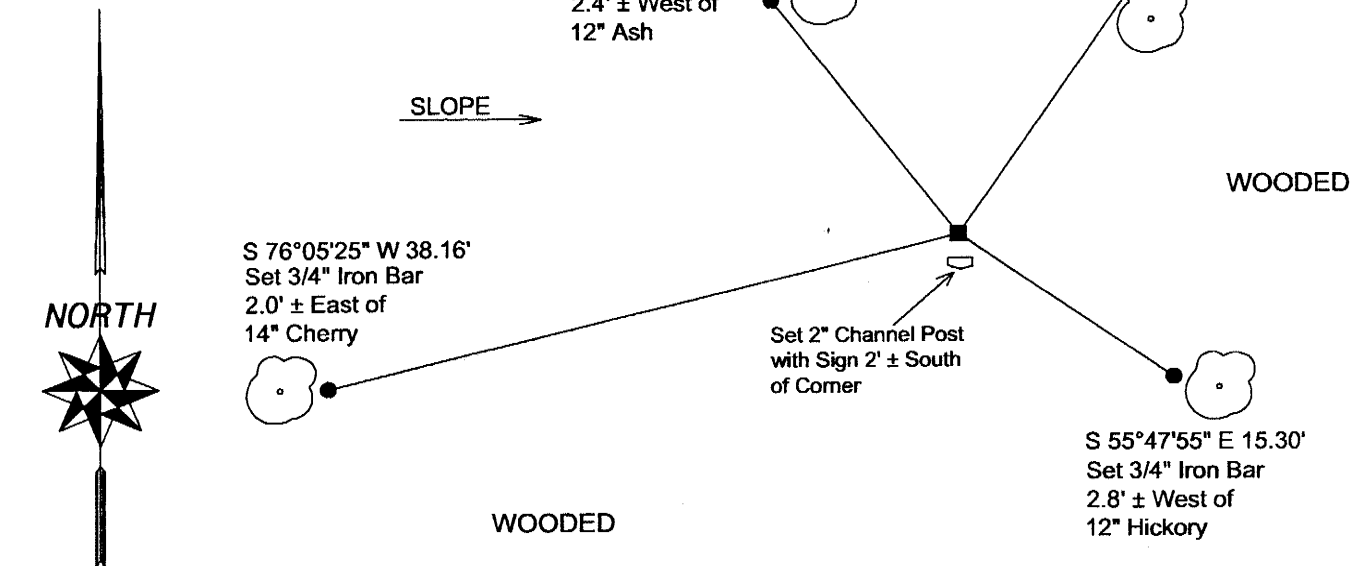

### LEGEND

- EXISTING CAST IRON TRUE CAST PRODUCTS MON.
- SET 3/4" X 24" ROUND IRON BAR FOR WITNESS MONUMENT

(E) DESCRIBE ANY MATERIAL DISCREPANCY BETWEEN THE LOCATION OF THE CORNER AS RESTORED OR REESTABLISHED AND THE LOCATION OF THAT CORNER AS PREVIOUSLY RESTORED OR REESTABLISHED BY DISTANCE AND DIRECTION. SHOW THE DISCREPANCY ON THE PLAN VIEW DRAWING UNDER (D), ABOVE. SHOW THE DISTANCES BETWEEN THE CORNER AS PREVIOUSLY RESTORED OR REESTABLISHED AND (1) THE CORNER AS RESTORED OR REESTABLISHED, AND (2) TO AT LEAST 2 OF THE WITNESS MONUMENTS AS SHOWN ON THE DRAWING IN (D), ABOVE.

N/A

(F) WAS THE CORNER RESTORED THROUGH ACCEPTANCE OF (1) AN OBLITERATED EVIDENCE LOCATION, OR (2) A FOUND PERPETUATED LOCATION?

\ (2) A FOUND PERPETUATED LOCATION

(G & H) WAS THE CORNER REESTABLISHED THROUGH LOST CORNER PROPORTIONATE METHODS? IF SO SHOW THE METHOD, INCLUDING THE DIRECTIONS AND DISTANCES TO OTHER PUBLIC LAND SURVEY CORNERS USED AS EVIDENCE OR USED FOR PROPORTIONING IN DETERMINING THE CORNER LOCATION.

N/A

(\*\*) ANY ADDITIONAL INFORMATION RELATED TO CORNER LOCATION

CORNER HISTORY:

-Original government corner location established by Uriah Biggs in 1845.

-C.M. Sterling prepared a subdivision of Sections 5, 6, 7, 8, and 9 dated April of 1892. On said survey Sterling shows two new sugar maple witnesses for the corner and calls for a sand stone at the corner. It appears that Sterling may have reestablished the corner by measurement as part of this survey.

-Hamilton LaRue utilized this corner as part of a subdivision of Section 31, T15N, R1W dated June of 1897. Hamilton LaRue also lists two sugar maple witnesses for the corner.

(Note that the sugar maples listed by LaRue are exactly 2" in diameter larger than those listed by Sterling. The bearings and distances LaRue lists with the witnesses are different than those listed by Sterling. However, the witness trees seem to have approximately the same relationship to each other in both cases. If both surveyors utilized the same trees, then Sterling's section corner location was most likely approximately 10 feet southwesterly of LaRue's section corner location.)

-Gary L. Dechant set a True Cast Products monument at the corner and prepared a tie sheet dated December 1, 1998. Gary Dechant established the corner location by retracement of information from a survey by James Carroll. (Record distance of 102.13 feet from a nail at a fence corner to the west and on line from said nail towards the Southeast corner of Section 6.) Dechant also notes that this location fits well with other section corners and interior corners.

AFFIX LAND SURVEYOR SEAL

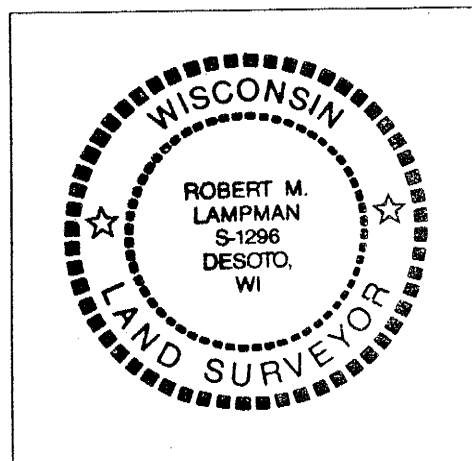

(I) I, ROBERT M. LAMPMAN, CERTIFY THAT THE LOCATION SHOWN ON THIS RECORD WAS DETERMINED BY ME OR UNDER MY DIRECTION AND CONTROL AND THAT THIS U.S. PUBLIC LAND SURVEY MONUMENT RECORD IS CORRECT AND COMPLETE TO THE BEST OF MY KNOWLEDGE AND BELIEF.

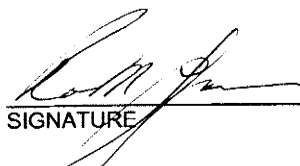
  
SIGNATURE

3-10-04  
DATE

CERTIFICATE

CERTIFIED LAND CORNER

21501310020

No. 132

I, Gary L. Dechant, do hereby certify that on the 16th day of November 19 98, I found (evidence) (no evidence) of the S/4 corner of Section 31, T 15 N, R 1 W Fourth Principal Meridian, and I re-established said corner according to the Wisconsin Statutes as shown and described hereon.

Dated this 1st day of Dec. 19 98.

Gary L. Dechant

R.L.S. 1744

Title

History of corner establishment since Original Government Survey

Hamilton LaRue was here in 1897. James Carroll shows a computed corner at this corner. Vernon County Records in Book 1 P.401 shows a stone set at corner by Sterling in 1892.

Description of corner evidence found:

Set corner at Carroll's computed corner. Fits other section corners and interior corners extremely well. Set 102.13 feet from Carroll's nail at fence corner to the west, in line with said nail and SE corner of the section.

We looked at numerous stones in this area, but could not identify one as being the corner set by Sterling in 1892. We found what possibly could have been one of his bearing trees, but concluded it was probably too small and set it at Carroll's location.

Description of corner and witness monuments, references and accessories used to perpetuate the original or re-established location of this corner

Witnesses to corner location:

David E. Madison

Gary L. Dechant

COUNTY SURVEYOR FORM NO. 1

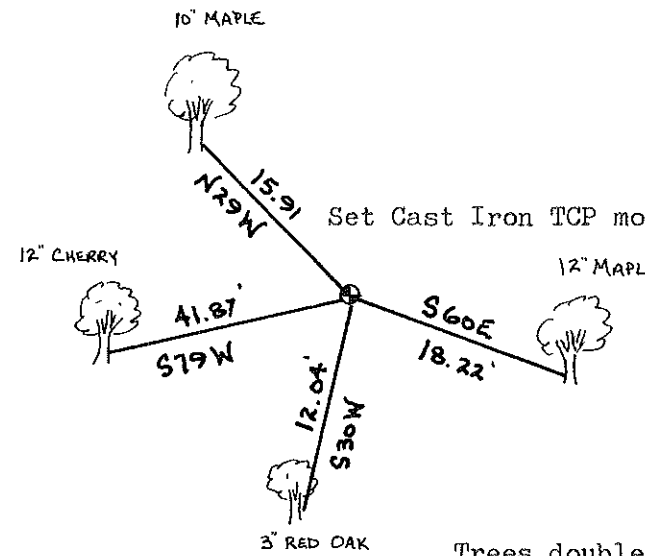
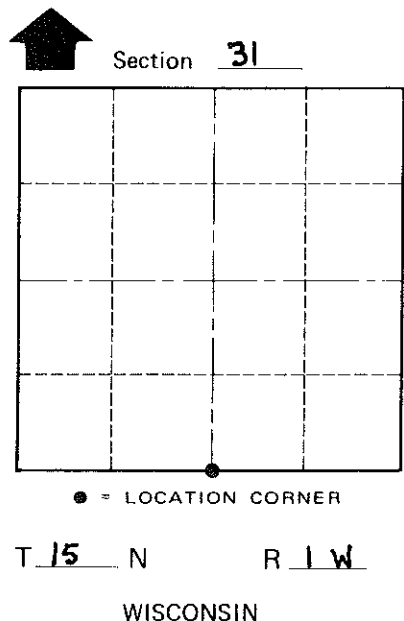
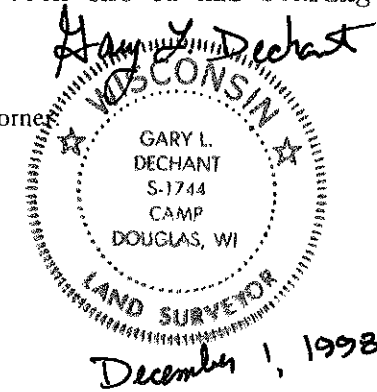

Set Cast Iron TCP monument.

Trees double blazed with 40d nail set.

SURVEY CONTROL ORDER

Horizontal \_\_\_\_\_  
Vertical \_\_\_\_\_

WISCONSIN COORDINATE SYSTEM

Corner	East (X)	North (Y)	Elevation (Z)	Zone
Control Sta. Name				

City, Village or Town WELLINGTON  
County of MONROE